

EDCON-COMPONENTS



Specifications

Material

Insulator: PBT, rated UL94V-0 (standard)
 Contacts: Brass (standard)
 Shell: Steel
 Contact Plating: 50µ Nickel
 Contact Area: 1µ~30µ Selective AU like O-Code
 Solder Tail Area: 100µ Tin / Lead Free

Electrical:

Operation Voltage: 250VAC max.
 Current Rating: 3A max.
 Contact Resistance: 15 m Ohm max.
 Insulation Resistance: 2000Mohm min @ 500VDC
 Dielectric with. Voltage: 1000VAC / minute
 Operating Temperature: -55°C to +105°C

Drawing (dimensions all into mm)

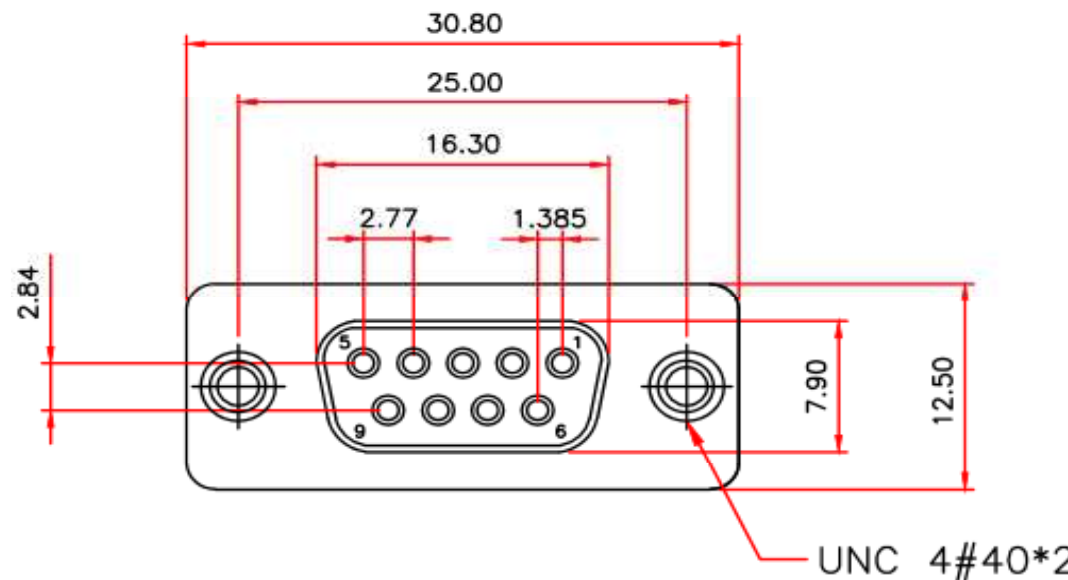

PCB Layout TOP VIEW Tol. +/-0,10mm

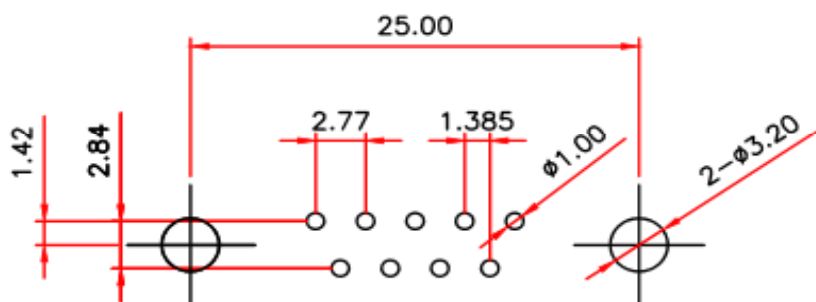

Tolerance Table (mm)				
Angle	0.	.0	.00	
±5°	±0,5	±0,3	±0,2	
DRW:	Jason	CHKD	Wilson	MATL:
APPD:	Schumi			FINISH
				Wilson
				Jamy
				TOLERANCE
				Mason
				DATE
				21.09.2022
				Sheet No.
				1 from 4

D-SUB-Connector / Stamped Contact / High Body

Part No.: **T24E2048-**

Customer:

EDCON-COMPONENTS

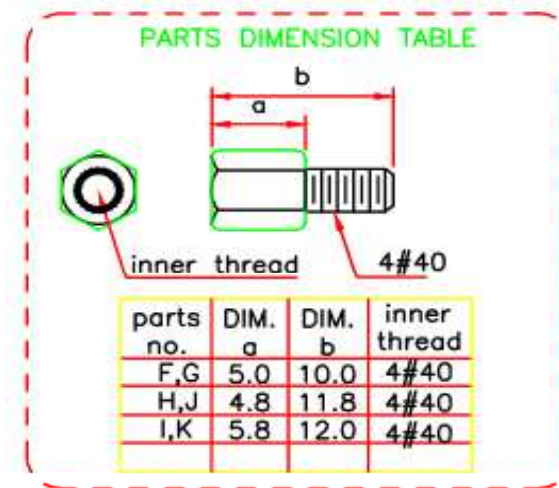
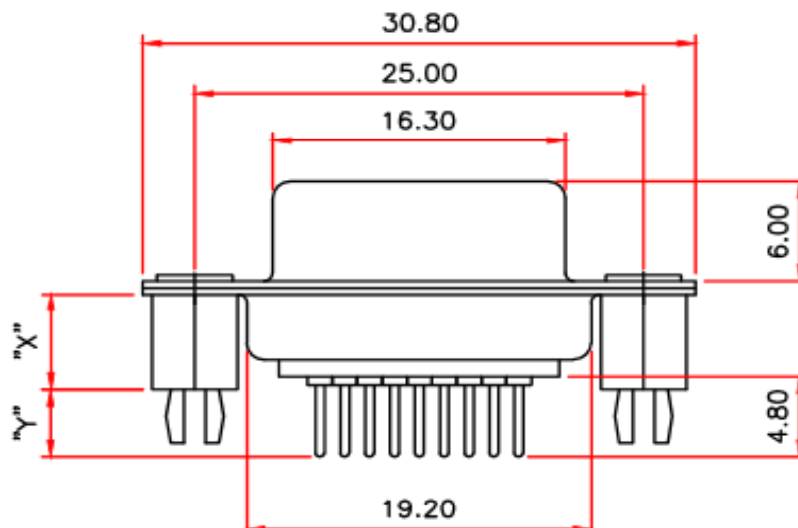
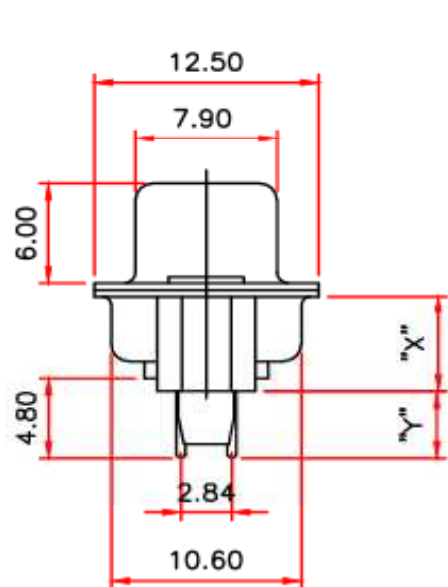

D-SUB-Connector / Stamped Contact / High Body

Part No.: **T24E2048-**

Customer:

DRW:	Jason	CHKD	Wilson	MATL:	Wilson	TOLERANCE	Mason	DATE	21.09.2022
APPD:	Schumi			FINISH	Jamy		Sheet No.	2 from 4	

EDCON-COMPONENTS



Ordering Informations

Serie	No of Pos.	Contact Type	Contact Area Plating	Shell Plating	Body Colour	Process Option X + Y	Parts Option	ROHS	Packing
-------	------------	--------------	----------------------	---------------	-------------	----------------------	--------------	------	---------

T24E2048-	09	F	SF	T	BK	H	E	R	TY
------------------	-----------	----------	-----------	----------	-----------	----------	----------	----------	-----------

	F= Female	SF= 1µ AU	T= Tin Plated	BK= Black	H= 6,0mm Boardlock Rivet X=6,0 Y=4,0mm	E=Rear Rivet	R= ROHS Conform	TY= TRAY Packing
09= 9Pos Contact		SA= 3µ AU		WH= White	I= 7,0mm Boardlock Rivet X=7,0 Y=3,0mm	F=Rear Rivet + loose Screw 5,0/10,0mm	N= Non ROHS Conform	
		SB= 5µ AU		BL= Blue		H=Rear Rivet + loose Screw 4,8/11,8mm		
		SC= 15µ AU			J= 8,0mm Boardlock Rivet X=8,0 Y=2,0mm	I=Rear Rivet + Fixed HEX Screw 4,8/11,8mm		
		SD= 30µ AU				G=Rear Rivet + Fixed Hex Screw 5,0/10,0mm	K=Rear Rivet + Fixed Hex Screw 5,8/12,0mm	

D-SUB-Connector / Stamped Contact / High Body	
Part No.:	T24E2048-
Customer:	

DRW:	Jason	CHKD	Wilson	MATL:	Wilson	TOLERANCE	Mason	DATE	21.09.2022
APPD:	Schumi			FINISH	Jamy		Sheet No.		3 from 4



Soldering Profile Curve

Classification Reflow Profile (JEDEC J-STD-020C)

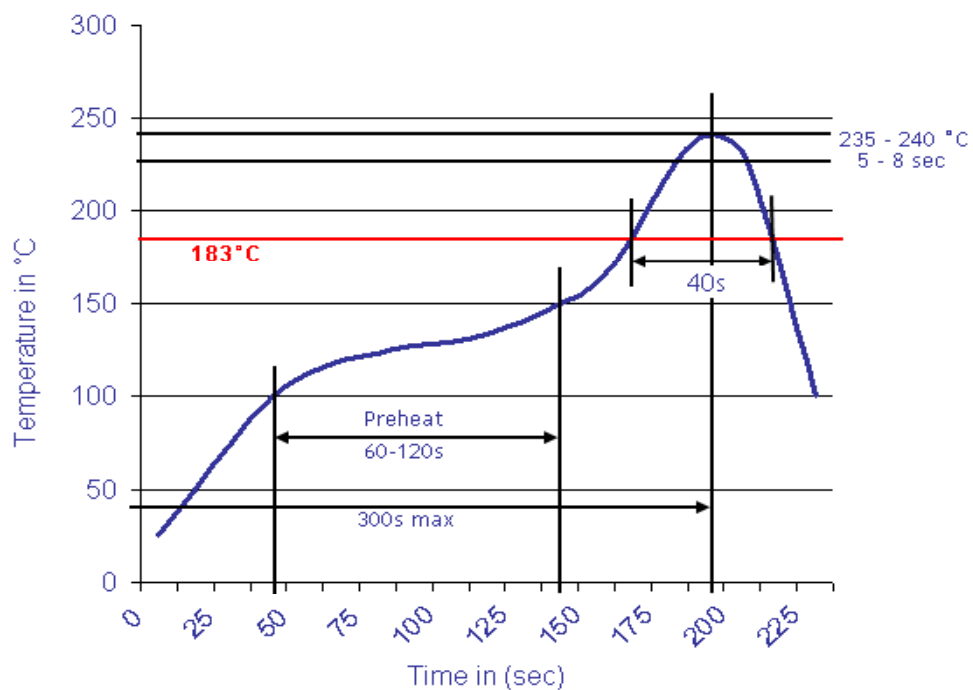

**D-SUB-Connector / Stamped
Contact / High Body**

Part No.: **T24E2048-**

DRW:	Jason	CHKD	Wilson	MATL:	Wilson	TOLERANCE	Mason	DATE	21.09.2022	Customer:
APPD:	Schumi			FINISH	Jamy		Sheet No.	4 from 4		

