

EDCON-COMPONENTS

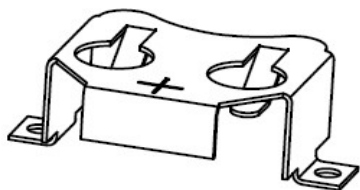

Technical Drawing (mm)

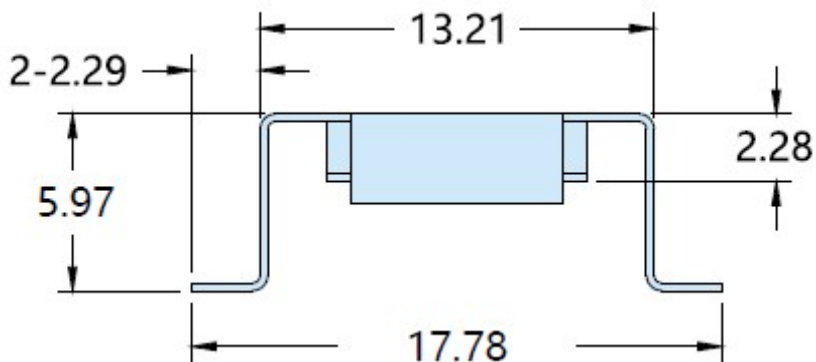

PCB-PAD-Layout (mm)

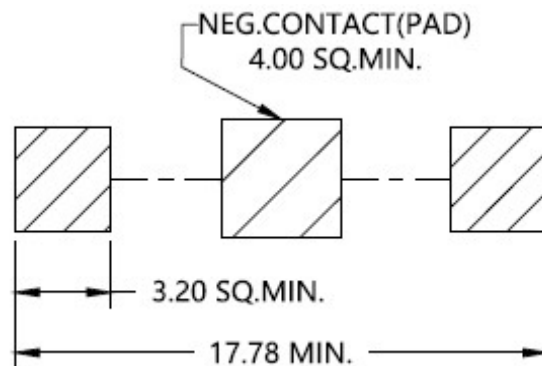

Technical Specification

| | |
|------------------------|------------------------|
| Material: | Phosphor Bronze |
| Finish/Plating: | Matte Tin / Ni-Plated |
| Contact Resistance: | low contact resistance |
| Mechanical Durability: | >100Cycles |
| Operating Temperature: | -.40°c to +105°C |

Reliable spring tension assures low contact resistance

Retains battery securely to withstand shock and vibration
Ideal for high Density Packing
The most off parts available into SMD and THT

Mating for Battery Type:
LR44, SR44, AG13, 357, MS76, 303, 313

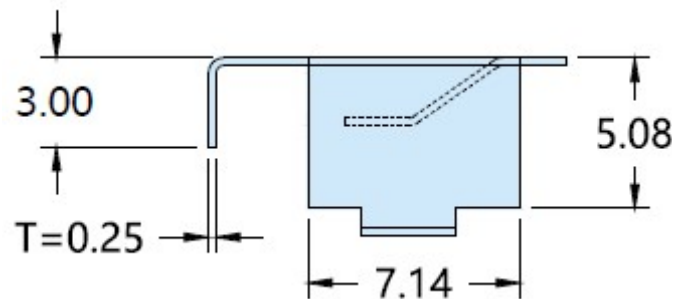
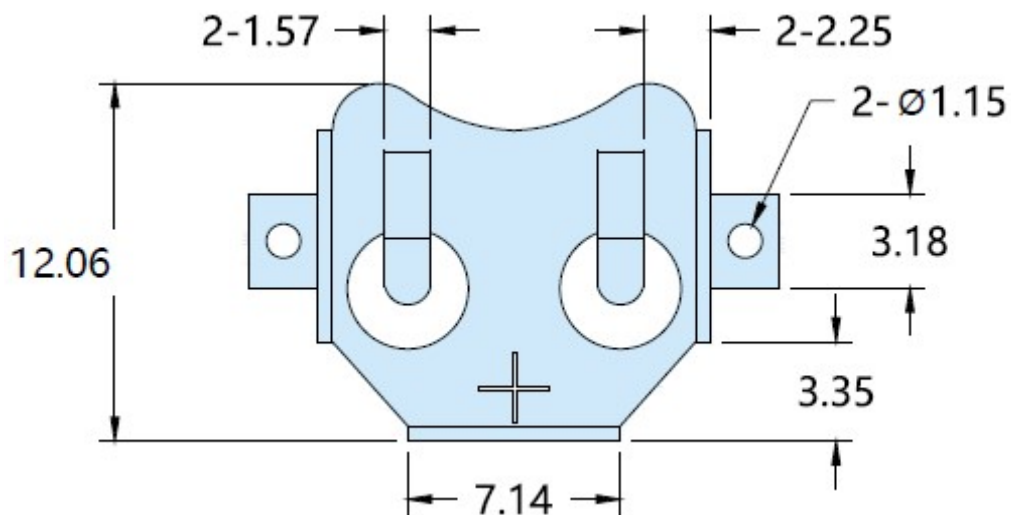

**Coin Cell Holder for
Battery Ø11,6mm**

Part No.: **B23145**

Customer:

| | | | | | | | | | |
|-------|--------|------|--------|--------|--------|-----------|--------------------|------|------------|
| DRW: | Jason | CHKD | Wilson | MATL: | Wilson | TOLERANCE | Mason | DATE | 28.01.2023 |
| APPD: | Schumi | | | FINISH | Jamy | | Sheet No. CCR-1156 | | 1 from 3 |

www.edcon-components.com

email: info@edcon-components.com

EDCON-COMPONENTS

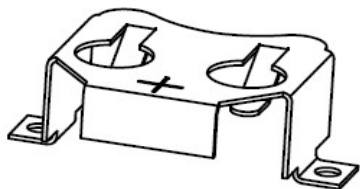

Ordering Informations

| Serie | Contact Plating | Spezial Function | Spezial Function | Spezial Function | ROHS | Packing | | | | |
|---------------|-----------------|------------------|------------------|------------------|----------|-----------|--|--|--|--|
| B23145 | NI | 0 | 0 | 0 | R | TR | | | | |

| | | | | | |
|------------------------------|------------------------|------------------------|------------------------|-------------------------|-----------------------|
| NI = Nickel-Plated | 0 = No function | 0 = No function | 0 = No function | R = ROHS Conform | BU = Bulk-Ware |
| MN = Matte Tin-Plated | | | | | |
| | | | | | TR = Tape Reel |

| |
|---|
| Coin Cell Holder for Battery Ø11,6mm |
| Part No.: B23145 |
| Customer: |

| | | | | | | | | | |
|-------|--------|------|--------|--------|--------|-----------|--------------------|------|------------|
| DRW: | Jason | CHKD | Wilson | MATL: | Wilson | TOLERANCE | Mason | DATE | 28.01.2023 |
| APPD: | Schumi | | | FINISH | Jamy | | Sheet No. CCR-1156 | | 2 from 3 |



Soldering Profile Curve

Classification Reflow Profile (JEDEC J-STD-020C)

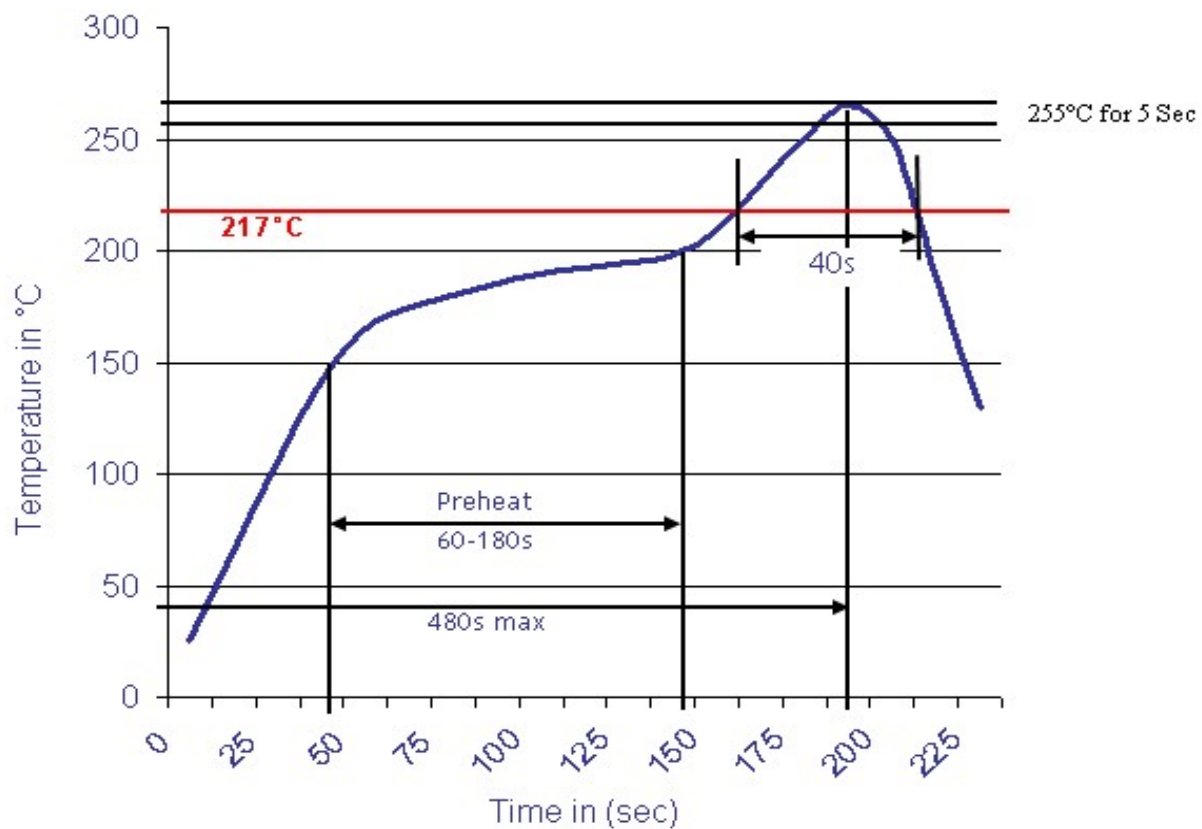

| | |
|---|---------------|
| Coin Cell Holder for Battery Ø11,6mm | |
| Part No.: | B23145 |
| Customer: | |

| | | | | | | | | | |
|-------|--------|---------|--------|-------|--------|------------|-------|-------|------------|
| DRW: | Jason | CHKD: | Wilson | MATL: | Wilson | TOLERANCE: | Mason | DATE: | 28.01.2023 |
| APPD: | Schumi | FINISH: | Jamy | | | Sheet No.: | | | 3 from 3 |