



DATA SHEET

THT 7P + 6P SATA-Connector TOP-Entry

Serie: T12015

**THT 7P + 6P SATA-Connector
TOP-Entry**

Serie No.: **T12015**

Customer:

DRW:	Jason	CHKD	Wilson	MATL:	Wilson	TOLERANCE	Mason	DATE	18.03.2018
APPD:	Schumi			FINISH	Jamy		Sheet No.		1 from 5

EDCON-COMPONENTS



Technical Description

Material Housing: LCP (UL94V-0)
 Colour of Body: Black
 Contact Material: Phosphor Bronze 0,25mm C5191
 Board Lock Material: Brass C2680,
 Contact Plating: Gold Flash on Contact Area
 Tin plating on Soldering Area over Nickel
 Lifetime: 500cycles

 Current Rating: 1,5A
 Voltage Rating: 40VAC
 Contact Resistance: 30mΩ max.
 Withstanding Voltage: 500VAC
 Resistance: 1000MΩ min.
 Temperature Range: -20°C to + 85°C

Technical Drawing (mm)

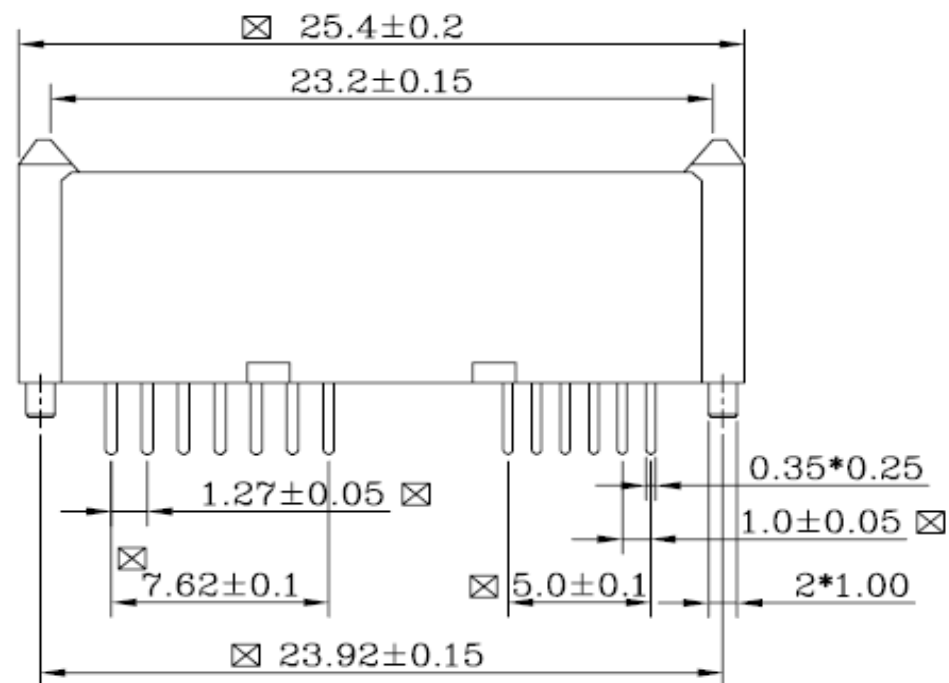

PCB Layout (mm)

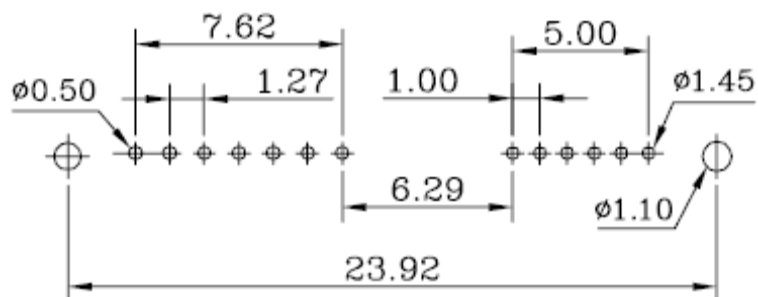

**THT 7P + 6P SATA-Connector
TOP-Entry**

Part No.: **T12015**

Customer:

DRW:	Jason	CHKD	Wilson	MATL:	Wilson	TOLERANCE	Mason	DATE	18.03.2018
APPD:	Schumi			FINISH	Jamy		Sheet No.		2 from 5

EDCON-COMPONENTS



Technical Drawing (mm)

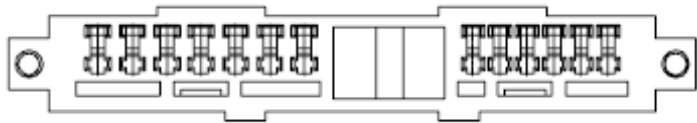
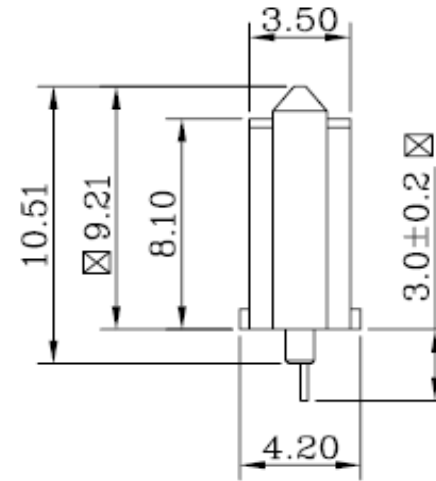
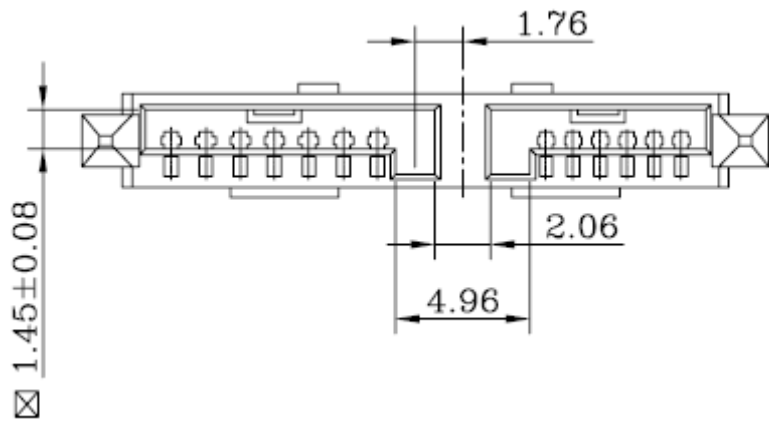

**THT 7P + 6P SATA-Connector
TOP-Entry**

Part No.: **T12015**

Customer:

DRW:	Jason	CHKD	Wilson	MATL:	Wilson	TOLERANCE	Mason	DATE	18.03.2018
APPD:	Schumi			FINISH	Jamy		Sheet No.		3 from 5

EDCON-COMPONENTS



Ordering Informations

Customer	Connector No of Pos 1	Connector No of Pos 2	Contact Plating	Body Colour	Body Material	Special function	ROHS	Packing Code		
----------	-----------------------	-----------------------	-----------------	-------------	---------------	------------------	------	--------------	--	--

T12015	7	6	G0	BK	LC	N	R	TY		
---------------	----------	----------	-----------	-----------	-----------	----------	----------	-----------	--	--

7= 7Pos. of Contact		G0= Gold Flash	BK= Black	LC= LCP	N= No special function	R= ROHS Conform	TY= Tray Package
	6= 6Pos. of Contact	GA= 5µ Gold Flash				N= NON ROHS Conform	TR= Tape/Reel Package
		GB= 10µ Gold Flash					TC= Tape/Reel w. Pic and Place CAP Package TOP-SIDE
							IV= Individual Package

**THT 7P + 6P SATA-Connector
TOP-Entry**

Part No.: **T12015**

DRW:	Jason	CHKD	Wilson	MATL:	Wilson	TOLERANCE	Mason	DATE	18.03.2018
APPD:	Schumi			FINISH	Jamy		Sheet No.		4 from 5

Customer:



Soldering Profile Curve

Classification Reflow Profile (JEDEC J-STD-020C)

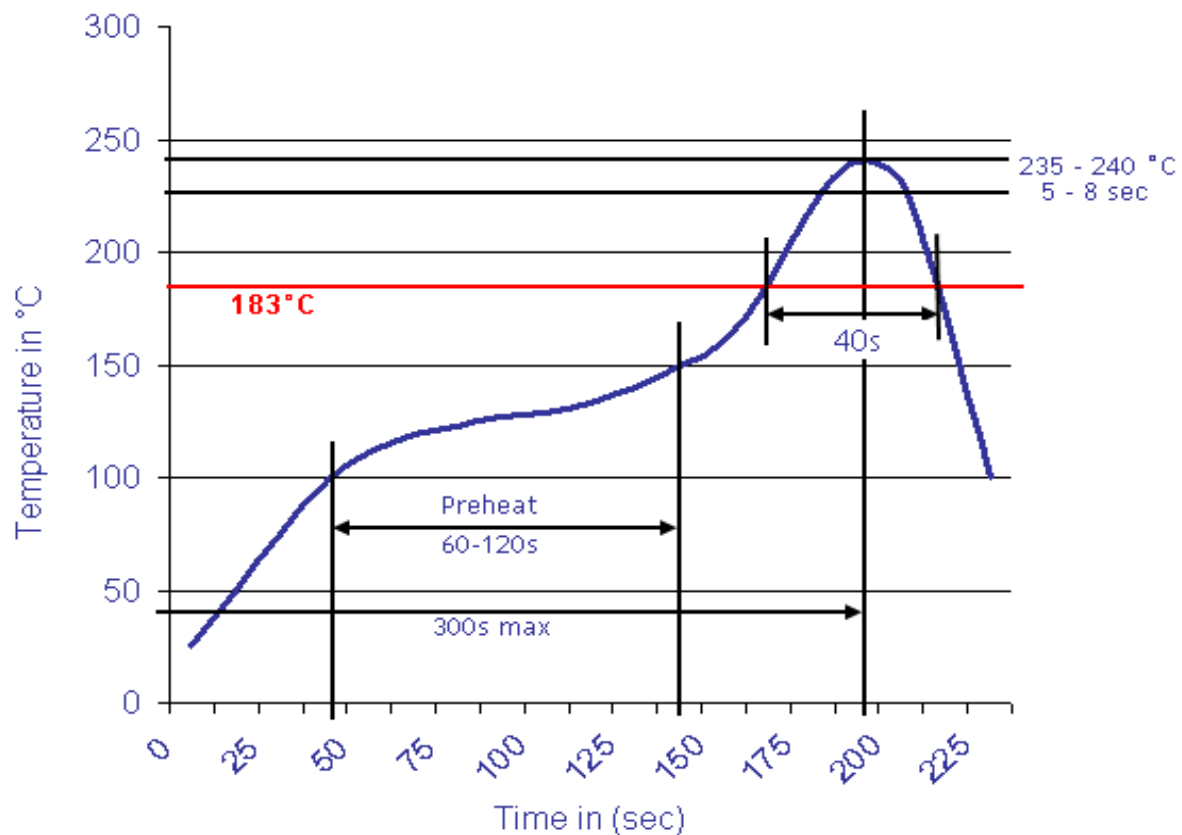

THT 7P + 6P SATA-Connector TOP-Entry	
Part No.:	T12015
Customer:	

DRW:	Jason	CHKD	Wilson	MATL:	Wilson	TOLERANCE	Mason	DATE	18.03.2018
APPD:	Schumi			FINISH	Jamy		Sheet No.		5 from 5