

# Data Sheet

## PCB IDC Terminal

**Pitch: 0,00 mm**

**Serie: A41001**

### Customer Information for special Item

**EDCON Customer : 0**

**Customer Version No. : 0**

# EDCON-COMPONENTS



## Technical Discription

## Drawing (Dimension in mm)

### Electrical

Rated Voltage                      Dependant on Component Proximity  
 Rated Current                      6A  
 Wire Range                          0,34 ~ 0,75mm<sup>2</sup>

### Mechanical

Operating Temperature            -40°C ~ +125°C  
 Wire Strip Length                 5-6mm

### Dimensions

Poles                                    1 Pos.

### Materials

Body                                    Bronze Contact  
 Plastic Part                         PC Body

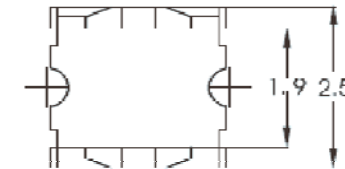
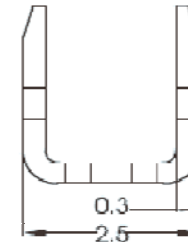
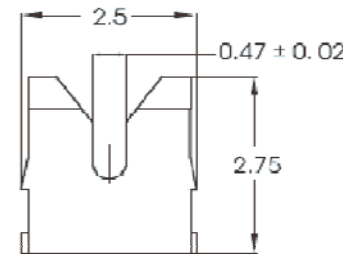
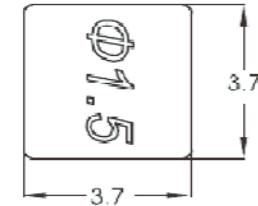
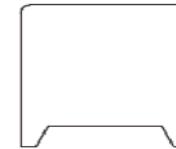
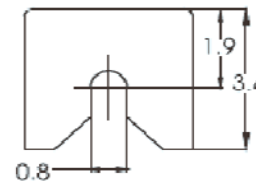

### PCB IDC Terminal

Part No.: **A41001**

Customer:

DRW:	Jason	CHKD	Wilson	MATL:	Wilson	TOLERANCE	Mason	DATE	28.06.2018
APPD:	Schumi			FINISH	Jamy		Sheet No.		1 from 3

# EDCON-COMPONENTS



## Ordering Informations

Serie	No. of Pos.	Body Color	Screw Type	Approval Code	ROHS	Packing				
-------	-------------	------------	------------	---------------	------	---------	--	--	--	--

<b>A41001</b>	-	<b>01</b>	<b>WH</b>	<b>C</b>	<b>N</b>	<b>R</b>	<b>B</b>			
---------------	---	-----------	-----------	----------	----------	----------	----------	--	--	--

<b>01</b> = Number of Pos.			<b>N</b> = NON Approval	<b>R</b> = ROHS Conform	<b>B</b> = Bulk-Ware	
	<b>WH</b> = White			<b>N</b> = NON ROHS Conform	<b>I</b> = Individual Package	
		<b>C</b> = Screwless Type				

<b>PCB IDC Terminal</b>
Part No.: <b>A41001</b>
Customer:

DRW:	Jason	CHKD	Wilson	MATL:	Wilson	TOLERANCE	Mason	DATE	28.06.2018
APPD:	Schumi			FINISH	Jamy			Sheet No.	2 from 3



Soldering Profile Curve

Classification Reflow Profile (JEDEC J-STD-020C)

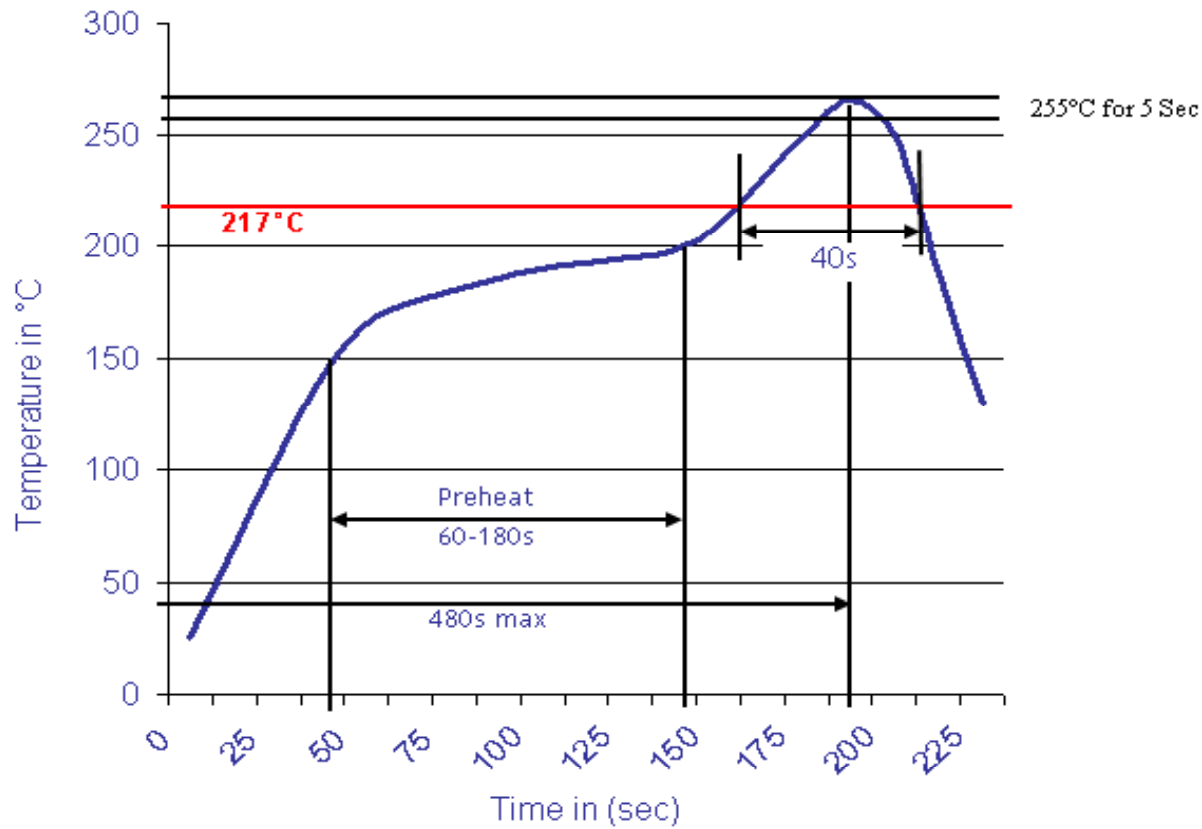

<b>PCB IDC Terminal</b>	
Part No.:	<b>A41001</b>
Customer:	

DRW:	Jason	CHKD:	Wilson	MATL:	Wilson	TOLERANCE:	Mason	DATE:	28.06.2018
APPD:	Schumi			FINISH:	Jamy		Sheet No.		3 from 3