

# EDCON-COMPONENTS



## Electric Data

Characteristic Impedance	50 Ohm, 75 Ohm
Frequency Range	0-4 GHz
Working Voltage	500 VRMS (max sea Level)
Dielectric Withstanding Voltage	1500 VRMS (min sea Level)
VSWR	≤ 1.30
Contact Resistance	Inner: 1.5 milliohms (max.) Outer: 1 milliohms (max.)
Insulation Resistance	5000 Megaohms (min)

## Drawing ( dimensions all into mm)

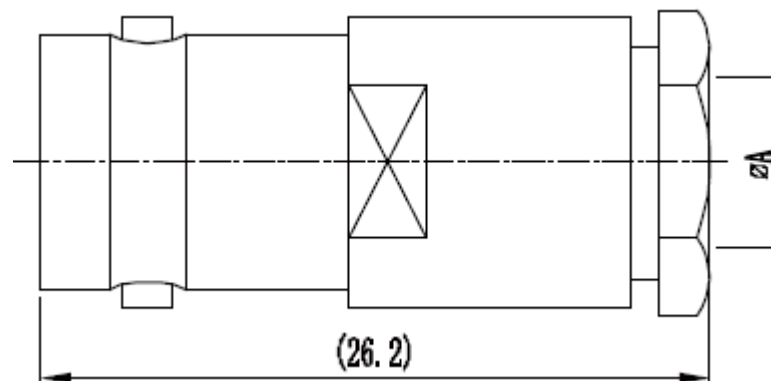

## Mechanical Data

Durability Mating	500 Cycles (min)
-------------------	------------------

## Material Data

Connector Parts	Materials	Plating Finish
Body	Brass	Nickel
Female Pin	Beryllium Bronze or Phosphor Bronze	Gold
Insulators	PTFE	N/A

## PCB Layout

## Environmental Data

Temperature Range	-65 ~ +165°C
-------------------	--------------

**BNC Female Straight Clamp  
Type**

Part No.: **T55S1152-**

Note: We can provide other materials and plating specifications according to customers requirements

DRW:	Jason	CHKD	Wilson	MATL:	Wilson	TOLERANCE	Mason	DATE	14.12.2017	Customer:
APPD:	Schumi			FINISH	Jamy		Sheet No.	1 from 2		

[www.edcon-components.com](http://www.edcon-components.com)

email: [info@edcon-components.com](mailto:info@edcon-components.com)

# EDCON-COMPONENTS



## Ordering Informations

Serie	Impedance	Contact Pin Plating	Body Material	Body Plating	Special function	Contact Pin Material	ROHS	Packing		
-------	-----------	---------------------	---------------	--------------	------------------	----------------------	------	---------	--	--

<b>T55S1152-</b>	<b>50</b>	<b>GO</b>	<b>BR</b>	<b>NI</b>	<b>A</b>	<b>BB</b>	<b>R</b>	<b>BU</b>		
------------------	-----------	-----------	-----------	-----------	----------	-----------	----------	-----------	--	--

<b>50= 50Ω</b>	<b>G0= Gold Plated</b>	<b>BR= Brass Material</b>	<b>NI= Nickel Plated</b>	<b>A= A=6.0</b>	<b>BB=BE Bronze</b>	<b>R= ROHS Conform</b>	<b>BU= Bulk Ware</b>		
<b>75= 75Ω</b>				<b>B= A=6.5</b>	<b>PB= P Bronze</b>	<b>N= NON ROHS Conform</b>	<b>IV= Individual Package</b>		

**A= 5/75S ( SFF-75-3-1, SYV-75-3, 3C-2V )**  
**B= 6/75S ( RG-59B/U )**

<b>BNC Female Straight Clamp Type</b>	
Part No.:	<b>T55S1152-</b>
Customer:	

DRW:	Jason	CHKD	Wilson	MATL:	Wilson	TOLERANCE	Mason	DATE	14.12.2017
APPD:	Schumi			FINISH	Jamy		Sheet No.		2 from 2