

EDCON-COMPONENTS

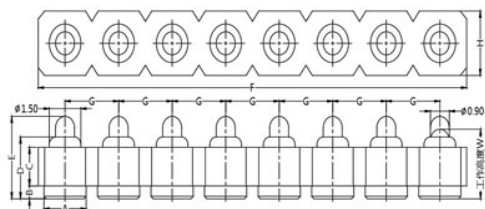

Technical Description

Drawing

1 Material:

Material Body:	C2700
Gold Plated:	16-20µm
Nickel:	60-120µm
Material Needle:	C3604
Gold Plated:	4-8µm
Nickel:	60-120µm
Spring:	SUS304
Body:	PA46

2 Mechanical Properties

Pitch:	2,54mm
Working height:	5,0~5,3mm
Elastic:	85 ±15gr

Lifetime: more than 10000 times

3 Electrical Performance:

4 Isolation Resistance:

Withstanding Voltage:	500M Ohm min.
Max. Rated Voltage:	500VAC/DC
Contact Resistance:	36VDC dynamic range of work with impedance less than <30m Ohm

Rated current: 2,5A

5 Packing Specification:

Max. Soldering Temperature: 260°C

Operating Temperature: -40°C to +85°C

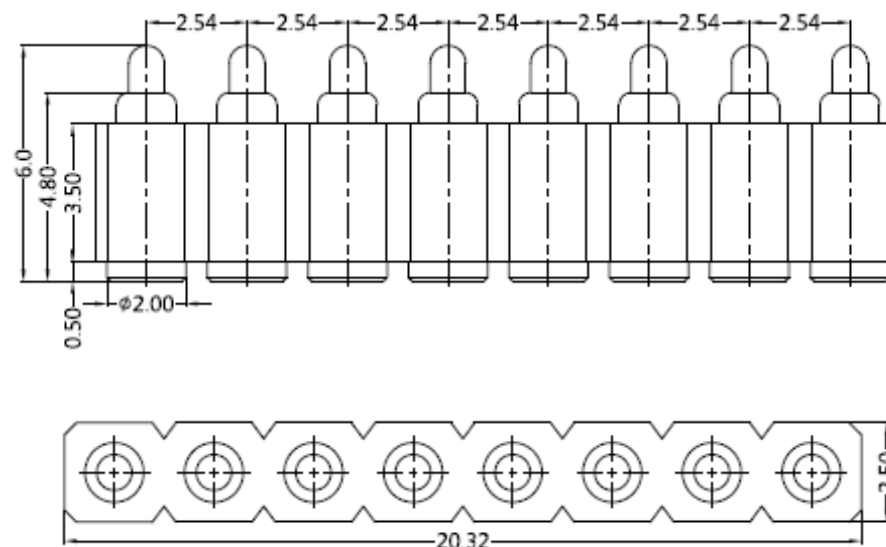
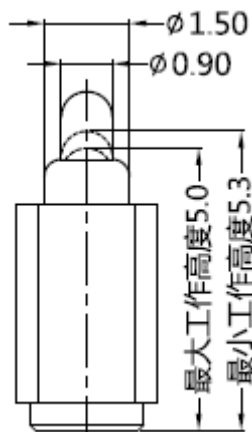

Tolerance				8 POGO PIN with Plastic
0.	0.0	0.00	0.000	
± -	± 0,30	± 0,15	± -	Part No.: TA23B9004
DRW: Jason	CHKD Wilson	MATL: Wilson	TOLERANCE Mason	DATE 06.12.2017
APPD: Schumi	FINISH Jamy		Sheet No.	1 from 3
				Customer:

EDCON-COMPONENTS

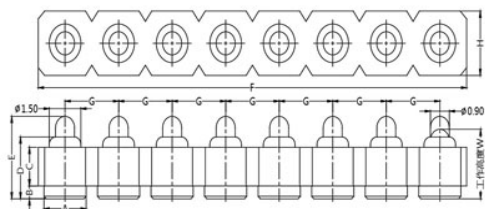

PCB Layout (mm)

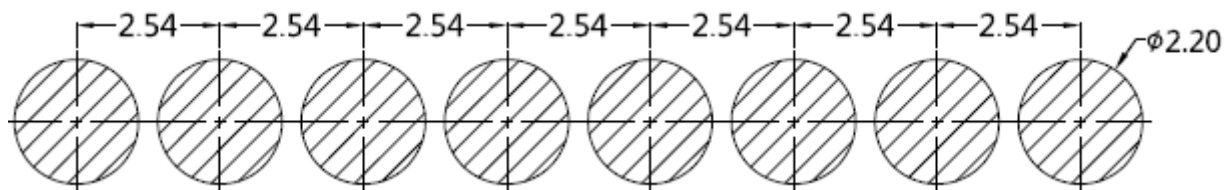

Ordering Informations

Serie	Number of Position	Material Body	Material Needle	Contact Plat. Body	Contact Plat. Needle	Spezial Function	ROHS	Packing		
TA23B9004	08	A	A	G0	G0	N	R	BU		

08= Position	A= Material C3604	A= Material C3604	G0= Gold Flash <16-20µinch	G0= Gold Flash 4-8µinch	N= No function	R= ROHS Conform	BU= Bulk-Ware Standard
	B= Material C2700	B= Material C2700					
			N0= Nickel 60-120µinch	N0= Nickel 60-120µinch			TR= Tape Reel

8 POGO PIN with Plastic

Part No.: TA23B9004

DRW:	Jason	CHKD	Wilson	MATL:	Wilson	TOLERANCE	Mason	DATE	06.12.2017	Customer:
APPD:	Schumi			FINISH	Jamy		Sheet No.	2 from 3		

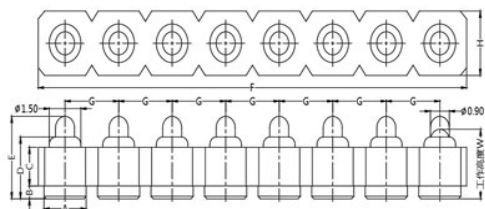

Soldering Profile Curve

Classification Reflow Profile (JEDEC J-STD-020C)

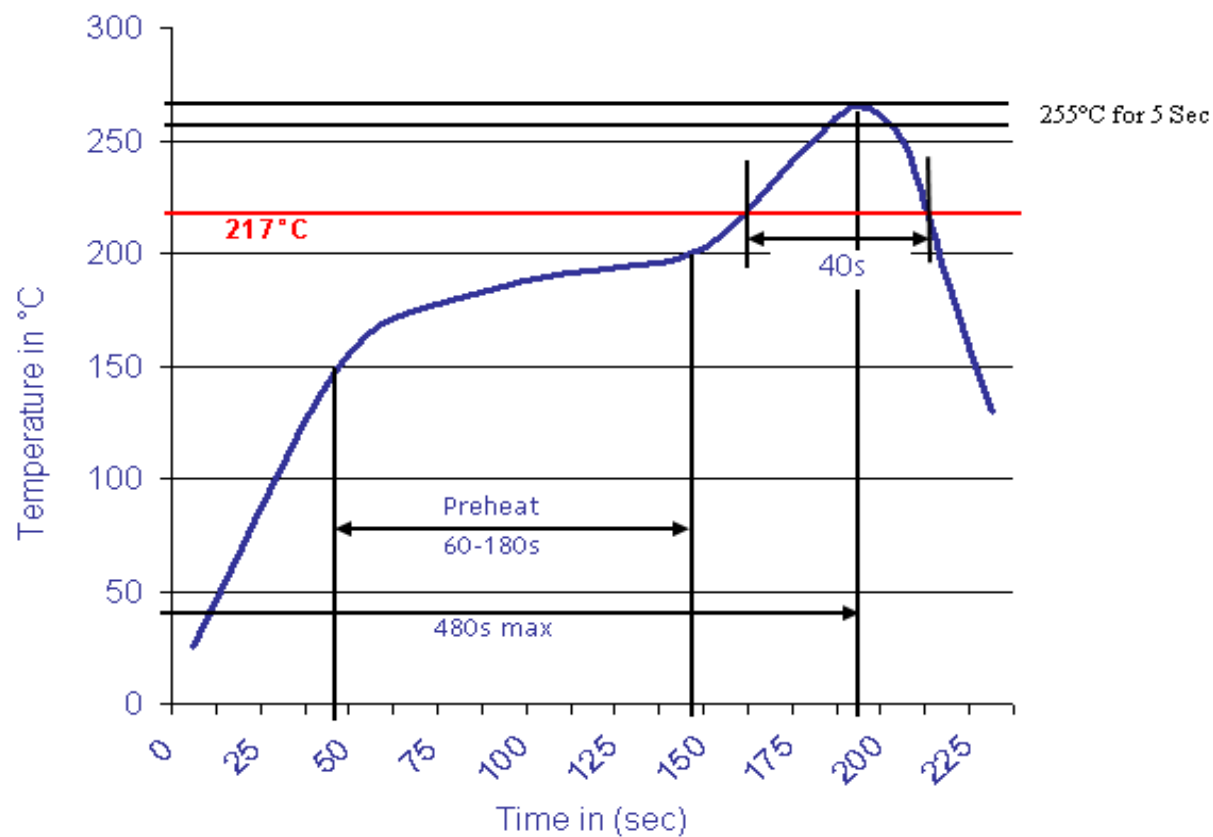

8 POGO PIN with Plastic	
Part No.:	TA23B9004
Customer:	

DRW:	Jason	CHKD	Wilson	MATL:	Wilson	TOLERANCE	Mason	DATE	06.12.2017
APPD:	Schumi			FINISH	Jamy		Sheet No.	3 from 3	