



# DATA SHEET

## THT BCD ROTARY Switch 3/3 Pitch 7,62mm 180°

**Serie: Q27030**

<b>THT BCD ROTARY Switch 3/3 Pitch 7,62mm 180°</b>	
Serie No.:	<b>Q27030</b>
Customer:	

DRW:	Jason	CHKD	Wilson	MATL:	Wilson	TOLERANCE	Mason	DATE	26.10.2021
APPD:	Schumi			FINISH	Jamy		Sheet No.		1 from 6

# EDCON-COMPONENTS

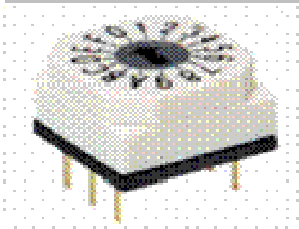

## Specifications

### Material

Housing/Knob:	Thermoplastic
O-Ring:	Silicone Rubber
Terminal:	Precisious metal on phosphor bronze
Colour of Housing	Black

### Mechanical:

Switching Positions	8, 10,16 positions
Operating force:	350gr-cm max.
Life:	10.000detens

### Electrical:

Max. Load Rating:	
Switching:	50mA, 24VDC
Non Switching:	100mA, 50VDC
Contact Resistance:	100mΩ max.
Insulation Resistance:	1000M Ω at 100VDC
Dielectric Strength:	250VAC for 1 minute

### Environmental:

Operating Temperature:	. -10°C to +70°C
Soldering Temperature:	max. 250 ± 5°C for 5 seconds

## Features

Fully Sealed construction  
 Low Profile , Low Cost  
 Gold Plated contacts  
 Molded-In terminals  
 Snap-In mounting on PCB

**THT BCD ROTARY Switch 3/3  
 Pitch 7,62mm 180°**

Part No.: **Q27030**

DRW:	Jason	CHKD	Wilson	MATL:	Wilson	TOLERANCE	Mason	DATE	26.10.2021
APPD:	Schumi			FINISH	Jamy		Sheet No.	2 from 6	

Customer:

# EDCON-COMPONENTS

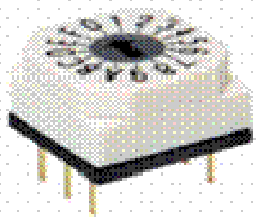

## Switch Code

BCD Order Code = 08S					
Position	BCD Real 8 Position				
	Communc contacted				
	1	2	4	8	C
0					
1					
2					
3					
4					
5					
6					
7					

BCD Order Code = 16S					
Position	BCD Real 16 Position				
	Communc contacted				
	1	2	4	8	C
0					
1					
2					
3					
4					
5					
6					
7					
8					
9					
A					
B					
C					
D					
E					
F					

BCD Order Code = 10C					
Position	BCD Complement 10Pos.				
	Communc contacted				
	1	2	4	8	C
0					
1					
2					
3					
4					
5					
6					
7					
8					
9					

BCD Order Code = 10S					
Position	BCD Real 10 Position				
	Communc contacted				
	1	2	4	8	C
0					
1					
2					
3					
4					
5					
6					
7					
8					
9					

**THT BCD ROTARY Switch 3/3**  
**Pitch 7,62mm 180°**  
 Part No.: **Q27030**

DRW:	Jason	CHKD	Wilson	MATL:	Wilson	TOLERANCE	Mason	DATE	26.10.2021	Customer:
APPD:	Schumi			FINISH	Jamy		Sheet No.	2 from 6		

# EDCON-COMPONENTS

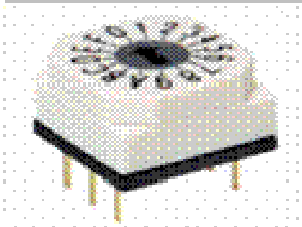

Switch Code

Technical Dimensions (mm)

PCB Layout (mm)

BCD Order Code = 16C					
Position	BCD Complement 16 Position				
	Common c contacted				
	1	2	4	8	C
0					
1					
2					
3					
4					
5					
6					
7					
8					
9					
A					
B					
C					
D					
E					
F					

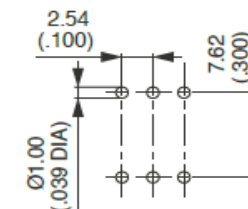
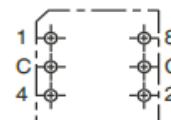
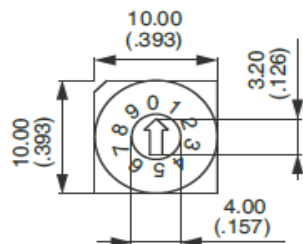
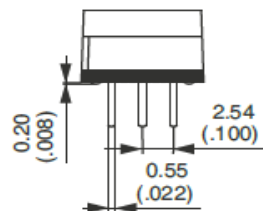
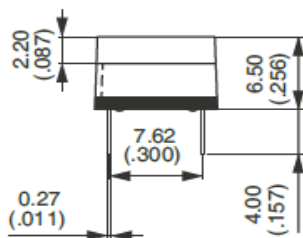

**THT BCD ROTARY Switch 3/3  
Pitch 7,62mm 180°**

Part No.: **Q27030**

DRW:	Jason	CHKD	Wilson	MATL:	Wilson	TOLERANCE	Mason	DATE	26.10.2021
APPD:	Schumi			FINISH	Jamy		Sheet No.	4 from 6	Customer:

[www.edcon-components.com](http://www.edcon-components.com)

email: [info@edcon-components.com](mailto:info@edcon-components.com)

# EDCON-COMPONENTS

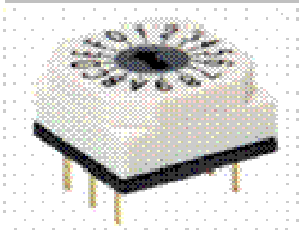

## Ordering Informations

Serie	BCD Order Code	Rotor Style	Terminal Style	ROHS	Packing Code					
<b>Q27030</b>	<b>16S</b>	<b>0</b>	<b>33</b>	<b>R</b>	<b>TU</b>					

<b>10S=</b> Type 10S	<b>0=</b> Arrow for Screwdriver <b>7=</b> Cross Style for Accessories	<b>33=</b> (3+3) Legs P7,62	<b>R=</b> ROHS Conform	<b>TU=</b> Tube Packing
			<b>N=</b> NON ROHS Conform	<b>TY=</b> Tray Packing
<b>16S=</b> Type 16S				<b>BU=</b> Bulk Ware
<b>10C=</b> Type 10C				
<b>16C=</b> Type 16C				

**Rotor Style 0**  
SCREWDRIVER

**Rotor Style 7**  
Cross for Accessories

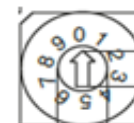

**THT BCD ROTARY Switch 3/3**  
**Pitch 7,62mm 180°**

Part No.: **Q27030**

DRW:	Jason	CHKD	Wilson	MATL:	Wilson	TOLERANCE	Mason	DATE	26.10.2021
APPD:	Schumi			FINISH	Jamy		Sheet No.		5 from 6

Customer:

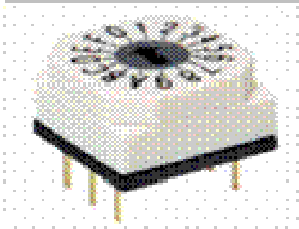

Soldering Profile Curve

Classification Reflow Profile (JEDEC J-STD-020C)

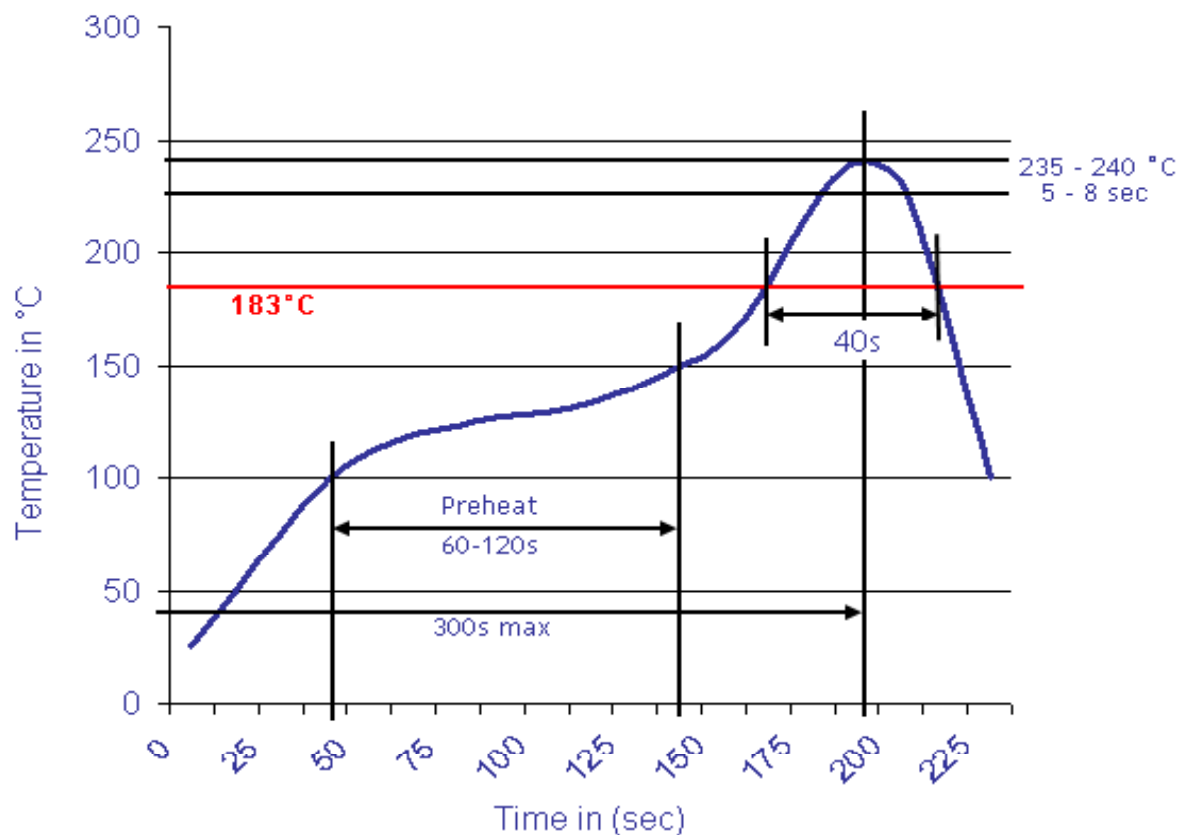

<b>THT BCD ROTARY Switch 3/3</b>	
<b>Pitch 7,62mm 180°</b>	
Part No.:	<b>Q27030</b>
Customer:	

DRW:	Jason	CHKD	Wilson	MATL:	Wilson	TOLERANCE	Mason	DATE	26.10.2021
APPD:	Schumi			FINISH	Jamy		Sheet No.	6 from 6	