

Technical Specification

Features

- Wire Wound Construction
- Polyolefin Shrink Tube
- Excellent heat resistance
- Excellent environmental characteristics
- High reliability

Applications

- Power Supplies
- SCR and TRIAC Controls
- RFI Suppression
- Filters
- Switching Regulators

Dimensions

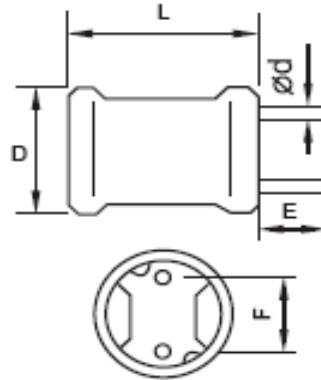

| Technical Dimensions | | | |
|----------------------|--------|--------|--------|
| D (mm) | L (mm) | E (mm) | F (mm) |
| 10,5 | 14,0 | 10 | 6 |
| d (mm) | | | |
| 0,7 | | | |

Electrical Characteristics

Technical Information

Testing LCR Bridge, measured @ 1KHz 0,1V HP4284A
 Equivalent acceptacle
 RDC. QuadTech 1880 Milliohmmeter
 IDC: Max. Lowers inductance by 10%
 Operating Temperature: -55°C ~ +125°C
 Shrink tube: Flame retardent UL type VW-1
 Marking: Inductance and tolerance
 Note: All specifications subject to change without notice.

| Inductance | Inductance Code | IDC | DCR max. |
|-------------------------|-------------------|--------|----------|
| 180µH | 181 | 0,900A | 0,220Ω |
| Self-Resonant Frequency | L-Test Conditions | | |
| 796KHz | 1KHz, 0,25V | | |

THT Radial Power Choke

Part No.: **S10R95**

Customer:

| | | | | | | | |
|-------|-------|------|-------|--------|-------|-------|------------|
| DRW: | Jason | CHKD | Jules | MATL: | Wu | DATE | 22.06.2018 |
| APPD: | Join | | | FINISH | Shieh | Sheet | 1 from 2 |

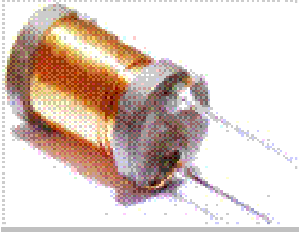

Soldering Profile

TYPICAL WAVE SOLDER PROFILE FOR LEADED AND LEAD-FREE THROUGH-HOLE PACKAGES

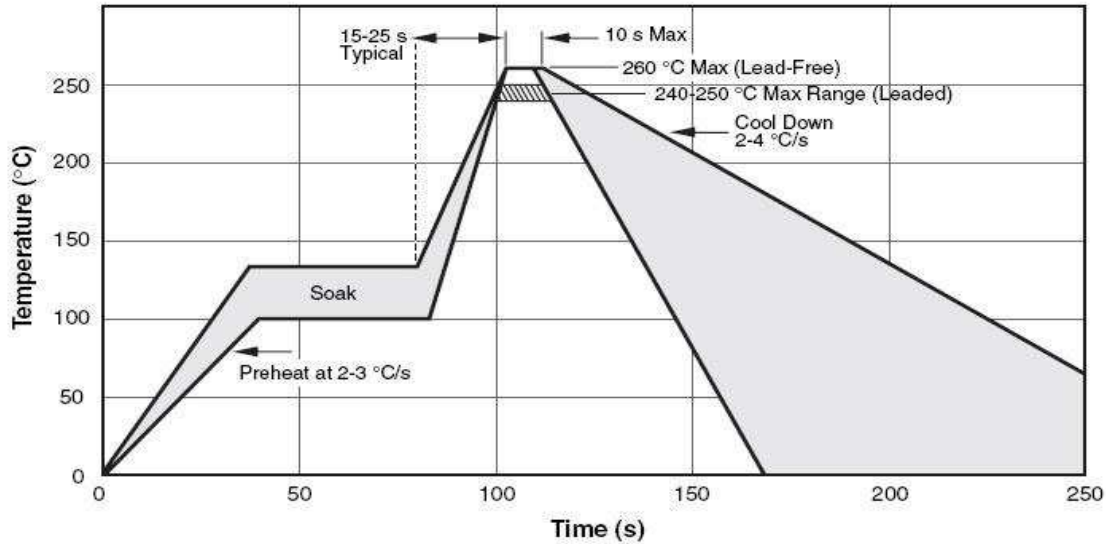

Ordering Information

| Serie | Inductance | Tolerance | Lead Length | ROHS | Packing | |
|---------------|------------|-----------|-------------|----------|-----------|--|
| S10R95 | 181 | M | 10 | R | BU | |

| | | | | |
|-------------------|--------------------|-----------------|---------------------------|-------------------------|
| 181= 180µH | M= Tol. 20% | 10= 10mm | R= ROHS conform | BU= Bulk Ware |
| | K= Tol. 10% | | N=NON ROHS conform | TY= Tray Package |

THT Radial Power Choke

Part No.: **S10R95**

Customer:

| | | | | | | | |
|-------|-------|------|-------|--------|-------|-------|------------|
| DRW: | Jason | CHKD | Jules | MATL: | Wu | DATE | 22.06.2018 |
| APPD: | Join | | | FINISH | Shieh | Sheet | 2 from 2 |