

**Technical Specification**

**Features**

Wire Wound Construction  
 Polyolefin Shrink Tube  
 Excellent heat resistance  
 Excellent environmental characteristics  
 High reliability

**Dimensions**

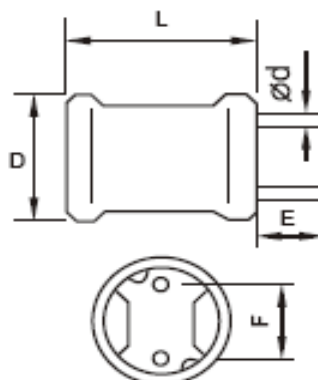

**Applications**

Power Supplies  
 SCR and TRIAC Controls  
 RFI Suppression  
 Filters  
 Switching Regulators

**Technical Dimensions**

D (mm)	L (mm)	E (mm)	F (mm)
10,5	14,0	10	6
d (mm)			
0,7			

**Electrical Characteristics**

**Technical Information**

Testing LCR Bridge, measured @ 1KHz 0,1V HP4284A  
 Equivalent acceptacle  
 RDC. QuadTech 1880 Milliohmmeter  
 IDC: Max. Lowers inductance by 10%  
 Operating Temperature: -55°C ~ +125°C  
 Shrink tube: Flame retardent UL type VW-1  
 Marking: Inductance and tolerance  
 Note: All specifications subject to change without notice.

Inductance	Inductance Code	IDC	DCR max.
15µH	150	3,000A	0,040Ω
Self-Resonant Frequency	L-Test Conditions		
2,52MHz	1KHz, 0,25V		

**THT Radial Power Choke**

Part No.: **S10R95**

Customer:

DRW:	Jason	CHKD	Jules	MATL:	Wu	DATE	22.06.2018
APPD:	Join			FINISH	Shieh	Sheet	1 from 2



**Soldering Profile**

**TYPICAL WAVE SOLDER PROFILE FOR LEADED AND LEAD-FREE THROUGH-HOLE PACKAGES**



**Ordering Information**

Serie	Inductance	Tolerance	Lead Length	ROHS	Packing	
-------	------------	-----------	-------------	------	---------	--

<b>S10R95</b>	<b>150</b>	<b>M</b>	<b>10</b>	<b>R</b>	<b>BU</b>	
---------------	------------	----------	-----------	----------	-----------	--

<b>150=</b> 15µH	<b>M=</b> Tol. 20%	<b>10=</b> 10mm	<b>R=</b> ROHS conform	<b>BU=</b> Bulk Ware
	<b>K=</b> Tol. 10%		<b>N=</b> NON ROHS conform	<b>TY=</b> Tray Package

**THT Radial Power Choke**

Part No.: **S10R95**

Customer:

DRW:	Jason	CHKD	Jules	MATL:	Wu	DATE	22.06.2018
APPD:	Join			FINISH	Shieh	Sheet	2 from 2