

### Technical Specification

#### Features

Wire Wound Construction  
 Polyolefin Shrink Tube  
 Excellent heat resistance  
 Excellent environmental characteristics  
 High reliability

#### Applications

Power Supplies  
 SCR and TRIAC Controls  
 RFI Suppression  
 Filters  
 Switching Regulators

#### Dimensions

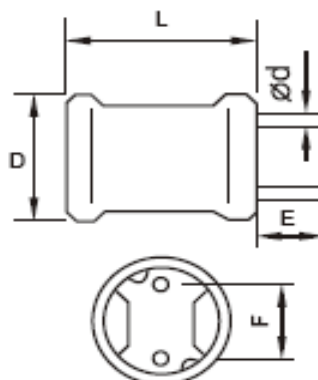

Technical Dimensions			
D (mm)	L (mm)	E (mm)	F (mm)
7,5	10,0	10	3 ±1
d (mm)			
0,6			

### Electrical Characteristics

#### Technical Information

Testing LCR Bridge, measured @ 1KHz 0,1V HP4284A  
 Equivalent acceptacle  
 RDC. QuadTech 1880 Milliohmmeter  
 IDC: Max. Lowers inductance by 10%  
 Operating Temperature: -55°C ~ +125°C  
 Shrink tube: Flame retardent UL type VW-1  
 Marking: Inductance and tolerance  
 Note: All specifications subject to change without notice.

Inductance	Inductance Code	IDC	DCR max.
50000µH	503	0,029A	170,0Ω
Self-Resonant Frequency	L-Test Conditions		
79,6 KHz	1KHz, 0,25V		

#### THT Radial Power Choke

Part No.: **S10R93**

Customer:

DRW:	Jason	CHKD	Jules	MATL:	Wu	DATE	22.06.2018
APPD:	Join			FINISH	Shieh	Sheet	1 from 2



**Soldering Profile**

**TYPICAL WAVE SOLDER PROFILE FOR LEADED AND LEAD-FREE THROUGH-HOLE PACKAGES**



**Ordering Information**

Serie	Inductance	Tolerance	Lead Length	ROHS	Packing	
<b>S10R93</b>	<b>503</b>	<b>M</b>	<b>10</b>	<b>R</b>	<b>BU</b>	

<b>503=</b> 50000µH	<b>M= Tol. 20%</b>	<b>10= 10mm</b>	<b>R= ROHS conform</b>	<b>BU= Bulk Ware</b>
	<b>K= Tol. 10%</b>		<b>N=NON ROHS conform</b>	

<b>THT Radial Power Choke</b>	
Part No.:	<b>S10R93</b>
Customer:	

DRW:	Jason	CHKD	Jules	MATL:	Wu	DATE	22.06.2018
APPD:	Join			FINISH	Shieh	Sheet	2 from 2