

**Technical Specification**

**Features**

- Wire Wound Construction
- Polyolefin Shrink Tube
- Excellent heat resistance
- Excellent environmental characteristics
- High reliability

**Applications**

- Power Supplies
- SCR and TRIAC Controls
- RFI Suppression
- Filters
- Switching Regulators

**Dimensions**

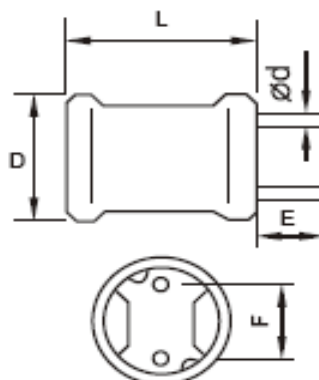

Technical Dimensions			
D (mm)	L (mm)	E (mm)	F (mm)
11,5	18,0	15	6,0
d (mm)			
0,8			

**Electrical Characteristics**

**Technical Information**

Testing LCR Bridge, measured @ 1KHz 0,1V HP4284A  
 Equivalent acceptacle  
 RDC. QuadTech 1880 Milliohmmeter  
 IDC: Max. Lowers inductance by 10%  
 Operating Temperature: -55°C ~ +125°C  
 Shrink tube: Flame retardent UL type VW-1  
 Marking: Inductance and tolerance  
 Note: All specifications subject to change without notice.

Inductance	Inductance Code	IDC	DCR max.
4,7µH	4R7	7,500A	0,020Ω
Self-Resonant Frequency	L-Test Conditions		
7,96MHz	1KHz, 0,25V		

**THT Radial Power Choke**

Part No.: **S10R100**

Customer:

DRW:	Jason	CHKD	Jules	MATL:	Wu	DATE	22.06.2018
APPD:	Join			FINISH	Shieh	Sheet	1 from 2



**Soldering Profile**

**TYPICAL WAVE SOLDER PROFILE FOR LEADED AND LEAD-FREE THROUGH-HOLE PACKAGES**



**Ordering Information**

Serie	Inductance	Tolerance	Lead Length	ROHS	Packing	
-------	------------	-----------	-------------	------	---------	--

<b>S10R100</b>	<b>4R7</b>	<b>M</b>	<b>15</b>	<b>R</b>	<b>BU</b>	
----------------	------------	----------	-----------	----------	-----------	--

<b>4R7= 4,7µH</b>	<b>M= Tol. 20%</b>	<b>15= 15mm</b>	<b>R= ROHS conform</b>	<b>BU= Bulk Ware</b>
	<b>K= Tol. 10%</b>		<b>N=NON ROHS conform</b>	<b>TY= Tray Package</b>

**THT Radial Power Choke**

Part No.: **S10R100**

Customer:

DRW:	Jason	CHKD	Jules	MATL:	Wu	DATE	22.06.2018
APPD:	Join			FINISH	Shieh	Sheet	2 from 2