

### Technical Specification

#### Features

Wire Wound Construction  
 Polyolefin Shrink Tube  
 Excellent heat resistance  
 Excellent environmental characteristics  
 High reliability

#### Applications

Power Supplies  
 SCR and TRIAC Controls  
 RFI Suppression  
 Filters  
 Switching Regulators

#### Dimensions

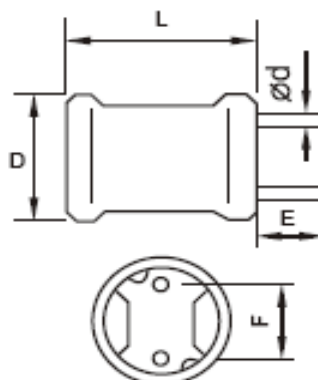

| Technical Dimensions |        |        |        |
|----------------------|--------|--------|--------|
| D (mm)               | L (mm) | E (mm) | F (mm) |
| 11,5                 | 18,0   | 15     | 6,0    |
| d (mm)               |        |        |        |
| 0,8                  |        |        |        |

### Electrical Characteristics

#### Technical Information

Testing LCR Bridge, measured @ 1KHz 0,1V HP4284A  
 Equivalent acceptacle  
 RDC. QuadTech 1880 Milliohmmeter  
 IDC: Max. Lowers inductance by 10%  
 Operating Temperature: -55°C ~ +125°C  
 Shrink tube: Flame retardent UL type VW-1  
 Marking: Inductance and tolerance  
 Note: All specifications subject to change without notice.

| Inductance              | Inductance Code   | IDC    | DCR max. |
|-------------------------|-------------------|--------|----------|
| 1000µH                  | 102               | 0,800A | 1,200Ω   |
| Self-Resonant Frequency | L-Test Conditions |        |          |
| 252KHz                  | 1KHz, 0,25V       |        |          |

#### THT Radial Power Choke

Part No.: **S10R100**

Customer:

|       |       |      |       |        |       |       |            |
|-------|-------|------|-------|--------|-------|-------|------------|
| DRW:  | Jason | CHKD | Jules | MATL:  | Wu    | DATE  | 22.06.2018 |
| APPD: | Join  |      |       | FINISH | Shieh | Sheet | 1 from 2   |



**Soldering Profile**

**TYPICAL WAVE SOLDER PROFILE FOR LEADED AND LEAD-FREE THROUGH-HOLE PACKAGES**



**Ordering Information**

| Serie          | Inductance | Tolerance | Lead Length | ROHS     | Packing   |  |
|----------------|------------|-----------|-------------|----------|-----------|--|
| <b>S10R100</b> | <b>102</b> | <b>M</b>  | <b>15</b>   | <b>R</b> | <b>BU</b> |  |

|                    |                    |                 |                           |                         |
|--------------------|--------------------|-----------------|---------------------------|-------------------------|
| <b>102= 1000µH</b> | <b>M= Tol. 20%</b> | <b>15= 15mm</b> | <b>R= ROHS conform</b>    | <b>BU= Bulk Ware</b>    |
|                    | <b>K= Tol. 10%</b> |                 | <b>N=NON ROHS conform</b> | <b>TY= Tray Package</b> |

|                               |                |
|-------------------------------|----------------|
| <b>THT Radial Power Choke</b> |                |
| Part No.:                     | <b>S10R100</b> |
| Customer:                     |                |

|       |       |      |       |        |       |       |            |
|-------|-------|------|-------|--------|-------|-------|------------|
| DRW:  | Jason | CHKD | Jules | MATL:  | Wu    | DATE  | 22.06.2018 |
| APPD: | Join  |      |       | FINISH | Shieh | Sheet | 2 from 2   |