

# EDCON-COMPONENTS



## Specifications

|                        |                                     |
|------------------------|-------------------------------------|
| Switch Rating:         | 5A/250VAC                           |
| Contact Configuration: | 1N0NC/2NO2NC                        |
| Operating Type:        | Momentary / Resetable               |
| IP-Degree:             | IP67                                |
| Crust Material:        | Stainless Steel/Nickel plated brass |
| Terminal Type:         | Screw-Terminal                      |
| Switching:             | ON / OFF                            |
| Contact Resistance:    | ≤ 50mΩ                              |
| Insulation Resistance: | ≥ 1000MΩ                            |
| Dielectric Strength:   | 2000VAC                             |
| Operating Temperature: | -20°C ~ +55°C                       |
| Mechanical Life:       | 500.000 cycles                      |
| Electrical Life:       | 50.000 cycles                       |
| Panel Thickness:       | 1 ~ 10mm                            |
| Torque:                | 5 ~ 14Nm                            |
| Operating Pressure:    | About 4N                            |
| Operating Distance:    | About 2,5Nm                         |

## Material

|                |  |
|----------------|--|
| Contact:       | Silver Alloy   |
| Button:        | Stainless Steel  |
| Body:          | Stainless Steel  |
| Base:          | PBT  |
| ROHS:          | Made to Order-Code   |
| Type:          | Illuminated (LED)  |
| Color:         | <div style="display: flex; align-items: center;"> <div style="margin-right: 20px;"> <span style="background-color: red; color: white; padding: 2px 5px;">R</span> <span style="background-color: yellow; color: black; padding: 2px 5px;">Y</span> <span style="background-color: orange; color: black; padding: 2px 5px;">O</span> </div> <div> <span style="background-color: green; color: white; padding: 2px 5px;">G</span> <span style="background-color: blue; color: white; padding: 2px 5px;">B</span> <span style="background-color: grey; color: white; padding: 2px 5px;">W</span> </div> </div> |
| Rated Voltage: | AC/DC 6V      AC/DC 12V  |
| Rated Current: | 15mA   |
| Lifetime:      | 40000Hrs   |

## Drawing

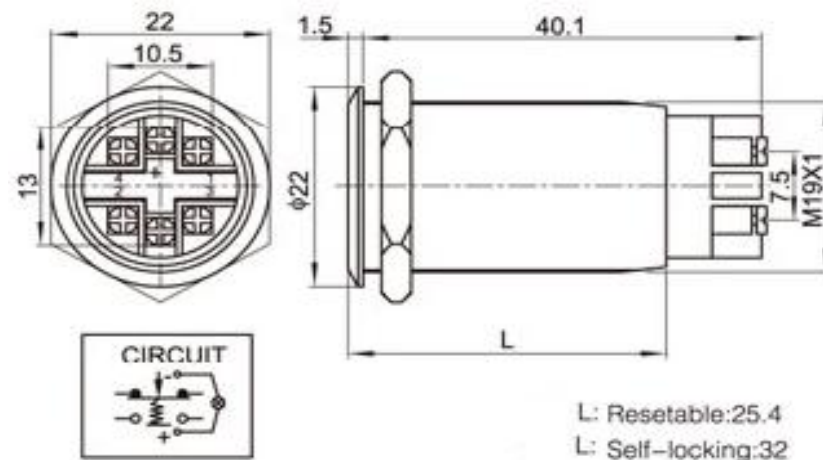

Current Limiting  
Resistance  
Configuration Table

| Operating Voltage (U)   | 6V         | 12V        | 24V         | 36V         |
|---|------------|------------|-------------|-------------|
| <span style="background-color: red; color: white; padding: 2px 5px;">R</span> <span style="background-color: yellow; color: black; padding: 2px 5px;">Y</span> <span style="background-color: orange; color: black; padding: 2px 5px;">O</span> | 210Ω, 1/4W | 510Ω, 1/4W | 1,2KΩ, 1/4W | 2,2KΩ, 1/4W |
| <span style="background-color: green; color: white; padding: 2px 5px;">G</span> <span style="background-color: blue; color: white; padding: 2px 5px;">B</span> <span style="background-color: grey; color: white; padding: 2px 5px;">W</span>   | 160Ω, 1/4W | 470Ω, 1/4W | 1,2KΩ, 1/4W | 2,2KΩ, 1/4W |

| Formula |                       |
|---------|-----------------------|
| R=      | $\frac{U - U_e}{I_e}$ |

## 19MM Anti-Vandal-Switch

Part No.: **Q35126**

|       |        |       |        |         |        |            |           |       |            |
|-------|--------|-------|--------|---------|--------|------------|-----------|-------|------------|
| DRW:  | Jason  | CHKD: | Wilson | MATL:   | Wilson | TOLERANCE: | Mason     | DATE: | 11.06.2019 |
| APPD: | Schumi |       |        | FINISH: | Jamy   |            | Sheet No. |       | 1 from 3   |

[www.edcon-components.com](http://www.edcon-components.com)

email: [info@edcon-components.com](mailto:info@edcon-components.com)

# EDCON-COMPONENTS



## Visual Effect of Surface



Nickel - plated brass  
( Satin surface)



Stainless steel (Spiral surface)



Gold - plated brass (Satin surface)

**19MM Anti-Vandal-Switch**

Part No.: **Q35126**

|       |        |      |        |        |        |           |           |          |            |
|-------|--------|------|--------|--------|--------|-----------|-----------|----------|------------|
| DRW:  | Jason  | CHKD | Wilson | MATL:  | Wilson | TOLERANCE | Mason     | DATE     | 11.06.2019 |
| APPD: | Schumi |      |        | FINISH | Jamy   |           | Sheet No. | 2 from 3 |            |

Customer:

# EDCON-COMPONENTS



## Ordering Informations

| Serie  | Front Shape | Contact Structure | Lamp Type | Connect Type | Lamp Color | Lamp Voltage | Crust Material | Engraving Options | ROHS       | Packing Style           |
|--|-------------|-------------------|-----------|--------------|------------|--------------|----------------|-------------------|------------|-------------------------|
| Q35126   | F           | 11                | C         | 2            | A          | 0            | S              | 00                | R          | N                       |
| <div><div><div><div><div>F= Flat</div><div></div></div><div><div>11= 1NO1NC Momentary</div><div></div></div><div><div>22= 2NO2NC Momentary</div><div></div></div><div><div>33= 1NO1NC Latching function</div><div></div></div><div><div>44= 2NO2NC Latching function</div><div></div></div></div><div><div></div><div></div><div>C=Character-illuminated</div></div><div><div>A= No Function</div><div>R= Red</div><div>G= Green</div><div>Y= Yellow</div><div>O= Orange</div><div>B= Blue</div><div>W= White</div></div><div><div>0= with 0R Resistor before LED</div><div></div><div>1= 6V AC/DC</div><div>2= 12V AC/DC</div><div>3= 24V AC/DC</div><div>4= 36V AC/DC</div><div>5= 48V AC/DC</div><div>6= 110V AC/DC</div><div>7= 230V AC/DC</div><div>X= can we make by order</div></div><div><div>S= Stainless Steel</div><div>N= Nickel Plated Brass</div><div>G= Gold Plated Brass</div><div></div><div></div></div><div><div>00= No function</div><div></div><div></div></div><div><div>R= ROHS Conform</div><div>N= NON ROHS Conform</div><div>I= Individual Packing</div></div></div></div> |             |                   |           |              |            |              |                |                   |            |                         |
|  |             |                   |           |              |            |              |                |                   |            | ss                      |
|  |             |                   |           |              |            |              |                |                   |            | 19MM Anti-Vandal-Switch |
|  |             |                   |           |              |            |              |                |                   |            | Part No.: Q35126        |
| DRW:   | Jason       | CHKD              | Wilson    | MATL:        | Wilson     | TOLERANCE    | Mason          | DATE              | 11.06.2019 | Customer:               |
| APPD:  | Schumi      |                   |           | FINISH       | Jamy       |              | Sheet No.      |                   | 3 from 3   |                         |

[www.edcon-components.com](http://www.edcon-components.com)

email: [info@edcon-components.com](mailto:info@edcon-components.com)