

# EDCON-COMPONENTS

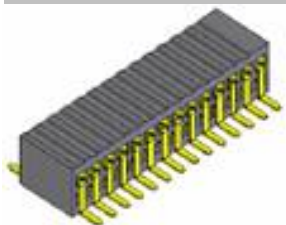

## Specifications

Current Rating:	1 Ampere
Insulator Resistance:	1000 Megaohm min.
Contact Resistance	20m Ohm max.
Dielectric Withstanding:	AC 500V
Operating Temperature:	.-40°C to +125°C
Contact Material:	Copper Alloy
Insulator Material:	thermoplastic, UL 94V-0
Standard:	Dual contact
Contact Plating:	Tin, Gold or Selective Plated
Standard:	Gold Flash Overall
Mating Pin:	0,40mm square pins

## P.C.B Layout

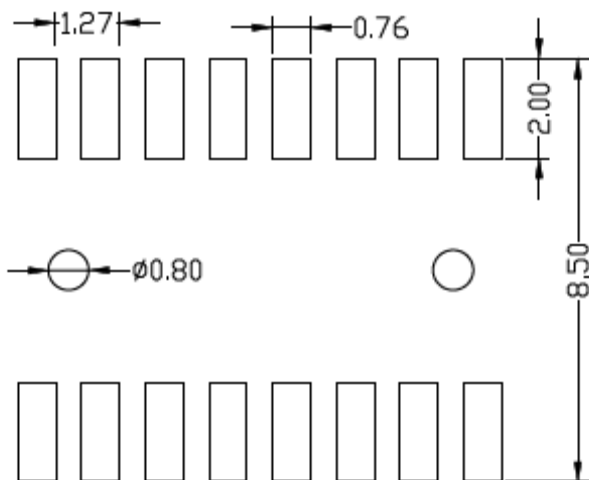

## Drawing

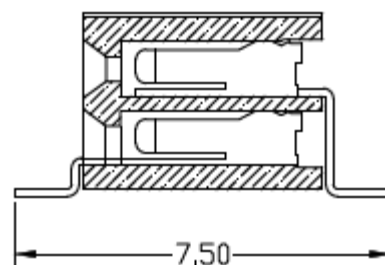

A-Type

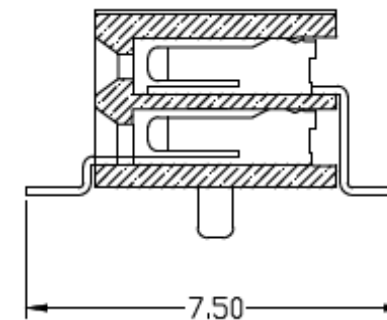

B-Type

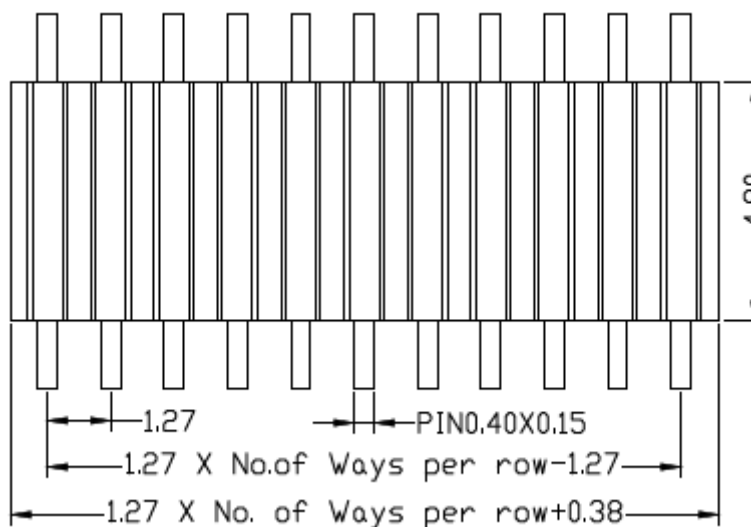

**Female Header Pitch**  
**1,27x1,27mm H=3,45mm**  
 Part No.: **T27C1037-**

DRW:	Jason	CHKD	Wilson	MATL:	Wilson	TOLERANCE	Mason	DATE	18.11.2016
APPD:	Schumi			FINISH	Jamy		Sheet No.	1 from 4	Customer:

# EDCON-COMPONENTS

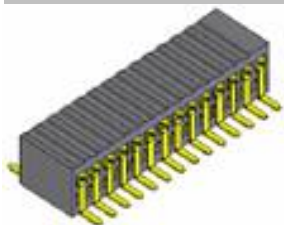

## Pin Code length table free configuration

Order Code	Dimension (mm)			
	W			
A01	7,50			
A02				
A03				
A04				
A05				
A06				
A07				
A08				
A09				
A10				
A11				
A12				
A13				
A14				
A15				
A16				
A17				
A18				
A19				
A20				
A21				
A22				

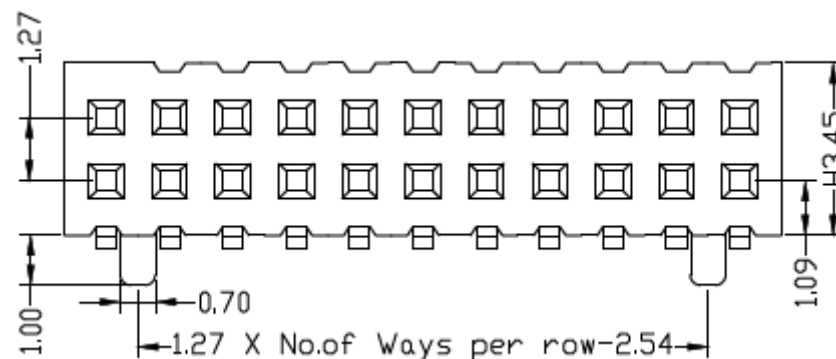

<b>Female Header Pitch 1,27x1,27mm H=3,45mm</b>	
Part No.:	<b>T27C1037-</b>
Customer:	

DRW:	Jason	CHKD	Wilson	MATL:	Wilson	TOLERANCE	Mason	DATE	18.11.2016
APPD:	Schumi			FINISH	Jamy		Sheet No.	2 from 4	

# EDCON-COMPONENTS

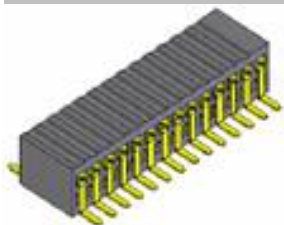

## Ordering Informations

Serie	No. of Pos.	Construction	Contact Plating	Material	Locating Peg	Pin Length Code	ROHS	Packing		
<b>T27C1037-</b>	<b>XX</b>	<b>RS</b>	<b>G0</b>	<b>P6</b>	<b>Y</b>	<b>A01</b>	<b>R</b>	<b>TC</b>		

<b>04 ~ 100Pos.</b>	<b>RS=</b> Right angle SMD	<b>G0=</b> Gold Flash (Standard)	<b>P6=</b> PA6T	<b>Y=</b> Yes	look Table No. 1	<b>N=</b> NO ROHS conform	<b>BU=</b> Bulk (Standard)
		<b>T0=</b> Tin plated	<b>LC=</b> LCP	<b>N=</b> No		<b>R=</b> ROHS conform	<b>TU=</b> Tube w/o Cap
		<b>GA=</b> 10µ Gold Plating	<b>P4=</b> PA-46				<b>TC=</b> Tube w. pic and Place Cap/Foil
		<b>GB=</b> 15µ Gold Plating					<b>TY=</b> Tray packing w/o Cap
		<b>GC=</b> 20µ Gold Plating					<b>TR=</b>
		<b>S0=</b> Selectiv Plating Gold Flash / Tin					Tape/Reel w. pic and Place Cap

**Female Header Pitch**  
**1,27x1,27mm H=3,45mm**  
 Part No.: **T27C1037-**

DRW:	Jason	CHKD	Wilson	MATL:	Wilson	TOLERANCE	Mason	DATE	18.11.2016
APPD:	Schumi			FINISH	Jamy		Sheet No.		3 from 4

Customer:

# EDCON-COMPONENTS

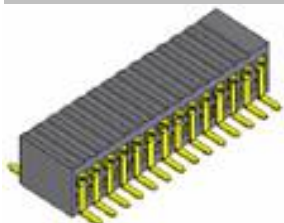

## Soldering Profile for Lead Soldering ( P.B.T. )

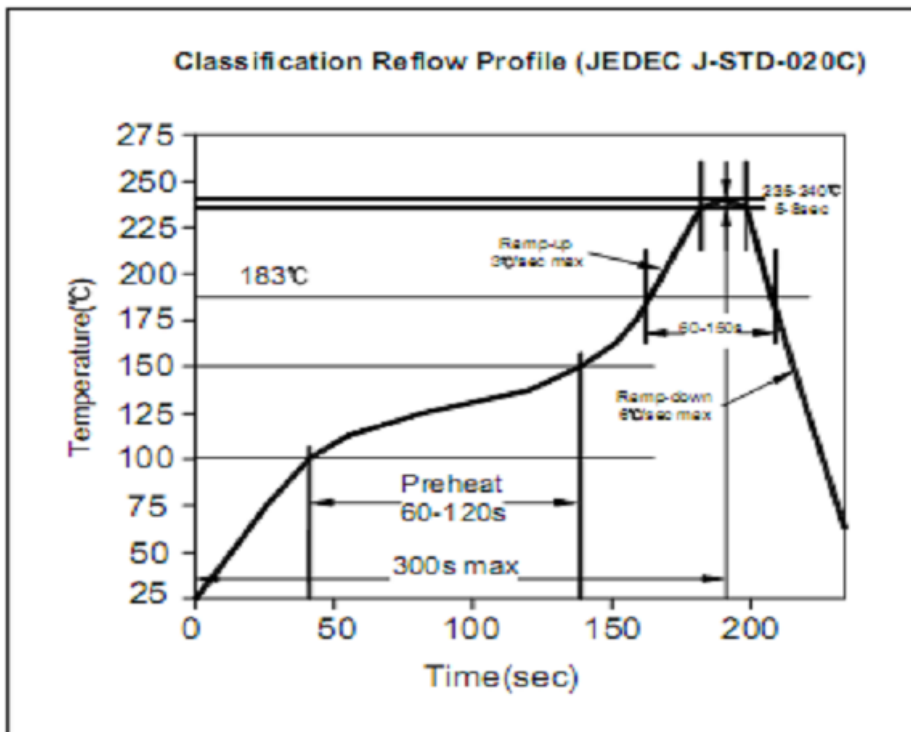

## Soldering Profile for Lead Free Soldering ( Nylon 6T )

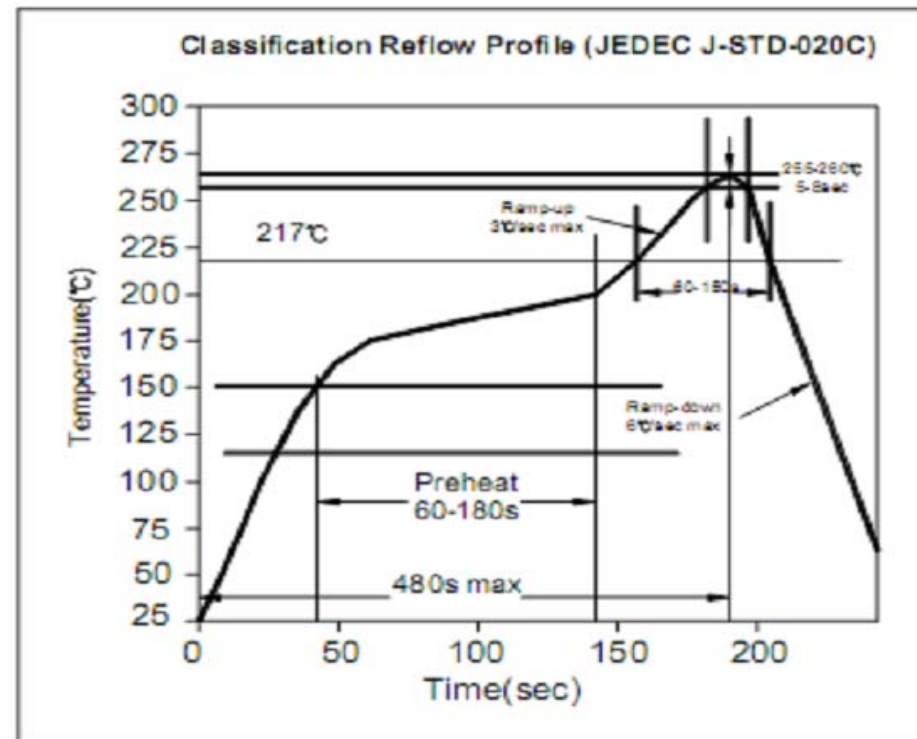

**Female Header Pitch  
1,27x1,27mm H=3,45mm**

Part No.: **T27C1037-**

DRW:	Jason	CHKD	Wilson	MATL:	Wilson	TOLERANCE	Mason	DATE	18.11.2016
APPD:	Schumi			FINISH	Jamy		Sheet No.	4 from 4	Customer:

[www.edcon-components.com](http://www.edcon-components.com)

email: [info@edcon-components.com](mailto:info@edcon-components.com)