

# EDCON-COMPONENTS

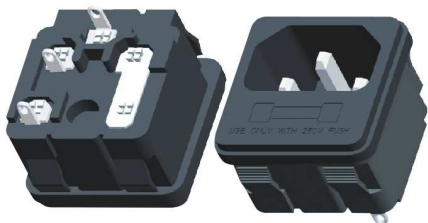

## Technical Description

Voltage Rating:	15A/250VAC T105
Approval	
Voltage Rating:	10A / 250VAC
Approval	
Insulation Resistance:	1000MΩ (min) 500VDC
Dielectric withstand Voltage:	2500VAC 5s between Terminals 50~60Hz
Dielectric withstand Voltage:	3750VAC between Terminals to Base 50~60Hz
Insert & Extract Force:	1,36Kg - 6,8Kgf
Leakage Current:	1mA
Terminal Strength:	≥ 80N
Operating Life:	≥ 5000 cycles

## Drawing

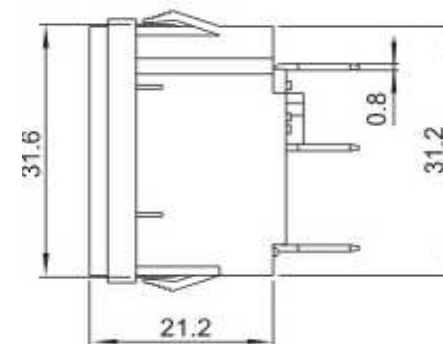
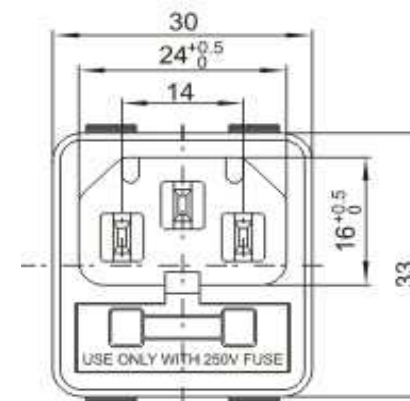
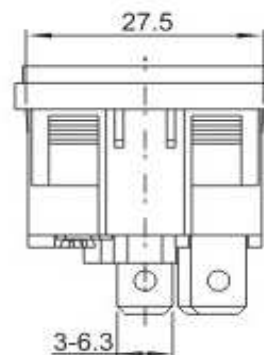

### Panel Cutout

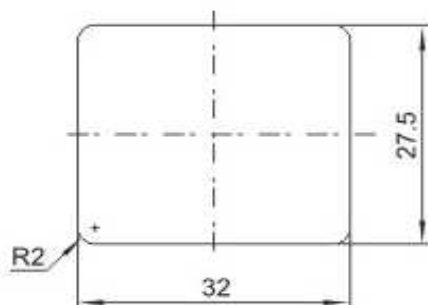

### Connecting Terminal Code



A



B



C



D

### European AC-Power Connector

Part No.: **T11053**

Customer:

DRW:	Jason	CHKD	Wilson	MATL:	Wilson	TOLERANCE	Mason	DATE	09.08.2016
APPD:	Schumi			FINISH	Jamy		Sheet No.	1 from 2	

# EDCON-COMPONENTS

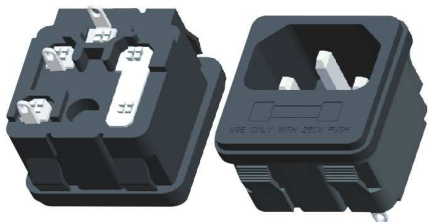

## Ordering Informations

Serie	Body Colour	Panel Thickness A	PCB Layout Type	Connecting Terminal	Special function	Special function	ROHS	Packing		
-------	-------------	-------------------	-----------------	---------------------	------------------	------------------	------	---------	--	--

<b>T11053</b>	-	<b>BK</b>	<b>N</b>	<b>A</b>	<b>N</b>	<b>N</b>	<b>N</b>	<b>R</b>	<b>BU</b>	
---------------	---	-----------	----------	----------	----------	----------	----------	----------	-----------	--

<b>BK= Black</b>	<b>N= No function</b>	<b>N= No function</b>	<b>A= Solder Lug Terminal</b>	<b>N= No function</b>	<b>N= No function</b>	<b>R= ROHS Conform</b>	<b>BU= Bulk-Ware</b>
<b>WH= White</b>	<b>A= 0,8mm</b>		<b>B= Flat- Term 4,8mm</b>				<b>IV= Individual Package</b>
<b>RD= Red</b>	<b>B=1,0mm</b>		<b>C= Flat- Term 6,2mm</b>				
<b>YE= Yellow</b>	<b>C= 1,5mm</b>		<b>D= Flat- Term 4,0mm</b>				
<b>GN= Green</b>	<b>D= 2,0mm</b>						
<b>BL= Blue</b>	<b>E= 2,5mm</b>						
	<b>F= 1,2mm</b>						

<b>European AC-Power Connector</b>	
Part No.:	<b>T11053</b>
Customer:	

DRW:	Jason	CHKD	Wilson	MATL:	Wilson	TOLERANCE	Mason	DATE	09.08.2016
APPD:	Schumi			FINISH	Jamy		Sheet No.	2 from 2	