

# EDCON-COMPONENTS

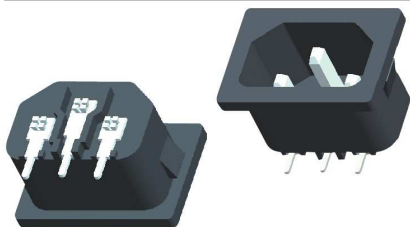

## Technical Description

Voltage Rating:	15A/250VAC T105
Approval	
Voltage Rating:	10A / 250VAC
Approval	
Insulation Resistance:	1000MΩ (min) 500VDC
Dielectric withstand Voltage:	2500VAC 5s between Terminals 50~60Hz
Dielectric withstand Voltage:	3750VAC between Terminals to Base 50~60Hz
Insert & Extract Force:	1,36Kg - 6,8Kgf
Leakage Current:	1mA
Terminal Strength:	≥ 80N
Operating Life:	≥ 5000 cycles

## Drawing

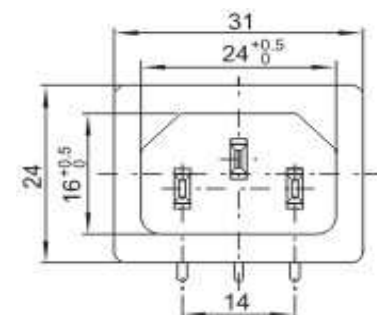
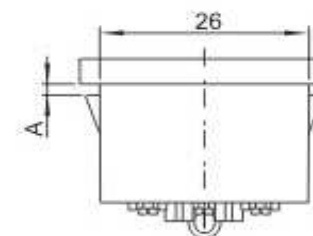
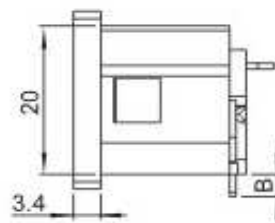

Panel Cutout

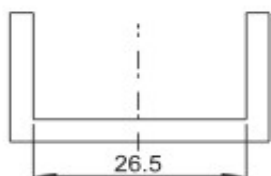

PCB Layout

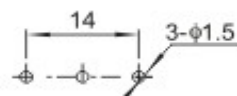

Type A

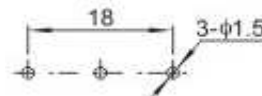

Type B

### European AC-Power Connector

Part No.: **T11046**

DRW:	Jason	CHKD	Wilson	MATL:	Wilson	TOLERANCE	Mason	DATE	04.08.2016
APPD:	Schumi			FINISH	Jamy		Sheet No.	1 from 2	Customer:

# EDCON-COMPONENTS

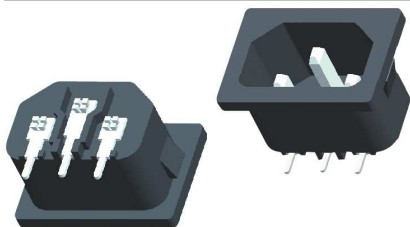

## Ordering Informations

Serie	Body Colour	Panel Thickness A	PCB Layout Type	Connecting Terminal	Dimension B	Special function	ROHS	Packing		
-------	-------------	-------------------	-----------------	---------------------	-------------	------------------	------	---------	--	--

<b>T11046</b>	<b>BK</b>	<b>N</b>	<b>A</b>	<b>N</b>	<b>A</b>	<b>N</b>	<b>R</b>	<b>BU</b>		
---------------	-----------	----------	----------	----------	----------	----------	----------	-----------	--	--

<b>BK= Black</b>	<b>N= No function</b>	<b>A= 14mm</b>	<b>N= No function</b>	<b>A= 3,5mm</b>	<b>N= No function</b>	<b>R= ROHS Conform</b>	<b>BU= Bulk-Ware</b>
<b>WH= White</b>	<b>A= 0,8mm</b>	<b>B= 18mm</b>		<b>B= 5,0mm</b>			
<b>RD= Red</b>	<b>B=1,0mm</b>			<b>C= 10,5mm</b>			<b>IV= Individual Package</b>
<b>YE= Yellow</b>	<b>C= 1,5mm</b>						
<b>GN= Green</b>	<b>D= 2,0mm</b>						
<b>BL= Blue</b>							

**European AC-Power Connector**

Part No.: **T11046**

DRW:	Jason	CHKD	Wilson	MATL:	Wilson	TOLERANCE	Mason	DATE	04.08.2016
APPD:	Schumi			FINISH	Jamy		Sheet No.	2 from 2	Customer:

[www.edcon-components.com](http://www.edcon-components.com)

email: [info@edcon-components.com](mailto:info@edcon-components.com)