

EDCON-COMPONENTS



Technical Discription

Voltage Rating:	15A/250VAC T105
Approval	
Voltage Rating:	10A / 250VAC
Approval	
Insulation Resistance:	1000MΩ (min) 500VDC
Dielectric withstand Voltage:	2500VAC 5s between Terminals 50~60Hz
Dielectric withstand Voltage:	3750VAC between Terminals to Base 50~60Hz
Insert & Extract Force:	1,36Kg - 6,8Kgf
Leackage Current:	1mA
Termnial Strength:	≥ 80N
Operating Life:	≥ 5000 cycles

Drawing

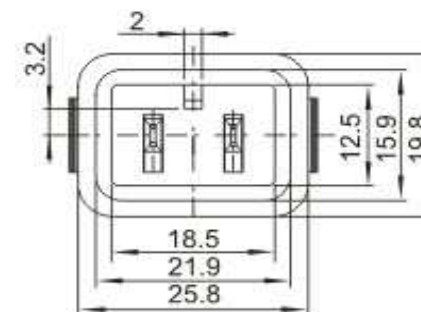
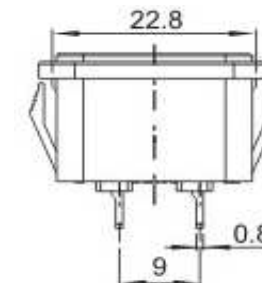
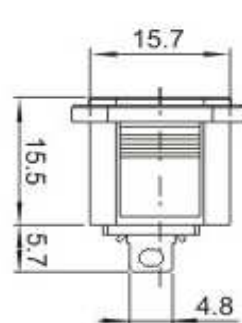

Panel Cutout

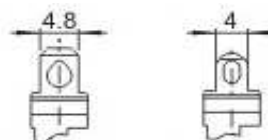
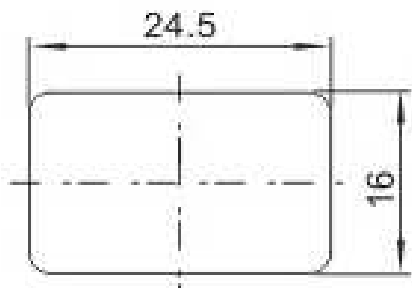

Type A	Type B
--------	--------

European AC-Power Connector	
Part No.:	T11040
Customer:	

DRW:	Jason	CHKD	Wilson	MATL:	Wilson	TOLERANCE	Mason	DATE	04.08.2016
APPD:	Schumi			FINISH	Jamy		Sheet No.		1 from 2

EDCON-COMPONENTS



Ordering Informations

Serie	Body Colour	Panel Thickness A	Dimension D	Connecting Terminal	Spezial Function	Spezial Function	ROHS	Packing		
-------	-------------	-------------------	-------------	---------------------	------------------	------------------	------	---------	--	--

T11040	-	BK	B	N	A	N	N	R	BU	
---------------	---	-----------	----------	----------	----------	----------	----------	----------	-----------	--

BK= Black		N= No function	A= 4,8mm Terminal	N= No function	N= No function	R= ROHS Conform	BU= Bulk-Ware
WH= White			B= Solder Lug Terminal				IV= Individual Package
RD= Red	B= 1,0mm						
YE= Yellow	C= 1,5mm						
GN= Green	D= 2,0mm						
BL= Blue	E= 3,0mm						

European AC-Power Connector

Part No.: **T11040**

DRW:	Jason	CHKD	Wilson	MATL:	Wilson	TOLERANCE	Mason	DATE	04.08.2016
APPD:	Schumi			FINISH	Jamy		Sheet No.	2 from 2	Customer:

www.edcon-components.com

email: info@edcon-components.com