



DATA SHEET

SMD Battery Holder Type AA Two Cell

Serie: B45007

SMD Battery Holder Type AA Two Cell	
Serie No.:	B45007
Customer:	

DRW:	Jason	CHKD	Wilson	MATL:	Wilson	TOLERANCE	Mason	DATE	23.12.2015
APPD:	Schumi			FINISH	Jamy			Sheet No.	1 from 5

EDCON-COMPONENTS

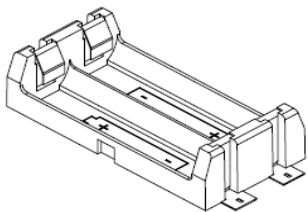

Technical Description

Type:	One Cell
Material Base:	Heat Resistance Nylon (UL94V-0) or Stanyl 46 or Equivalent
Contact Material:	Stainless Steel .012 / (0,30mm)
Contact Plating:	Gold Flash over Nickel plated
Polarisation Peg:	Yes

Technical Drawing

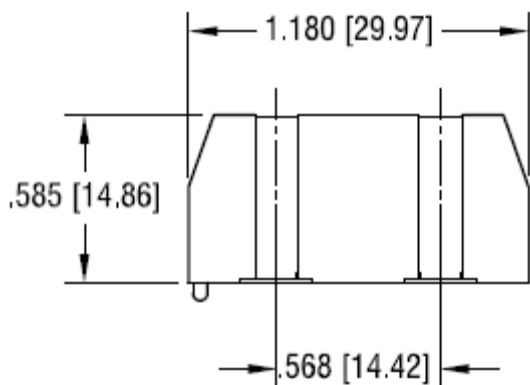
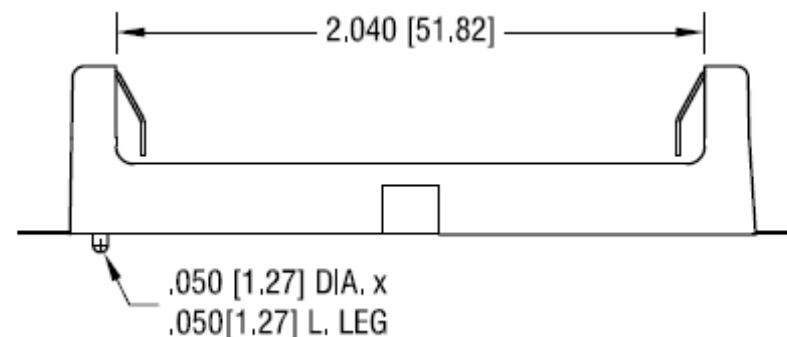

**SMD Battery Holder Type AA
Two Cell**

Part No.: **B45007**

DRW:	Jason	CHKD	Wilson	MATL:	Wilson	TOLERANCE	Mason	DATE	23.12.2015	Customer:
APPD:	Schumi			FINISH	Jamy		Sheet No.	2 from 5		

EDCON-COMPONENTS

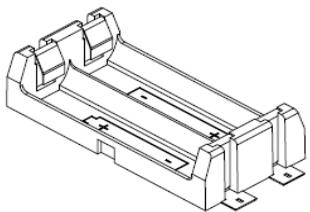

Technical Drawing

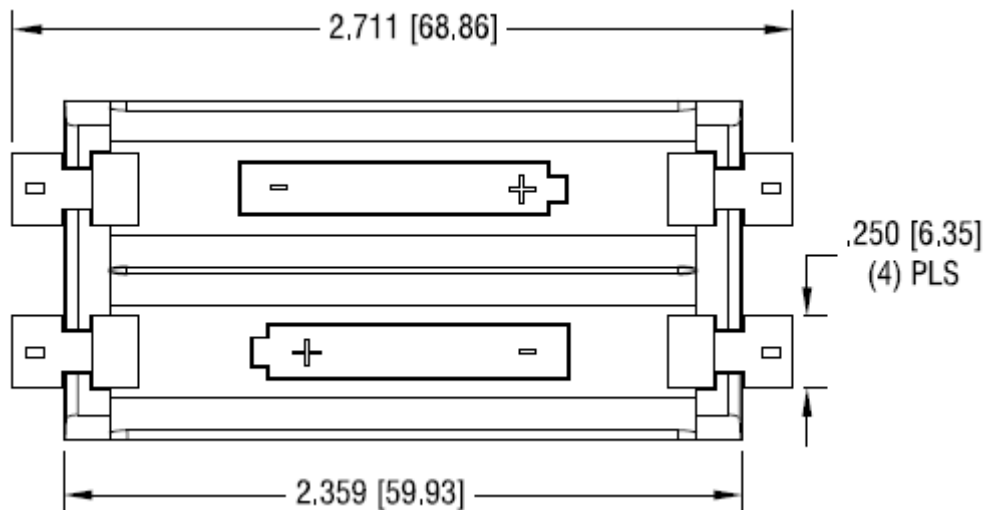

PCB Layout

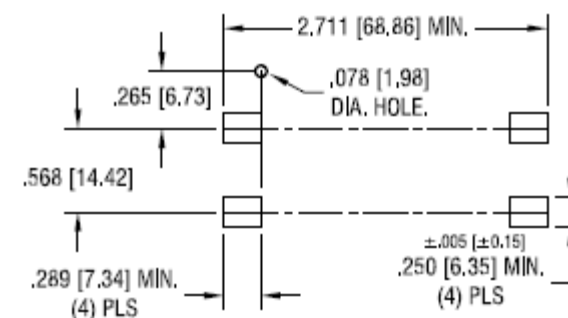

**SMD Battery Holder Type AA
Two Cell**

Part No.: **B45007**

DRW:	Jason	CHKD	Wilson	MATL:	Wilson	TOLERANCE	Mason	DATE	23.12.2015
APPD:	Schumi			FINISH	Jamy		Sheet No.		3 from 5

Customer:

www.edcon-components.com

email: info@edcon-components.com

EDCON-COMPONENTS

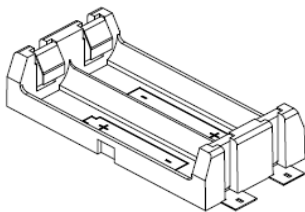

Ordering Informations

Customer	Number of Cell	ROHS	Packing Code							
B45007	B	R	TY							

B= Two Cell	R= ROHS Conform	TY= Tray Package
	N= NON ROHS Conform	IV= Individuall Package

SMD Battery Holder Type AA Two Cell	
Part No.:	B45007
Customer:	

DRW:	Jason	CHKD	Wilson	MATL:	Wilson	TOLERANCE	Mason	DATE	23.12.2015
APPD:	Schumi			FINISH	Jamy		Sheet No.		4 from 5

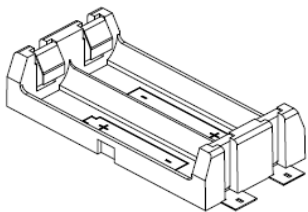

Soldering Profile Curve

Classification Reflow Profile (JEDEC J-STD-020C)

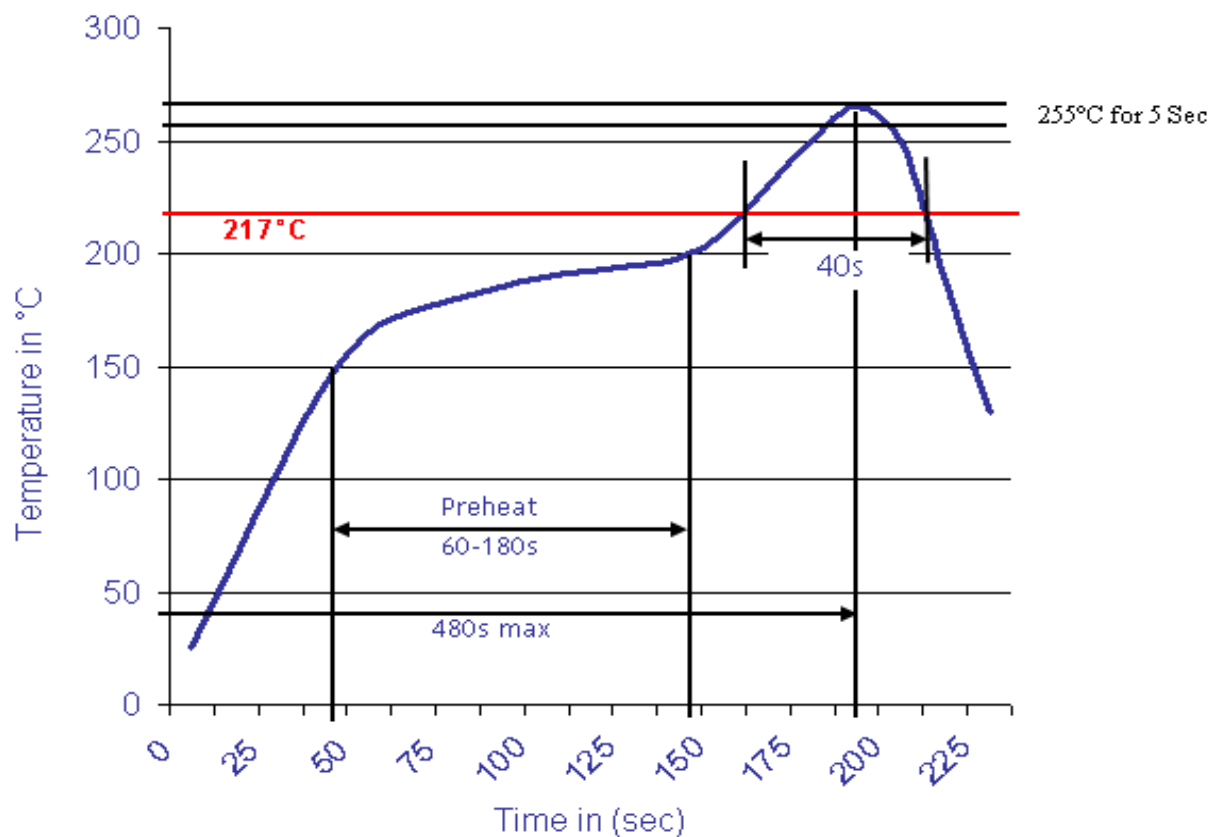

SMD Battery Holder Type AA Two Cell	
Part No.:	B45007
Customer:	

DRW:	Jason	CHKD	Wilson	MATL:	Wilson	TOLERANCE	Mason	DATE	23.12.2015
APPD:	Schumi			FINISH	Jamy		Sheet No.	5 from 5	