



# DATA SHEET

## SMD Battery Holder Type AA One Cell

### Serie: B45006

<b>SMD Battery Holder Type AA One Cell</b>	
Serie No.:	<b>B45006</b>
Customer:	

DRW:	Jason	CHKD	Wilson	MATL:	Wilson	TOLERANCE	Mason	DATE	23.12.2015
APPD:	Schumi			FINISH	Jamy			Sheet No.	1 from 5

# EDCON-COMPONENTS

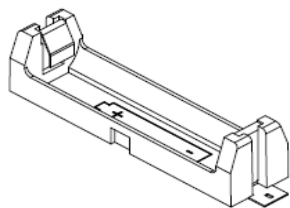

## Technical Description

Type: One Cell  
 Material Base: Heat Resistance Nylon ( UL94V-0)  
 or Stanyl 46 or Equivalent  
 Contact Material: Stainless Steel .012 / (0,30mm)  
 Contact Plating: Gold Flash over Nickel plated  
 Polarisation Peg: Yes

## Technical Drawing

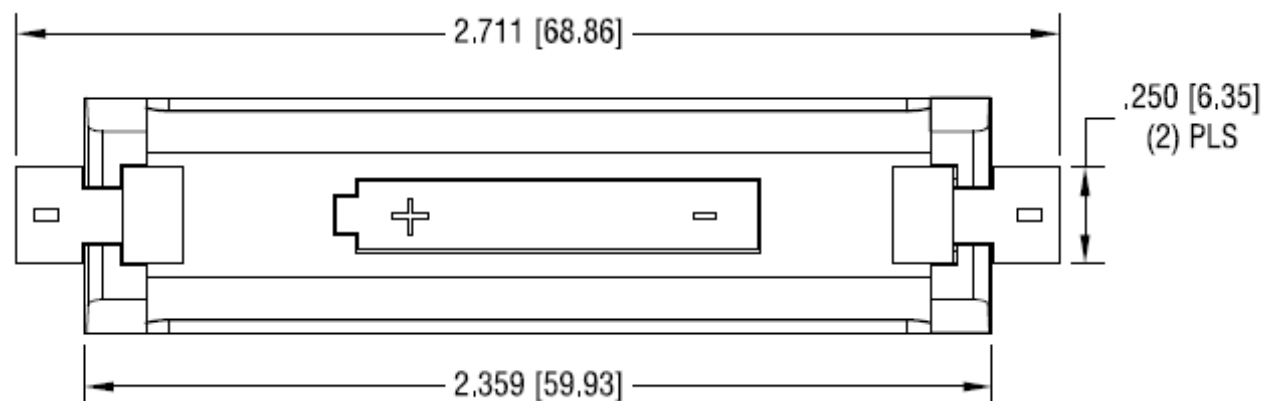
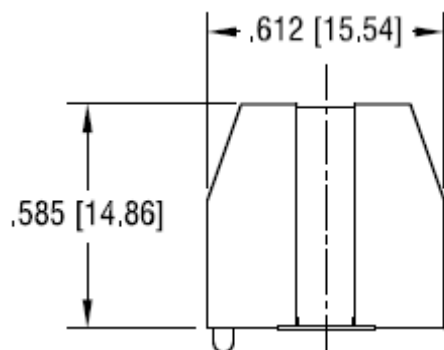

**SMD Battery Holder Type AA  
 One Cell**

Part No.: **B45006**

DRW:	Jason	CHKD	Wilson	MATL:	Wilson	TOLERANCE	Mason	DATE	23.12.2015
APPD:	Schumi			FINISH	Jamy		Sheet No.		2 from 5

Customer:

# EDCON-COMPONENTS

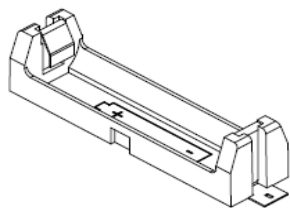

Technical Drawing

PCB Layout

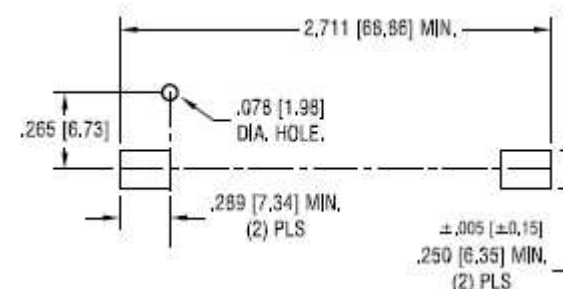
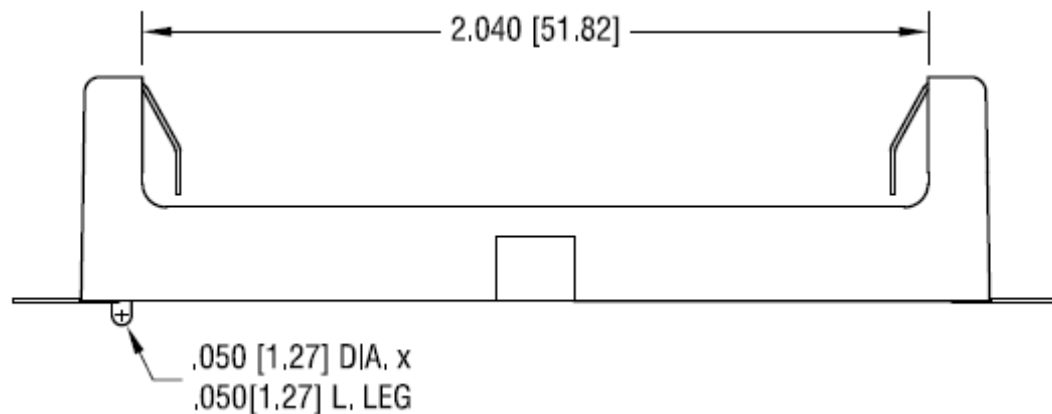

<b>SMD Battery Holder Type AA One Cell</b>	
Part No.:	<b>B45006</b>
Customer:	

DRW:	Jason	CHKD	Wilson	MATL:	Wilson	TOLERANCE	Mason	DATE	23.12.2015
APPD:	Schumi			FINISH	Jamy		Sheet No.		3 from 5

[www.edcon-components.com](http://www.edcon-components.com)

email: [info@edcon-components.com](mailto:info@edcon-components.com)

# EDCON-COMPONENTS

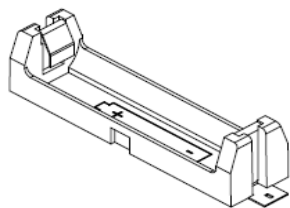

## Ordering Informations

Customer	Number of Cell	ROHS	Packing Code							
<b>B45006</b>	<b>A</b>	<b>R</b>	<b>TY</b>							

<b>A=</b> One Cell	<b>R=</b> ROHS Conform	<b>TY=</b> Tray Package
	<b>N=</b> NON ROHS Conform	<b>IV=</b> Individuall Package

<b>SMD Battery Holder Type AA One Cell</b>	
Part No.:	<b>B45006</b>
Customer:	

DRW:	Jason	CHKD	Wilson	MATL:	Wilson	TOLERANCE	Mason	DATE	23.12.2015
APPD:	Schumi			FINISH	Jamy		Sheet No.		4 from 5

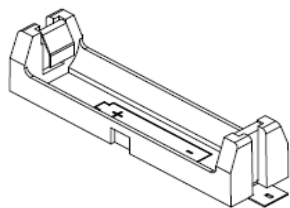

Soldering Profile Curve

Classification Reflow Profile (JEDEC J-STD-020C)

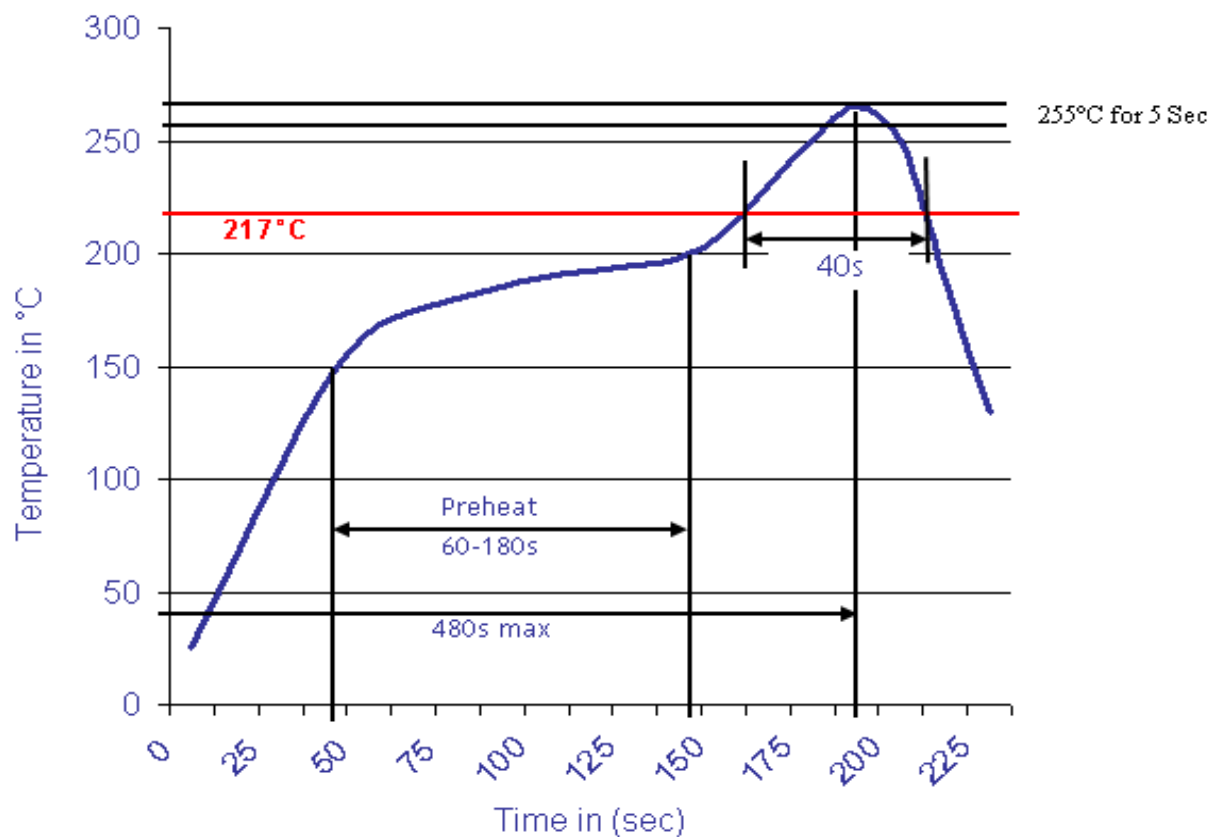

<b>SMD Battery Holder Type AA One Cell</b>	
Part No.:	<b>B45006</b>
Customer:	

DRW:	Jason	CHKD	Wilson	MATL:	Wilson	TOLERANCE	Mason	DATE	23.12.2015
APPD:	Schumi			FINISH	Jamy		Sheet No.	5 from 5	









