



# DATA SHEET

## PCB Batteryholder for 3PCS 18650 CELL

### Serie: B44005

**PCB Batteryholder for  
3PCS 18650 CELL**

Serie No.: **B44005**

DRW:	Jason	CHKD	Wilson	MATL:	Wilson	TOLERANCE	Mason	DATE	26.08.2019	Customer:
APPD:	Schumi			FINISH	Jamy		Sheet No.	1 from 5		



**Technical Description**

Connecting Type: PCB-Solder Pin  
 Base Material: ABS, Resin  
 Base Colour: Black  
 Flammability Rating: UL94HB or Custom Made  
 Contact: 304 Stainless Steel Spring, Nickel Plated  
 Dielectric Strength: 560 Volts /Mil. At 25°C for 5 Sec  
 Weight : 13,8gr.  
 Output: 3,7VDC

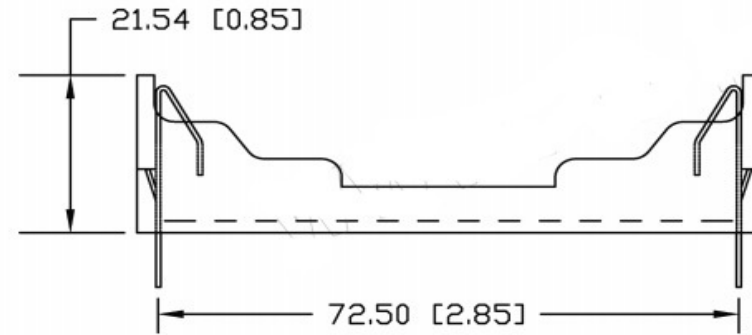
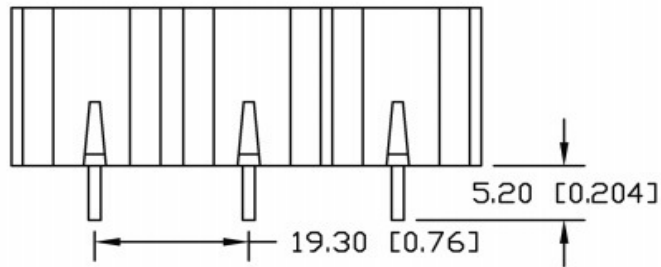

**PCB Batteryholder for  
3PCS 18650 CELL**

Part No.: **B44005**

DRW:	Jason	CHKD	Wilson	MATL:	Wilson	TOLERANCE	Mason	DATE	26.08.2019
APPD:	Schumi			FINISH	Jamy		Sheet No.	2 from 5	

Customer:

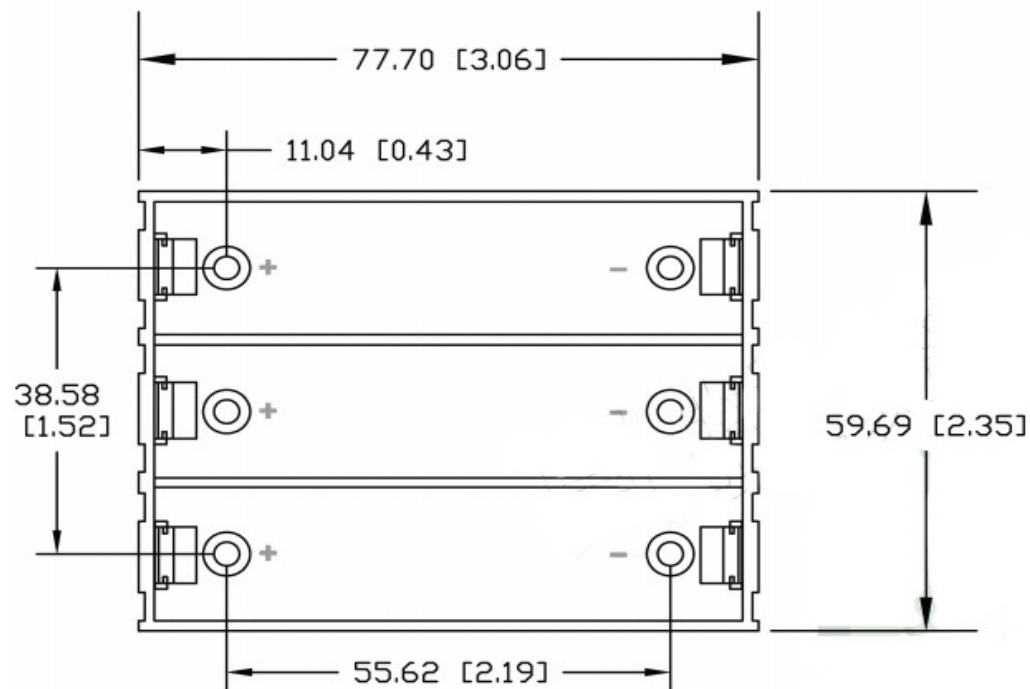
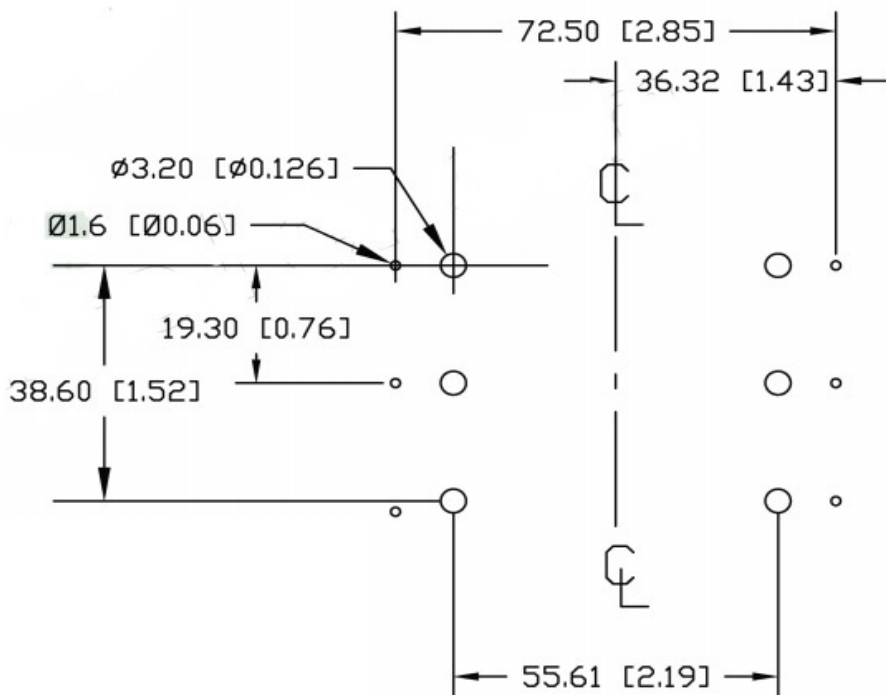

PCB-Layout

**PCB Batteryholder for  
3PCS 18650 CELL**

Part No.: **B44005**

DRW:	Jason	CHKD	Wilson	MATL:	Wilson	TOLERANCE	Mason	DATE	20.05.2014
APPD:	Schumi			FINISH	Jamy		Sheet No.	3 from 5	

Customer:

# EDCON-COMPONENTS



## Ordering Informations

Customer	Type of Holder	Special function	Special function	ROHS	Packing Code					
----------	----------------	------------------	------------------	------	--------------	--	--	--	--	--

<b>B44005</b>	<b>PC</b>	<b>N</b>	<b>N</b>	<b>R</b>	<b>TY</b>					
---------------	-----------	----------	----------	----------	-----------	--	--	--	--	--

<b>PC = PCB Solder Pin</b>			<b>R= ROHS Conform</b>	<b>TY= Tray Package</b>
	<b>N= No special function</b>	<b>N= No special function</b>	<b>N= NON ROHS Conform</b>	

<b>PCB Batteryholder for 3PCS 18650 CELL</b>	
Part No.:	<b>B44005</b>
Customer:	

DRW:	Jason	CHKD	Wilson	MATL:	Wilson	TOLERANCE	Mason	DATE	26.08.2019
APPD:	Schumi			FINISH	Jamy		Sheet No.		4 from 5



Soldering Profile Curve

Classification Reflow Profile (JEDEC J-STD-020C)

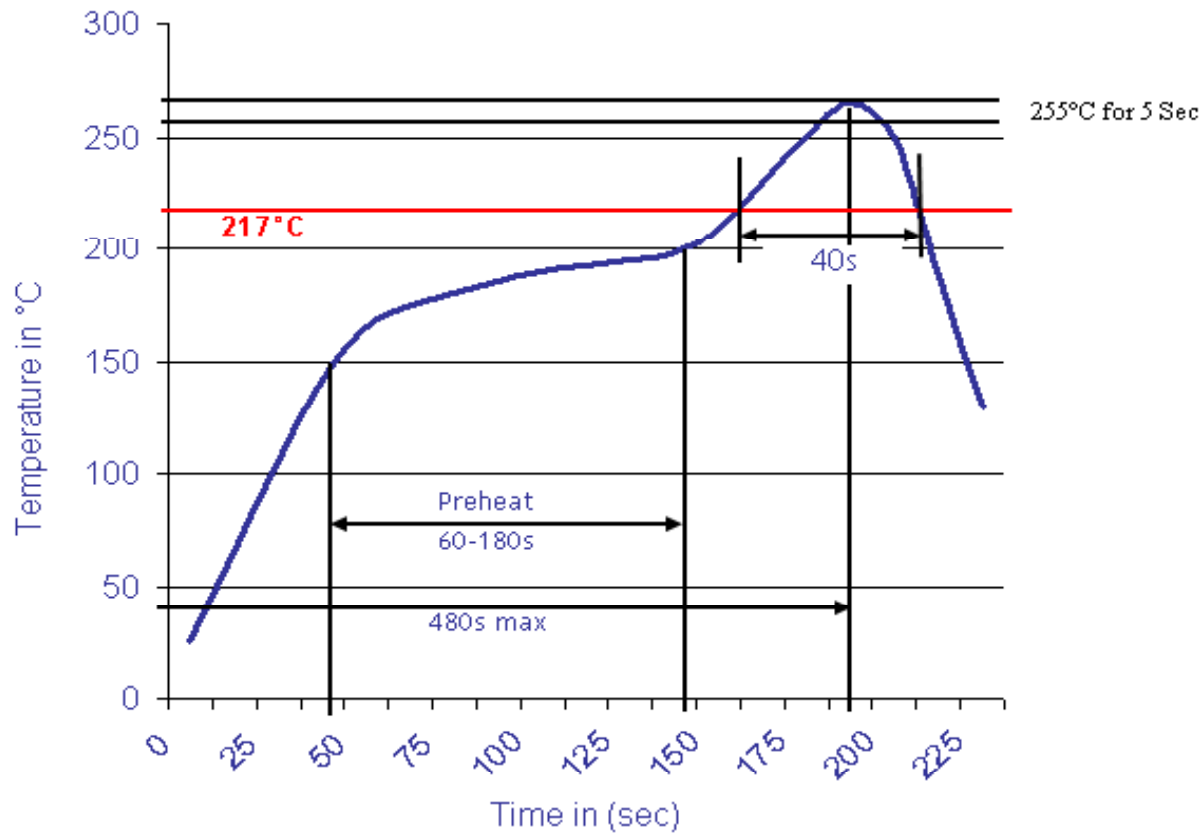

**PCB Batteryholder for  
3PCS 18650 CELL**

Part No.: **B44005**

DRW:	Jason	CHKD	Wilson	MATL:	Wilson	TOLERANCE	Mason	DATE	26.08.2019
APPD:	Schumi			FINISH	Jamy		Sheet No.	5 from 5	

Customer:









