

EDCON-COMPONENTS

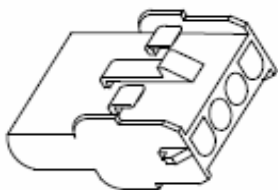

Technical Discription

Material: Nylon 66 UL94 V-2
No. of Positions: 1x4Pos.
Type of Housing: Plug
Current Rating: 13A AC/DC
Voltage Rating: 250V AC/DC
Temperature Range: -25°C ~ +85°C
Contact Resistance: Initial Value/10mΩ max.
After environmental testing: 20mΩ max.
Insulation Resistance: 1000MΩ min.
Withstanding Voltage: 1500V AC/minute
Applicable Wire: AWG16~20

Drawing

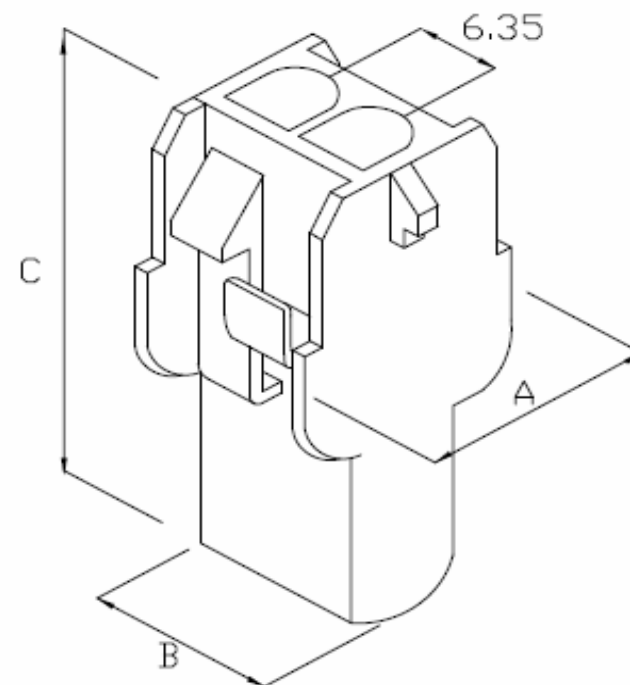
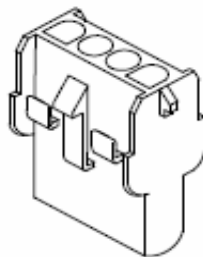

| Item-No. | | Dimension (mm) | | |
|----------|---------|----------------|------|------|
| | | A | B | C |
| T70S003 | 1Pos. | 9,6 | 7,5 | 27,7 |
| T70S004 | 2Pos. | 15,7 | 14,0 | 27,4 |
| T70S005 | 3Pos. | 15,7 | 20,3 | 27,4 |
| T70S006 | 4Pos. | 15,7 | 26,6 | 27,4 |
| T70S007 | 5Pos. | 15,7 | 33,0 | 27,4 |
| T70S008 | 2x3Pos. | 28,5 | 14,0 | 27,4 |
| T70S009 | 3x3Pos. | 28,5 | 20,3 | 27,6 |
| T70S010 | 3x4Pos. | 28,5 | 26,7 | 27,6 |
| T70S011 | 3x5Pos. | 28,5 | 33,0 | 27,6 |

**Wire to Wire Connector
Pitch 6,35mm**

Part No.: **T70S006**

| | | | | | | | | | |
|-------|--------|------|--------|--------|--------|-----------|-----------|------|------------|
| DRW: | Jason | CHKD | Wilson | MATL: | Wilson | TOLERANCE | Mason | DATE | 30.10.2010 |
| APPD: | Schumi | | | FINISH | Jamy | | Sheet No. | | 1 from 2 |

Customer:
email: info@edcon-components.com

EDCON-COMPONENTS

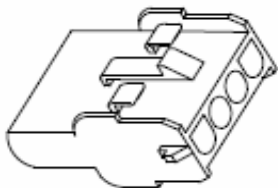

Ordering Informations

| Serie | ROHS | Packing | | | | |
|---------|------|---------|--|--|--|--|
| T70S006 | R | BU | | | | |

| | |
|---------------------|---------------|
| R= ROHS Conform | BU= Bulk-Ware |
| N= NON ROHS Conform | |

| | |
|--|----------------|
| Wire to Wire Connector Pitch 6,35mm | |
| Part No.: | T70S006 |
| Customer: | |

| | | | | | | | | | |
|-------|--------|------|--------|--------|--------|-----------|-----------|------|------------|
| DRW: | Jason | CHKD | Wilson | MATL: | Wilson | TOLERANCE | Mason | DATE | 30.10.2010 |
| APPD: | Schumi | | | FINISH | Jamy | | Sheet No. | | 2 from 2 |