

# EDCON-COMPONENTS

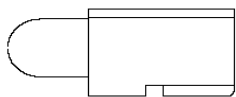

## Features

- Pre-Trimmed Leads for PC Mounting
- Can be assembled with each other
- I.C. compatible
- Black case enhances contrast ratio
- Wide Viewing angle
- High Reliability life measured in years
- Housing Material: PPA
- Package: 1000PCS/Reel
- High Temperature Resistant Housing
- High Class Transfer Temperature Epoxy

## Tape Specifications (mm)

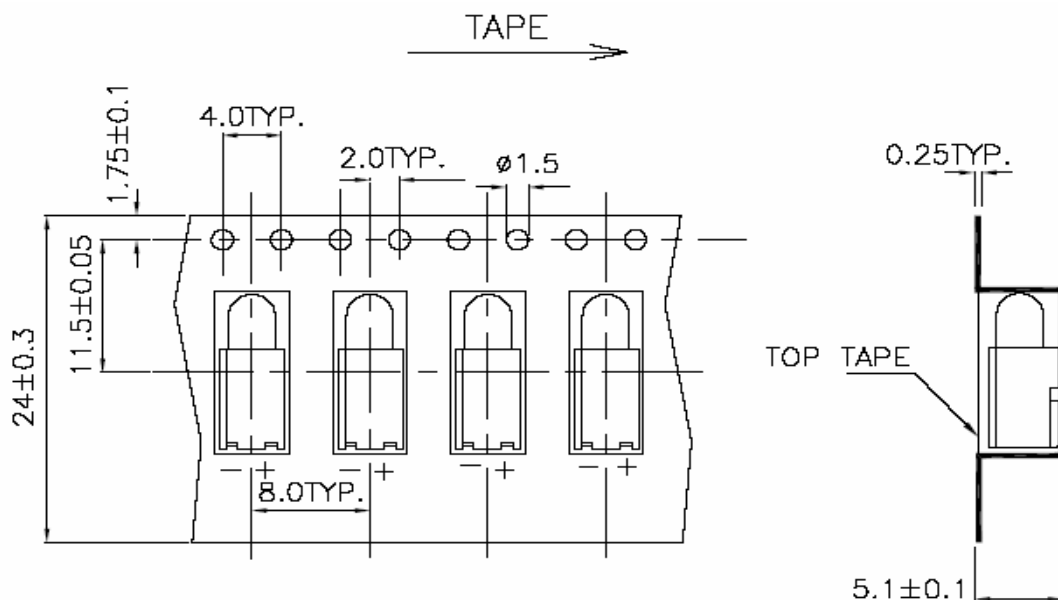

## P.C.B. Pad Dimensions

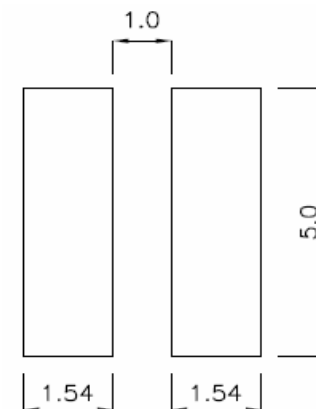

**SMD LED-HOLDER**

Part No.: **M19001**

Customer:

DRW:	Jason	CHKD	Wilson	MATL:	Wilson	TOLERANCE	Mason	DATE	20.09.2010
APPD:	Schumi			FINISH	Jamy		Sheet No.	1 from 4	

# EDCON-COMPONENTS

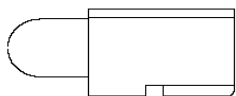

## Technical Drawing

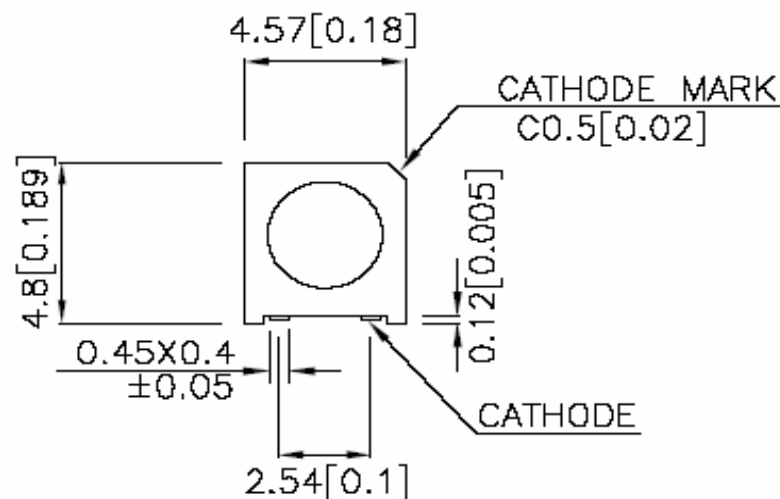
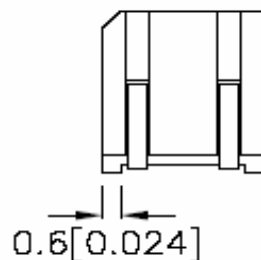
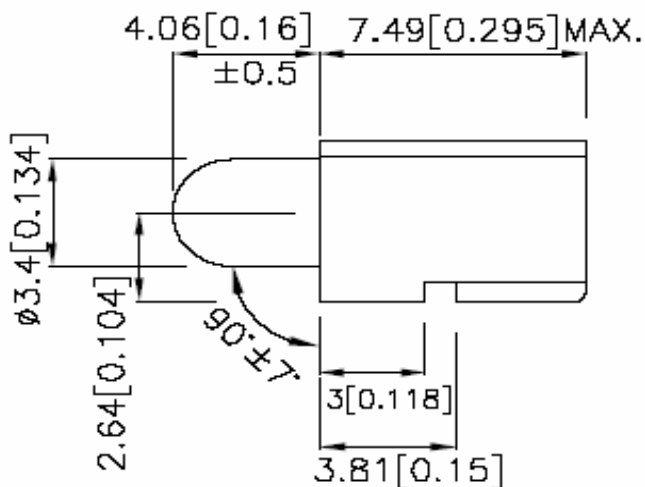

All Dimensions are in millimeters (inches)  
 Toleranced is 0,25 (0,01) unless otherwise noted  
 Specifications are subject to change without notice

<b>SMD LED-HOLDER</b>	
Part No.:	<b>M19001</b>
Customer:	

DRW:	Jason	CHKD	Wilson	MATL:	Wilson	TOLERANCE	Mason	DATE	20.09.2010
APPD:	Schumi			FINISH	Jamy		Sheet No.	2 from 4	

# EDCON-COMPONENTS

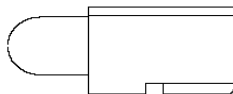

## Ordering Informations

Serie	Emitting Color	ROHS	Package						
<b>M19001</b>	<b>RD</b>	<b>R</b>	<b>TR</b>						

<b>RD=</b> Red	<b>R=</b> ROHS Conform	<b>TR=</b> Tape Reel
<b>GN=</b> Green	<b>N=</b> NON ROHS	
<b>YE=</b> Yellow		
<b>BL=</b> Blue		
<b>WH=</b> White		

LED Informations						
Emmiting Color of LED	Lens Type	Iv (mcd)		Wavelength (nm)	Viewing Angle	Test Conditions
		min	typ			
Red	diffused	25	60	660	60°	20mA
Green	diffused	8	15	565	60°	20mA
Yellow	diffused	25	45	590	60°	20mA
Blue	diffused	50	100	470	60°	20mA
White	diffused	100	200		60°	20mA

If special sorting is required (e.g. binning based on forward voltage, Luminous intensity luminous flux, or wavelength the typical accuracy of the sorting process is as follows.  
 Wavelength: +/- 2nm  
 Luminous intensity / luminous flux +/- 15%  
 Forward Voltage: +/- 0,1Volt

<b>SMD LED-HOLDER</b>	
Part No.:	<b>M19001</b>
Customer:	

DRW:	Jason	CHKD	Wilson	MATL:	Wilson	TOLERANCE	Mason	DATE	20.09.2010
APPD:	Schumi			FINISH	Jamy		Sheet No.		3 from 4

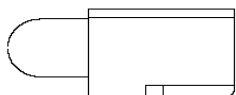

Soldering Profile Curve

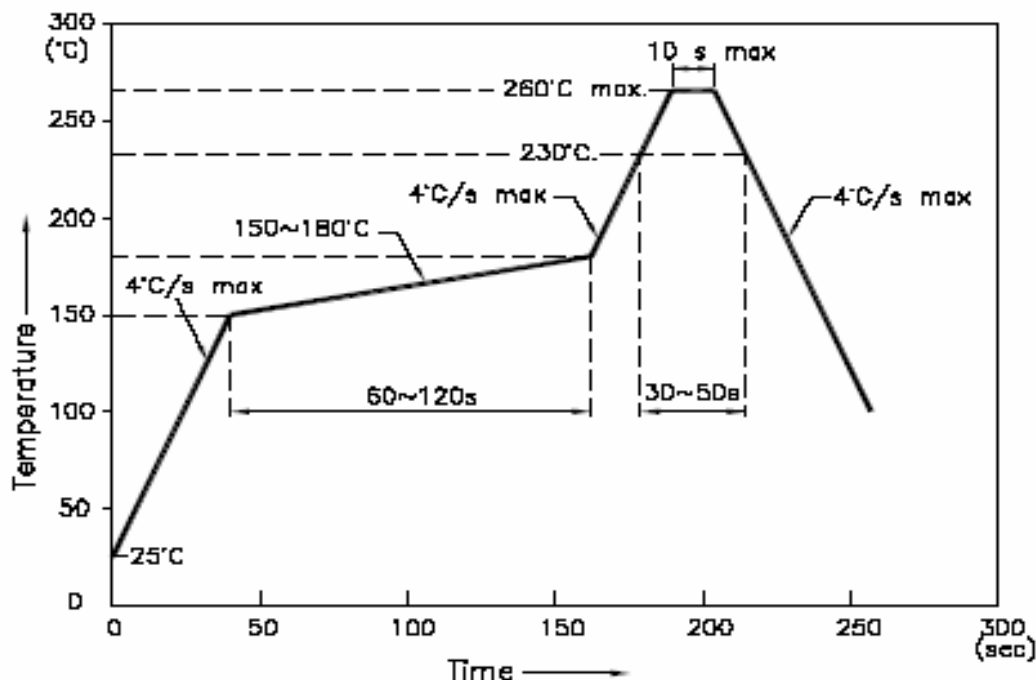

NOTES:

1. We recommend the reflow temperature 245°C(+/-5°C). The maximum soldering temperature should be limited to 260°C.
2. Don't cause stress to the epoxy resin while it is exposed to high temperature.
3. Number of reflow process shall be 2 times or less.

<b>SMD LED-HOLDER</b>	
Part No.:	<b>M19001</b>
Customer:	

DRW:	Jason	CHKD	Wilson	MATL:	Wilson	TOLERANCE	Mason	DATE	20.09.2010
APPD:	Schumi			FINISH	Jamy		Sheet No.	4 from 4	