

# EDCON-COMPONENTS

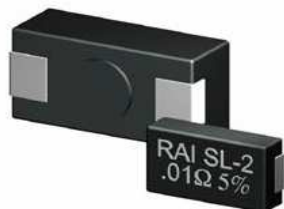

## Technical Description

Resistance Range 0,005 ~ 0,07Ω  
 Power 2Watt  
 Tolerance to ± 0,1%  
 Low Temperature Coefficient to ± 120ppm/K  
 Superior Surge Handling Capability  
 Reel Packaging  
 Non-Inductive Windings are available ( Type N)

## Specifications

Tolerances X57007: ± 0,1% to ±5%  
 Temperatur Coefficient: ±120ppm/K

Temperature Range: -55°C to +275°C  
 Dielectric Strength: 500VAC  
 Insulation Resistance: > 1000MΩ / Dry  
 Reel Width: X57007 = 24mm  
 Dielectric: ±0,5% + 0,05Ω  
 Load Life: ±1% + 0,05Ω  
 Storage: ±0,5% + 0,05Ω  
 Moisture Resistance: ±1% + 0,05Ω  
 Thermal Shock: ±0,5% + 0,05Ω  
 5x Overload (5s): ±0,5% + 0,05Ω  
 Shock: ±0,5% + 0,05Ω

## Drawing

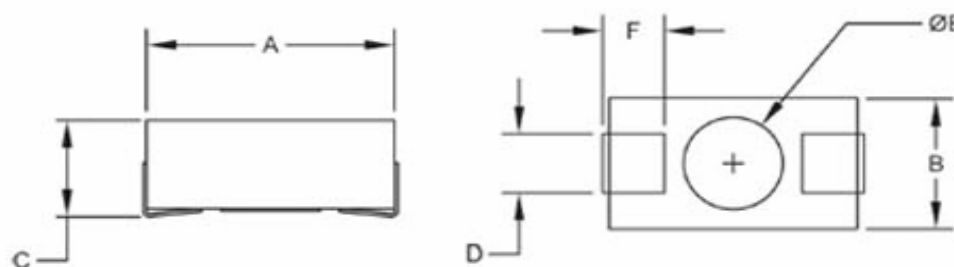

Serie	Dimension						Stand-Off		Footprint		
	A	B	C	D	F	Lead Thickness	E	Height	W	H	L
X57007	±0,4mm	±0,4mm	±0,4mm	±0,4mm	±0,4mm	0,15	±0,4mm	±0,05mm	±0,4mm	±0,4mm	±0,4mm
	11,40	6,40	2,50	3,00	2,50		4,80	0,13	3,90	5,80	13,70

## Power Derating Curve

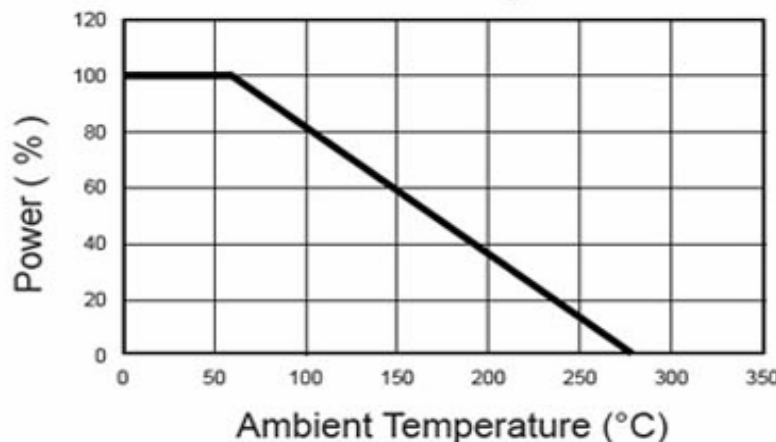

## Solder Pad Dimensions

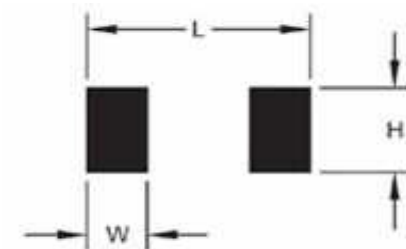

**Precision Surface Mount Wirewound Resistor**

Part No.: **X57007**

Customer:

DRW:	Jason	CHKD	Wilson	MATL:	Wilson	TOLERANCE	Mason	DATE	10.08.2008
APPD:	Schumi			FINISH	Jamy		Sheet No.	1 from 2	

# EDCON-COMPONENTS



## Ordering Informations

Serie	Range	Tolerance Code	Non-Inductive	Temp. Coefficient	ROHS	Packing
X57007	0R005	J	X	D	R	TR
	<b>0R005=</b> 0,005Ω	<b>J=</b> 5%	<b>X=</b> Standard Inductive	<b>A=</b> Call EDCON	<b>R=</b> ROHS Conform	<b>TR=</b> Tape/Reel
		<b>F=</b> 1%	<b>N=</b> Non Inductive	<b>B=</b> 20ppm/K	<b>N=</b> NON ROHS Conform	
		<b>B=</b> 0,1%		<b>C=</b> 50ppm/K		
		<b>A=</b> 0,01%		<b>D=</b> 120ppm/K		

<b>Precision Surface Mount Wirewound Resistor</b>	
Part No.:	<b>X57007</b>
Customer:	

DRW:	Jason	CHKD	Wilson	MATL:	Wilson	TOLERANCE	Mason	DATE	10.08.2008
APPD:	Schumi			FINISH	Jamy		Sheet No.	2 from 2	