



DATA SHEET

EMC/EMI Current Compensated Choke

Serie: F13018

EMC/EMI Current Compensated Choke	
Serie No.:	F13018
Customer:	

DRW:	Jason	CHKD	Wilson	MATL:	Wilson	TOLERANCE	Mason	DATE	31.05.2018
APPD:	Schumi			FINISH	Jamy		Sheet No.		1 from 5

EDCON-COMPONENTS

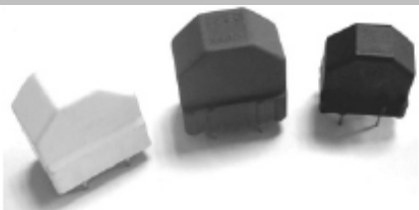

Technical Description

Features:

- Dual-Choke configuration
- Small compact design
- Multiple housing options
- Customs-specification available on request

Application:

- Phase-angle control circuits in combination with saturating chokes.
- EMI input filters
- Suppressing high interference levels

Dimensions & Configuration (mm)

Size Type	A	B	C	D	E	F	G	H
F13018	9,0	19,0	15,6	4,5	0,7	1,0	5,0	15,0

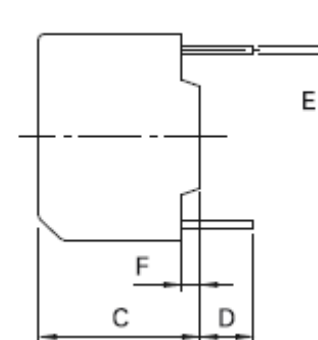
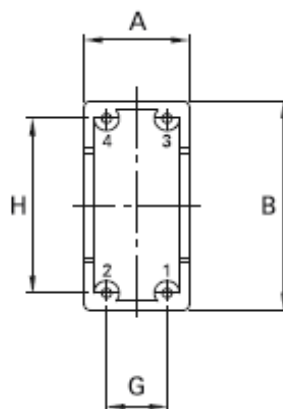

Schematic

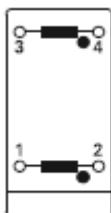

EMC/EMI Current Compensated Choke

Part No.: **F13018**

Customer:

					Tolerance (mm)				
					X=	X.X=	X.XX=	X.XXX=	Angle
DRW:	Jason	Manual	Wilson	MATL:	±0,35	±0,25	±0,20	±0,15	±5°
APPD:	Schumi			FINISH	Wilson	TOLERANCE	Mason	DATE	31.05.2018
					Jamy		Sheet No.		2 from 5

EDCON-COMPONENTS

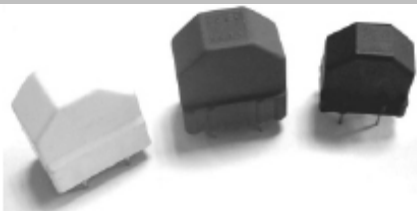

Electrical Characteristics Table

Ordering Range	Inductance (mH)	DCR (max.) (mΩ)	IDC(max.) (A)		
123	12	1275	0,3		
442	4,4	385	0,6		
302	3	205	1,0		
162	1,6	100	1,5		
112	1,1	70	2,0		

customs Range
welcome

EMC/EMI Current Compensated Choke	
Part No.:	F13018
Customer:	

DRW:	Jason	CHKD	Wilson	MATL:	Wilson	TOLERANCE	Mason	DATE	31.05.2018
APPD:	Schumi			FINISH	Jamy		Sheet No.		3 from 5

EDCON-COMPONENTS

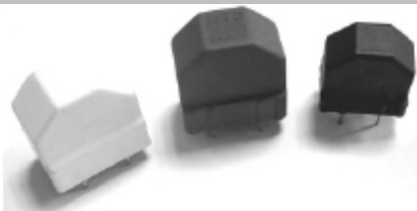

Ordering Informations

Customer	Ordering Code	Special function	Special function	ROHS	Packing Code					
----------	---------------	------------------	------------------	------	--------------	--	--	--	--	--

F13018	123	N	N	R	TY					
---------------	------------	----------	----------	----------	-----------	--	--	--	--	--

123 = 12mH other Ranges like Table	N= No special function	N= No special function	R= ROHS Conform	TY= Tray Package
			N= NON ROHS Conform	IV= Individual Package

EMC/EMI Current Compensated Choke	
Part No.:	F13018
Customer:	

DRW:	Jason	CHKD	Wilson	MATL:	Wilson	TOLERANCE	Mason	DATE	31.05.2018
APPD:	Schumi			FINISH	Jamy		Sheet No.		4 from 5



Soldering Profile Curve

Classification Reflow Profile (JEDEC J-STD-020C)

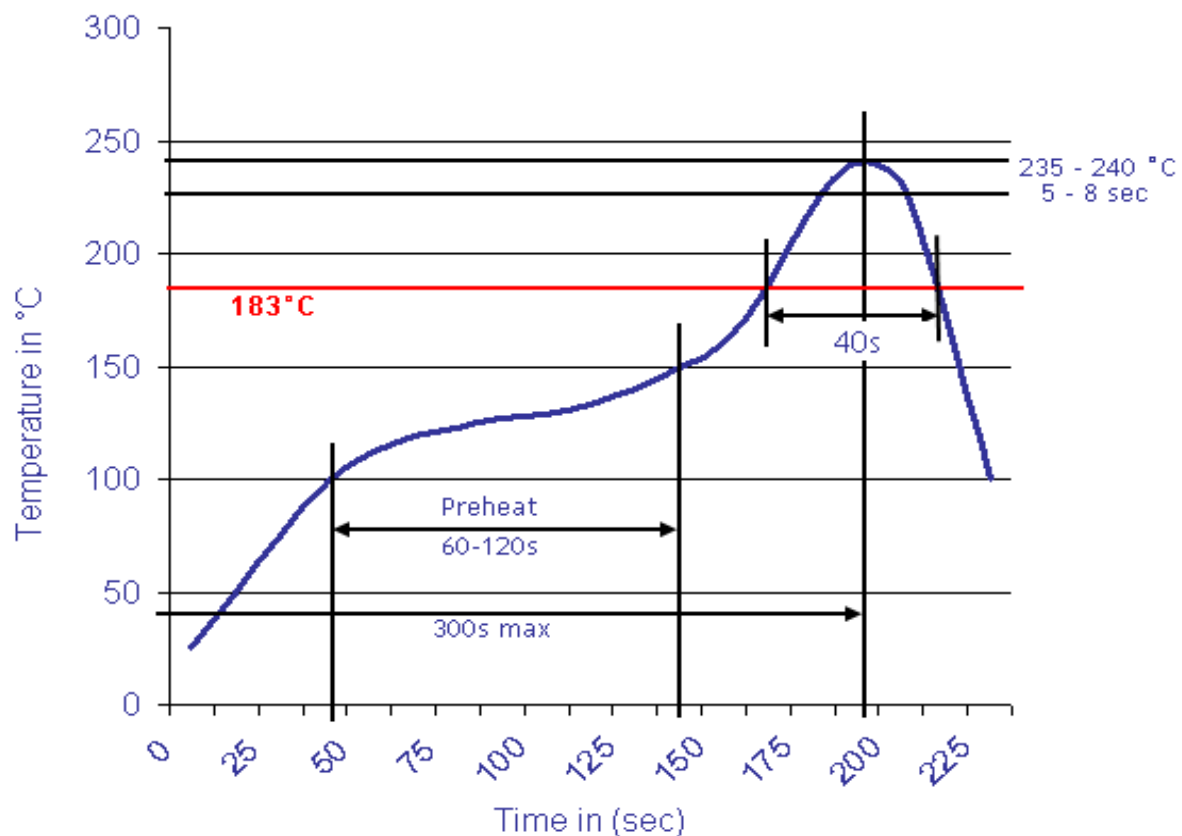

EMC/EMI Current Compensated Choke	
Part No.:	F13018
Customer:	

DRW:	Jason	CHKD	Wilson	MATL:	Wilson	TOLERANCE	Mason	DATE	31.05.2018
APPD:	Schumi			FINISH	Jamy		Sheet No.		5 from 5