



# DATA SHEET

## Commun Mode Choke size 20/10

### Serie: F13015

<b>Commun Mode Choke size 20/10</b>
Serie No.: <b>F13015</b>
Customer:

DRW:	Jason	CHKD	Wilson	MATL:	Wilson	TOLERANCE	Mason	DATE	31.05.2018
APPD:	Schumi			FINISH	Jamy		Sheet No.		1 from 5

# EDCON-COMPONENTS



## Technical Description

### Features:

- Low Cost
- Dielectric Strength: 1500Vrms
- Fixing pin Spacing allow easy PCB assembly
- Operating Temperature: -55°C to +105°C
- Customs Designs available

### Application:

- DC/DC, AC/DC line noise suppression
- Automotive Systems
- Communications Systems

## Dimensions & Configuration (mm)

Size Type	A	B	C	D	E	F
F13015	23,5 max.	17,0 max.	3,0 max.	28,0 max	10,7 Ref.	7,5 ±0,5

### PCB Layout

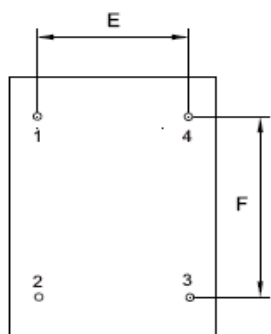

### Schematic

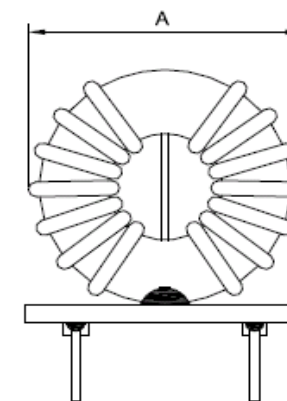
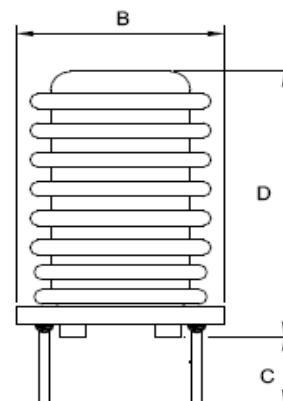
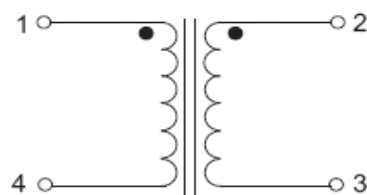

**Commun Mode Choke size  
20/10**

Part No.: **F13015**

Customer:

					Tolerance (mm)				
DRW:	Jason	CHKD	Wilson	MATL:	X=	X.X=	X.XX=	X.XXX=	Angle
APPD:	Schumi			FINISH	±0,35	±0,25	±0,20	±0,15	±5°
					Wilson	TOLERANCE	Mason	DATE	31.05.2018
					Jamy		Sheet No.		2 from 5

# EDCON-COMPONENTS



## Electrical Characteristics Table

Ordering Range	Special funtion S1	Inductance (min) (mH)	Rated Current	DCR (max.) (mΩ)	
102	N	1,0 ±30%	6,0	13	
222	N	2,2 ±30%	4,0	30	
332	N	3,3 ±30%	2,5	60	
502	N	5,0 ±30%	2,5	95	
103	N	10,0 ±30%	2,0	125	
203	N	20,0 ±30%	1,5	270	

customs Range  
welcome

<b>Commun Mode Choke size 20/10</b>	
Part No.:	<b>F13015</b>
Customer:	

DRW:	Jason	CHKD	Wilson	MATL:	Wilson	TOLERANCE	Mason	DATE	31.05.2018
APPD:	Schumi			FINISH	Jamy		Sheet No.		3 from 5

# EDCON-COMPONENTS



## Ordering Informations

Customer	Ordering Code	Special function S1	Special function S2	ROHS	Packing Code					
----------	---------------	---------------------	---------------------	------	--------------	--	--	--	--	--

<b>F13015</b>	<b>102</b>	<b>N</b>	<b>N</b>	<b>R</b>	<b>TY</b>					
---------------	------------	----------	----------	----------	-----------	--	--	--	--	--

102 = 1,0mH other Ranges like Table	N= No special function	N= No special function	R= ROHS Conform	TY= Tray Package
			N= NON ROHS Conform	IV= Individual Package

<b>Commun Mode Choke size 20/10</b>
Part No.: <b>F13015</b>
Customer:

DRW:	Jason	CHKD	Wilson	MATL:	Wilson	TOLERANCE	Mason	DATE	31.05.2018
APPD:	Schumi			FINISH	Jamy		Sheet No.		4 from 5



Soldering Profile Curve

Classification Reflow Profile (JEDEC J-STD-020C)

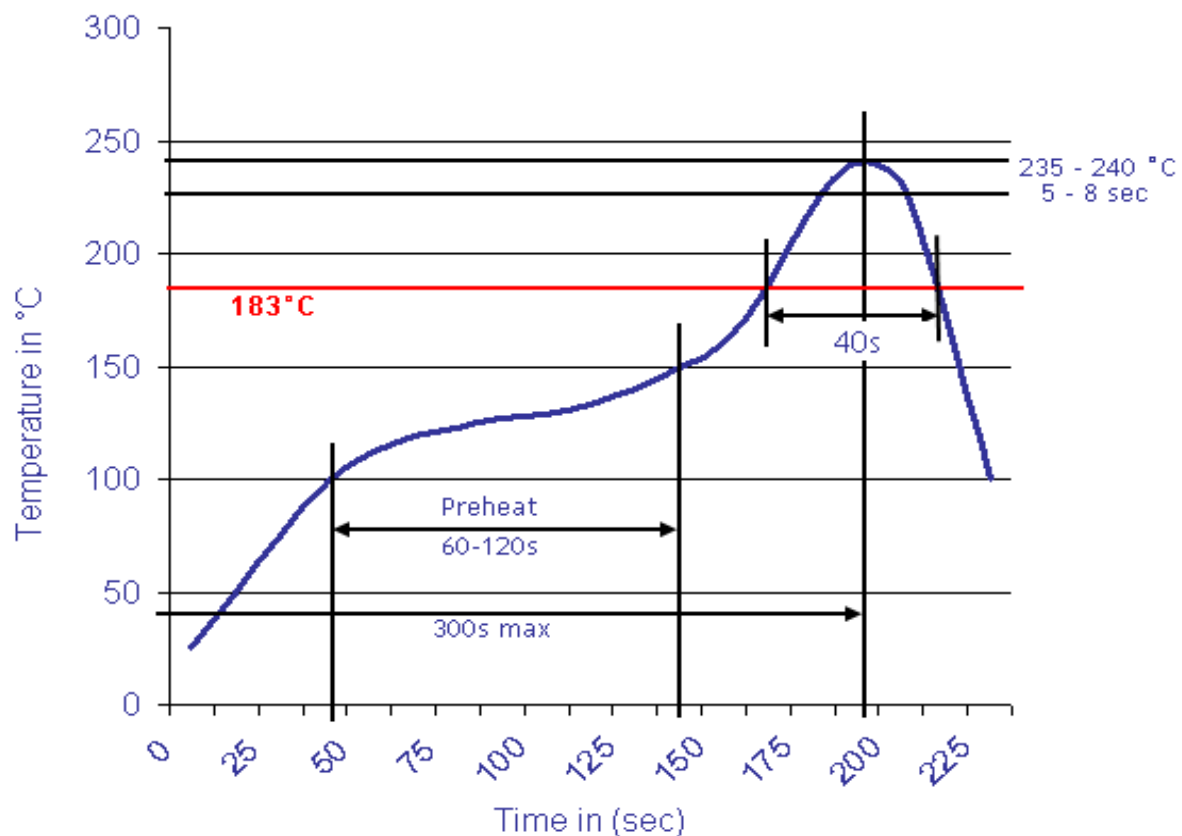

<b>Commun Mode Choke size</b>	
<b>20/10</b>	
Part No.:	<b>F13015</b>
Customer:	

DRW:	Jason	CHKD	Wilson	MATL:	Wilson	TOLERANCE	Mason	DATE	31.05.2018
APPD:	Schumi			FINISH	Jamy		Sheet No.		5 from 5