



**Technical Specification**

**Features**

- Wire Wound Construction
- Polyolefin Shrink Tube
- Excellent heat resistance
- Excellent environmental characteristics
- High reliability

**Dimensions**

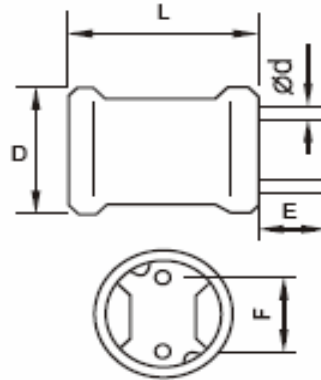

**Applications**

- Power Supplies
- SCR and TRIAC Controls
- RFI Suppression
- Filters
- Switching Regulators

**Technical Dimensions**

D (mm)	L (mm)	E (mm)	F (mm)
10,0	14,0	5,0/15	5
d (mm)			
0,6			

**Electrical Characteristics**

**Technical Information**

Testing LCR Bridge, measured @ 1KHz 0,1V HP4284A  
 Equivalent acceptacle  
 RDC. QuadTech 1880 Milliohmmeter  
 IDC: Max. Lowers inductance by 10%  
 Operating Temperature: -55°C ~ +125°C  
 Shrink tube: Flame retardent UL type VW-1  
 Marking: Inductance and tolerance  
 Note: All specifications subject to change without notice.

Inductance	Inductance Code	IDC	DCR max.
560μH	561	0,600A	1,200Ω

<b>THT Radial UL-Tube Power Choke</b>	
Part No.:	<b>S10R06</b>
Customer:	

DRW:	Jason	CHKD	Jules	MATL:	Wu	DATE	06.06.2007
APPD:	Join			FINISH	Shieh	Sheet	1 from 2



**Soldering Profile**

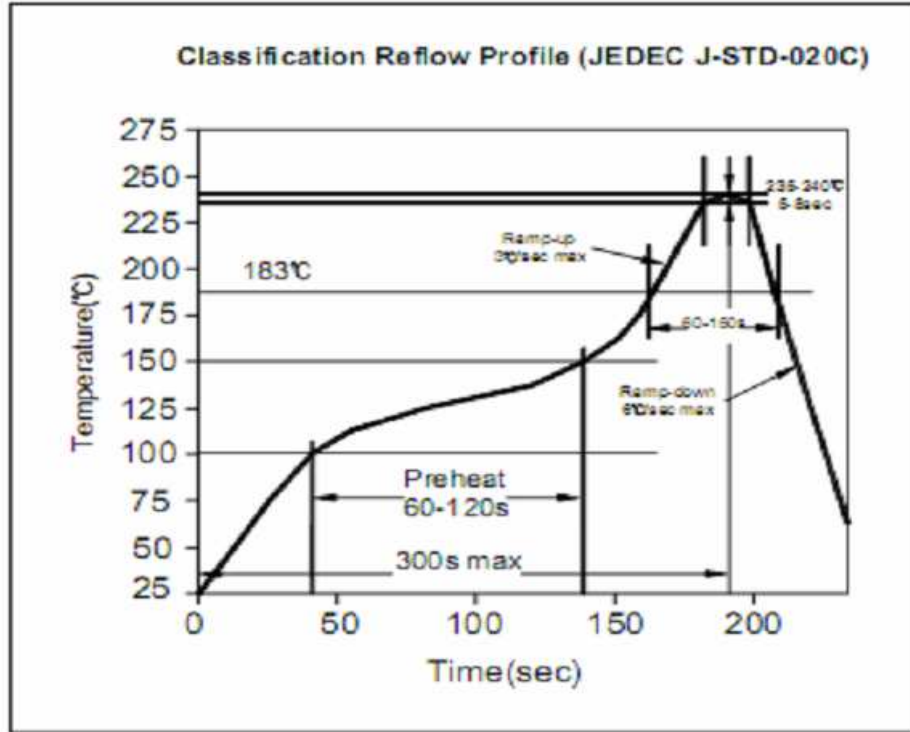

**Ordering Information**

Serie	Inductance	Tolerance	Lead Length	ROHS	Packing
-------	------------	-----------	-------------	------	---------

<b>S10R06</b>	<b>561</b>	<b>M</b>	<b>50</b>	<b>R</b>	<b>BU10</b>
---------------	------------	----------	-----------	----------	-------------

561= 560µH	M= Tol. 20%	50= 5mm	R= ROHS conform	BU= Bulk Ware TY= Tray Package
	K= Tol. 10%	15= 15mm	N=NON ROHS conform	

<b>THT Radial UL-Tube Power Choke</b>	
Part No.:	<b>S10R06</b>
Customer:	

DRW:	Jason	CHKD	Jules	MATL:	Wu	DATE	06.06.2007
APPD:	Join			FINISH	Shieh	Sheet	2 from 2

