



Technical Specification

Features

Wire Wound Construction
Polyolefin Shrink Tube
Excellent heat resistance
Excellent environmental characteristics
High reliability

Applications

Power Supplies
SCR and TRIAC Controls
RFI Suppression
Filters
Switching Regulators

Dimensions

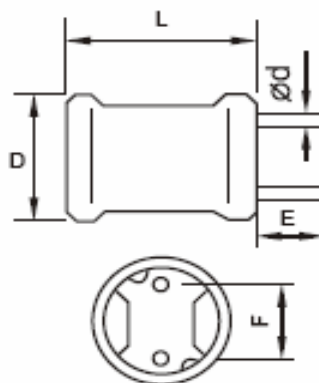

Technical Dimensions

D (mm)	L (mm)	E (mm)	F (mm)
8,8	12,0	5,0/15	5
d (mm)			
0,6			

Electrical Characteristics

Technical Information

Testing LCR Bridge, measured @ 1KHz 0,1V HP4284A
Equivalent acceptacle
RDC. QuadTech 1880 Milliohmmeter
IDC: Max. Lowers inductance by 10%
Operating Temperature: -55°C ~ +125°C
Shrink tube: Flame retardent UL type VW-1
Marking: Inductance and tolerance
Note: All specifications subject to change without notice.

Inductance	Inductance Code	IDC	DCR max.
100μH	101	0,900A	0,190Ω

THT Radial UL-Tube Power Choke

Part No.: **S10R05**

Customer:

DRW:	Jason	CHKD	Jules	MATL:	Wu	DATE	06.06.2007
APPD:	Join			FINISH	Shieh	Sheet	1 from 2

Copyright by EDCON-COMPONENTS H.Schmitt 20.6.2008



Soldering Profile

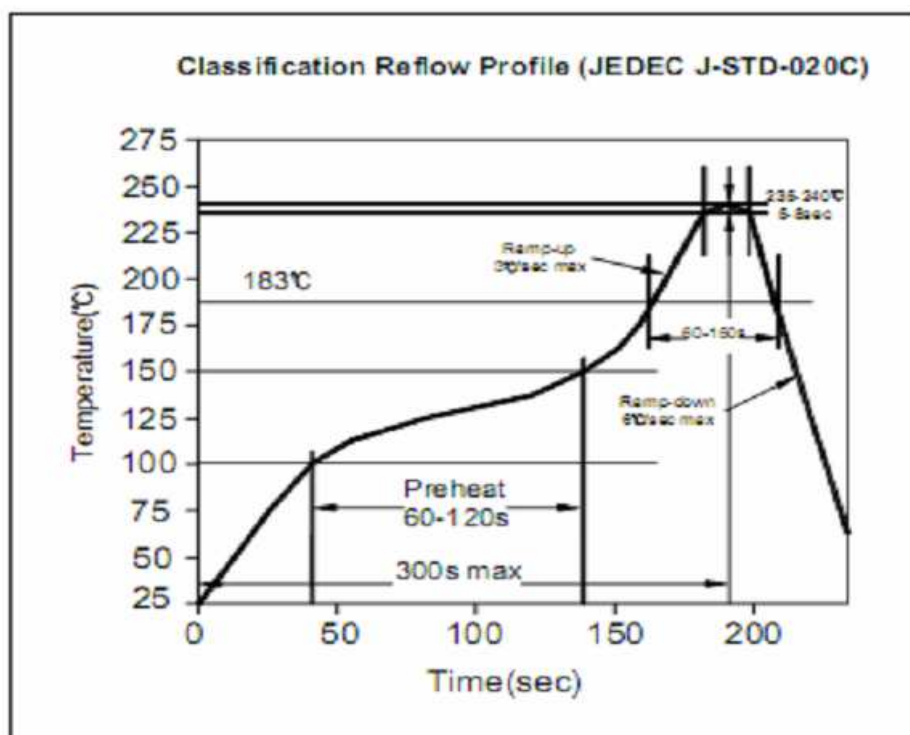

Ordering Information

Serie	Inductance	Tolerance	Lead Length	ROHS	Packing	
-------	------------	-----------	-------------	------	---------	--

S10R05	101	M	50	R	BU10	
---------------	------------	----------	-----------	----------	-------------	--

101= 100µH	M= Tol. 20%	50= 5mm	R= ROHS conform	BU= Bulk Ware
	K= Tol. 10%	15= 15mm	N= NON ROHS conform	TY= Tray Package

THT Radial UL-Tube Power Choke

Part No.: **S10R05**

Customer:

DRW:	Jason	CHKD	Jules	MATL:	Wu	DATE	06.06.2007
APPD:	Join			FINISH	Shieh	Sheet	2 from 2

