

**Technical Specification**

Insulator:	White glass filled polyester PBT
Flammability:	UL 94V-0
Sleeve:	Brass CuZn 38Pb2 (36000)
Mating Pin: ( Ø )	0,50 / 0,50 mm
Mechanical Life:	min 500 cycles
Rated Current:	3A
Contact Resistance:	max. 10m Ohm
Dielectric Strength:	min 1000V rms
Minimal position of deliver:	2 ~ 40

**Technical Drawing**

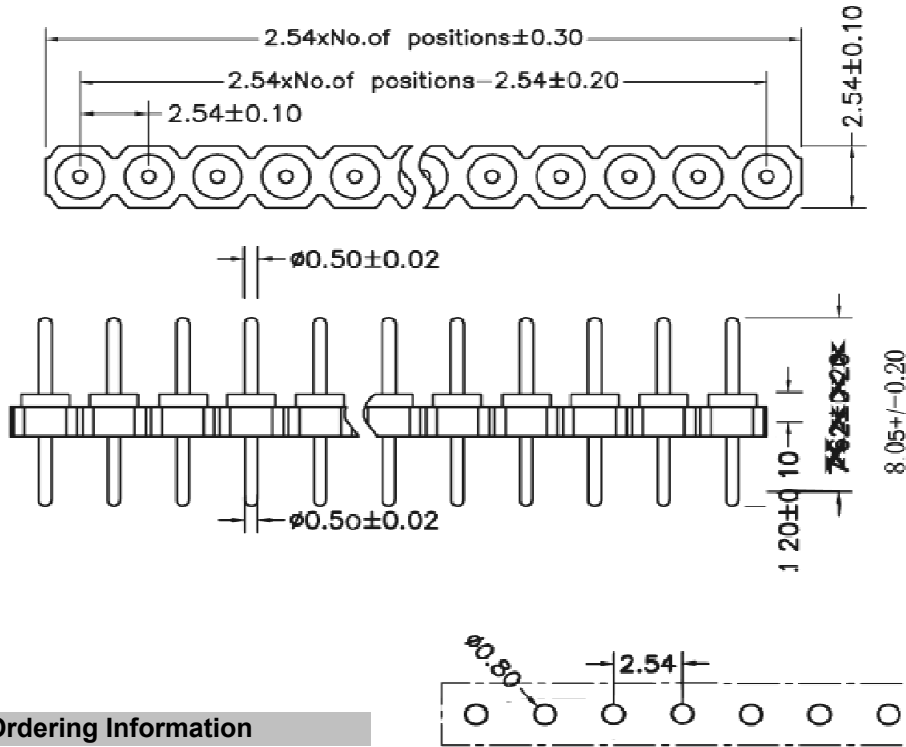
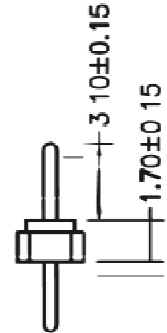

**Ordering Information**

Serie	No. of Pos.	Solder Pin Plating	ROHS	Packing		
T40301	40	A	R	B1		

<b>02 ~ 40</b>	A= Tin 150µ" (Standard)	R= ROHS conform	B1= Bulk 100PCS Ix = individuall
	B= Tin 200µ"	N= NON ROHS conform	
	C= GF		
	D= Gold 2µ"		
	E= Gold 3µ"		
	F= Gold 10µ"		
	G= Gold 15µ"		
H=Special			

<b>Machined Contact Pitch 2,54mm</b>	
Part No.:	<b>T40301</b>
Customer:	

DRW:	Jason	CHKD	Jules	MATL:	Wu	DATE	25.08.2023
APPD:	Join			FINISH	Shieh	Sheet	1 from 2

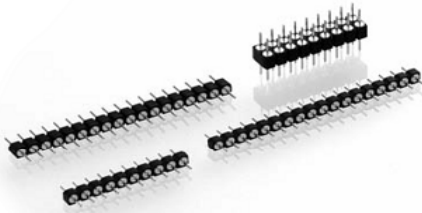

**Solder Condition**

**Lead Free Solder**

**Classification Reflow Profile (JEDEC J-STD-020C)**

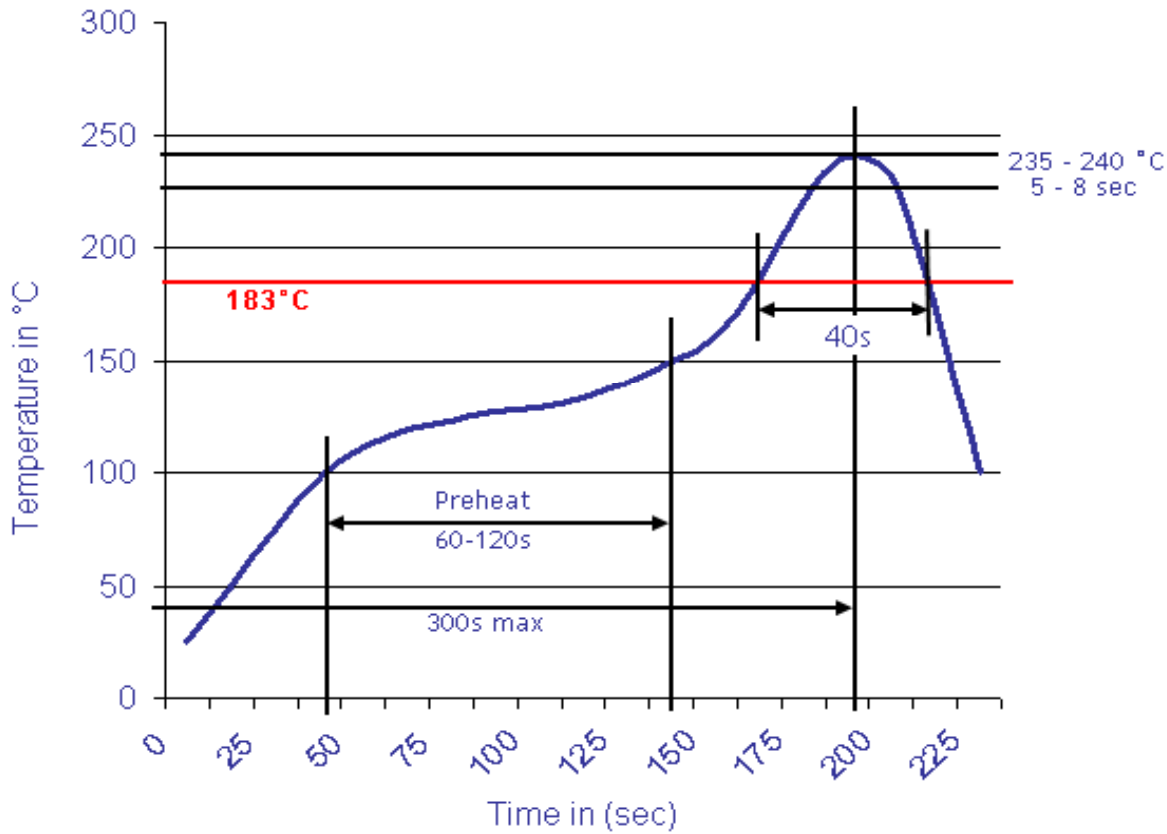

**Machined Contact Pitch  
2,54mm**

Part No.: **T40301**

Customer:

DRW:	Jason	CHKD	Jules	MATL:	Wu	DATE	25.08.2023
APPD:	Join			FINISH	Shieh	Sheet	2 from 2