

Technical Specification

Insulator:	Black glass filled polyester PPS-GF-30-FR
Flammability:	UL 94V-0
Sleeve:	Brass CuZn 36Pb3 (36000)
Contact Clip (3finger):	Beryllium Copper (C17200)
Mating Pin: (Ø)	0,40 to 0,56mm
Forces:	polished steel gauge(Ø)0,43mm
.-Insertion:	3N typ.
.-Withdrawel:	1,5N typ.
Mechanical Life:	min 500 cycles
Rated Current:	3A
Contact Resistance:	max. 10m Ohm
Dielectric Strength:	min 1000V rms
Maximal position of deliver:	2
Maximal position of deliver:	40

Technical Drawing

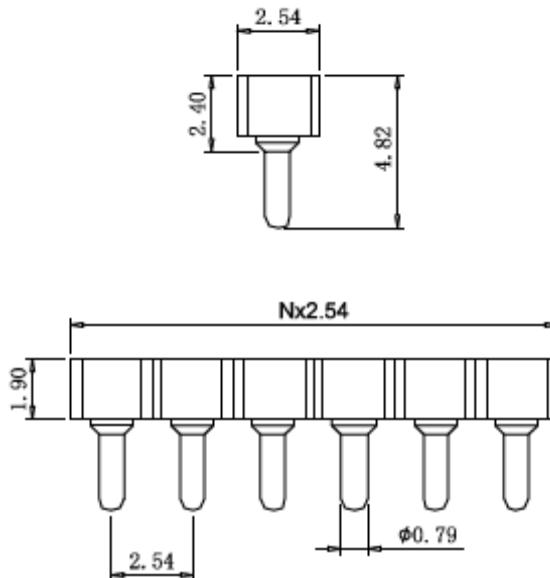

PCB Layout

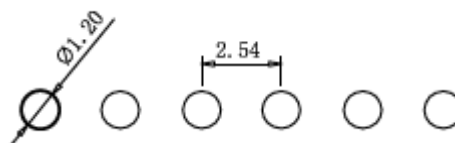

Ordering Information

Serie	No. of Pos.	Solder Pin Plating	Inner Clip Plating	ROHS	Packing
T40058	02	A	3	R	B1

02 ~ 40	A = Tin 150µ"	1 = Tin 150µ"	R = ROHS conform N = NON ROHS conform	B1 = Bulk 100PCS TR = Tape/Reel w. Pic and Place Mylar-Foil TU = Tupe w. Pic and Place Mylar Foil
	(Standard)	2 = Tin 200µ"		
	B = Tin 200µ"	3 = GF (Standard)		
	C = GF	4 = Gold 2µ"		
	D = Gold 2µ"	5 = Gold 3µ"		
	E = Gold 3µ"	6 = Gold 10µ"		
	F = Gold 10µ"	7 = Gold 15µ"		
	G = Gold 15µ"	8 =Special		
H =Special				

Machined Contact Pitch 2,54mm
Part No.: T40058
Customer:

DRW:	Jason	CHKD	Jules	MATL:	Wu	DATE	21.07.2017
APPD:	Join			FINISH	Shieh	Sheet	1 from 1