

Pitch 2,54 x XXX mm

Technical Specifications:

Insulator:	Black glass filled polyester
	PBT-GF30-FR
Flammability:	UL94V-0
Sleeve:	Brass CuZn 36pb3 (36000)
Contact Clip:	6 finger Beryllium Copper (C17200)
Mating Pin:	0,40 to 0,56mm
Forces:	polished steel gauge 0,43mm
Insertion:	2N typ.
Withdrawal:	1N typ.
Mechanical Life:	min 100 cycles
Rated Current:	1A
Contact Resistance:	max. 10 milli Ohm
Dielectric strength:	min 1000V rms
Temp. Range:	.-40°C to + 105°C

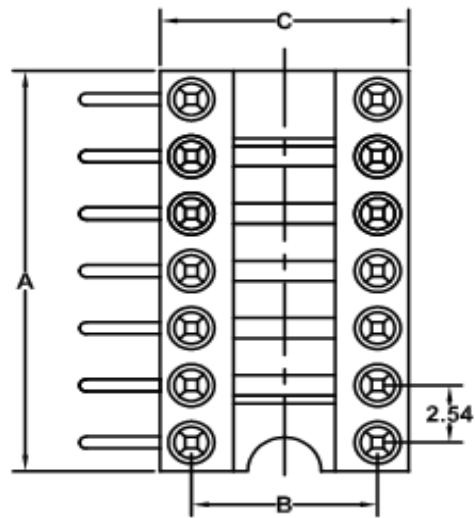
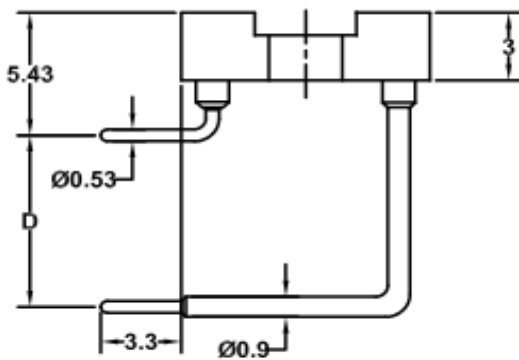

Machined Contact Dual Inline Socket

Part No.: **T34016**

Customer:

DRW:	Jason	CHKD	Jules	MATL:	Wu	DATE	06.06.2009
APPD:	Join			FINISH	Shieh	Sheet	1 from 2

Copyright by EDCON-COMPONENTS H.Schmitt 20.6.2008

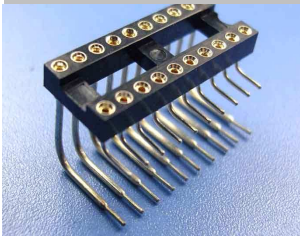

Order Code	No of Pos.	A	B	C	D
		(mm)	(mm)	(mm)	(mm)
306	6	7,6	7,62	10,1	2,54 / 7,62
308	8	10,1	7,62	10,1	2,54 / 7,62
310	10	12,6	7,62	10,1	2,54 / 7,62
312	12	15,2	7,62	10,1	2,54 / 7,62
314	14	17,7	7,62	10,1	2,54 / 7,62
316	16	20,3	7,62	10,1	2,54 / 7,62
318	18	22,8	7,62	10,1	2,54 / 7,62
320	20	25,3	7,62	10,1	2,54 / 7,62
322	22	27,8	7,62	10,1	2,54 / 7,62
324	24	30,4	7,62	10,1	2,54 / 7,62
328	28	35,5	7,62	10,1	2,54 / 7,62
624	24	30,5	15,24	17,7	2,54 / 7,62
628	28	35,5	15,24	17,7	2,54 / 7,62
632	32	40,6	15,24	17,7	2,54 / 7,62
636	36	45,7	15,24	17,7	2,54 / 7,62
640	40	50,8	15,24	17,7	2,54 / 7,62
642	42	53,3	15,24	17,7	2,54 / 7,62
648	48	60,9	15,24	17,7	2,54 / 7,62

Ordering Information

Serie	Order Code	Solder Pin Plating	Contact Clip Plating	Row Spacing (D)	ROHS	Packing
T34016	xxx	A	3	A	R	TU

look table	A= Tin 150µ" (Standard)	1= Tin 150µ" 2= Tin 200µ"	A= D=2,54mm	R= ROHS conform	TU= TUPE Packing
	B= Tin 200µ"	3= GF (Standard)			
	C= GF	4= Gold 2µ"			
	D= Gold 2µ"	5= Gold 3µ"			
	E= Gold 3µ"	6= Gold 10µ"			
	F= Gold 10µ"	7= Gold 15µ"			
	G= Gold 15µ"	8=Special			
	H=Special				

Machined Contact Dual Inline Socket

Part No.: **T34016**

Customer:

DRW:	Jason	CHKD	Jules	MATL:	Wu	DATE	06.06.2009
APPD:	Join			FINISH	Shieh	Sheet	2 from 2