

Pitch 1,778mm

Technical Specifications:

Insulator:	Black glass filled polyester
	PBT-GF30-FR
Flammability:	UL94V-0
Sleeve:	Brass CuZn 36pb3 (36000)
Contact Clip:	6 finger Beryllium Copper (C17200)
Mating Pin:	0,40 to 0,56mm
Forces:	polished steel gauge 0,46mm
Insertion:	2N typ.
Withdrawal:	1N typ.
Mechanical Life:	min 100 cycles
Rated Current:	1A
Contact Resistance:	max. 10 milli Ohm
Dielectric strength:	min 1000V rms
Temp. Range:	.-40°C to + 105°C

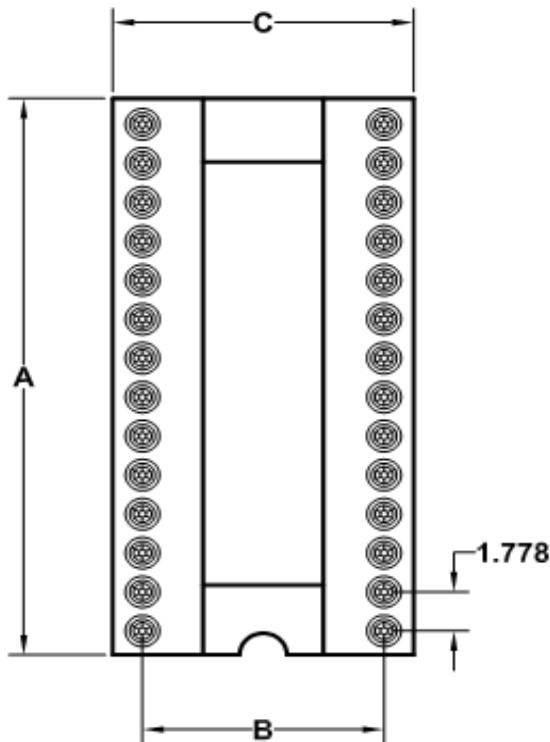
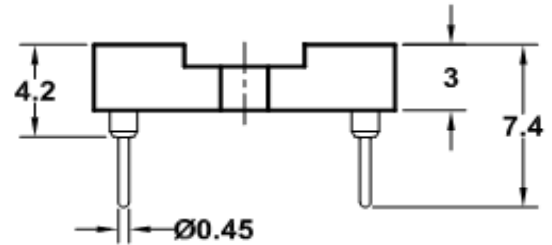

**Machined Contact Dual
 Inline Socket**

Part No.: **T34001**

Customer:

DRW:	Jason	CHKD	Jules	MATL:	Wu	DATE	06.06.2009
APPD:	Join			FINISH	Shieh	Sheet	1 from 2

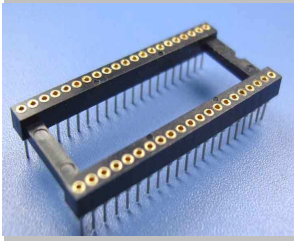

Order Code	No of Pos.	A	B	C
		(mm)	(mm)	(mm)
424	24	21,8	10,16	12,7
428	28	25,2	10,16	12,7
430	30	27,0	10,16	12,7
432	32	28,8	10,16	12,7
448	48	43,1	10,16	12,7
620	20	18,1	15,24	17,64
624	24	21,7	15,24	17,64
638	28	25,2	15,24	17,64
640	40	35,8	15,24	17,64
642	42	37,7	15,24	17,64
648	48	43,1	15,24	17,64
652	52	46,7	15,24	17,64
656	56	50,2	15,24	17,64
664	64	57,3	15,24	17,64
668	68	60,9	15,24	17,64
764	64	57,3	19,05	21,45

Ordering Information

Serie	Order Code	Solder Pin Plating	Contact Clip Plating	ROHS	Packing	
T34001	xxx	A	3	R	TU	

look Page	A= Tin 150µ" (Standard)	1= Tin 150µ" 2= Tin 200µ"	R= ROHS conform	TU= TUPE Packing
	B= Tin 200µ"	3= GF (Standard)		
	C= GF	4= Gold 2µ"		
	D= Gold 2µ"	5= Gold 3µ"		
	E= Gold 3µ"	6= Gold 10µ"		
	F= Gold 10µ"	7= Gold 15µ"		
	G= Gold 15µ"	8=Special		
	H=Special			

Machined Contact Dual Inline Socket	
Part No.:	T34001
Customer:	

DRW:	Jason	CHKD	Jules	MATL:	Wu	DATE	06.06.2007
APPD:	Join			FINISH	Shieh	Sheet	2 from 2

