

## T85009 Series Minitype Screw Thread Electronic Connectors

### 一、 Product Description

The T85009 Series is the minitype screw thread electronic connectors. It was developed widely using electron, instrument, video and medical equipments.

The characteristics of the products are as follows:

The screw thread makes it reliable to be connected.

Compact structure makes it small-size.



### 二、 T85009 Structure of the product number

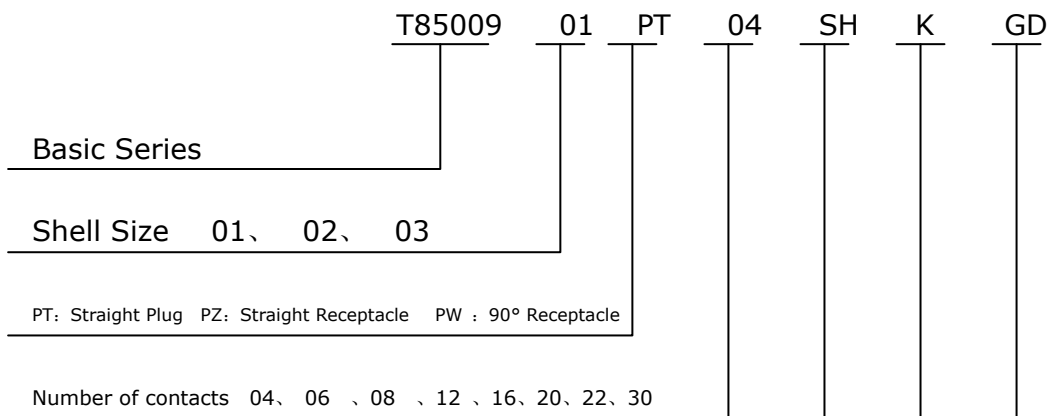

## EDCON.COMPONENTS

Type of contacts SH: Solder Type SP: PCB Type

Insulated module: K: Module load hole Z: Module load pin

Receptacle location: GD: Tighten Type FD: Floating Type

### 三、Contact Configuration and Major Ratings

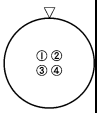
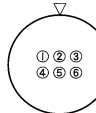
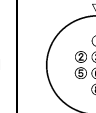
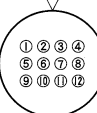
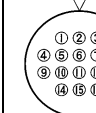
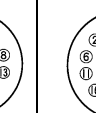
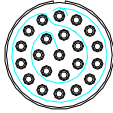
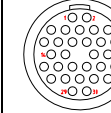
Item	Technical Characteristics	Contact Layouts							
		1#Shell			2#Shell			3#Shell	
									
1	Contact Diameter mm	0.3	0.3	0.3	0.3	0.3	0.3	0.7	0.7
2	Contact Resistance mΩ	30	30	30	30	30	30	15	15
3	Working Voltage KV/DC	0.4	0.4	0.4	0.4	0.4	0.4	0.5	0.5
	Working Voltage KV/AC	0.3	0.3	0.3	0.3	0.3	0.3	0.35	0.35
4	Test Voltage KV/DC	0.4	0.4	0.4	0.4	0.4	0.4	0.68	0.68
	Test Voltage KV/AC	0.3	0.3	0.3	0.3	0.3	0.3	0.5	0.5
5	Working Current A	1	1	1	1	1	1	3.5	3.5
6	Working Temperature °C	-50 <sup>0</sup> C—125 <sup>0</sup> C							
7	Mechanical Endurance (Times)	1000							

### 四：Major Specified Materials

Part Name	Material	Finish
Male contacts	Beryllium brass /stannum bronze	Gold
Female contacts	Beryllium brass /stannum bronze	Gold
Insulation	PPS	----

## EDCON.COMPONENTS

Inner shell	Zincum alloy	Nickel plating
Outer shell	Brass (H59)	Nickel plating

### Plug/Receptacle Mate Mode

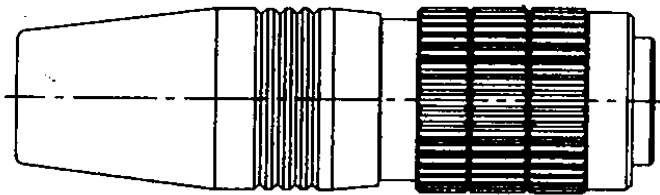

Solder Plug

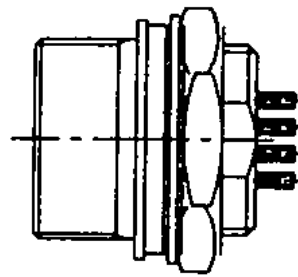

Solder Receptacle

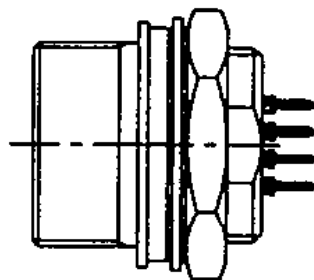

PCB Receptacle

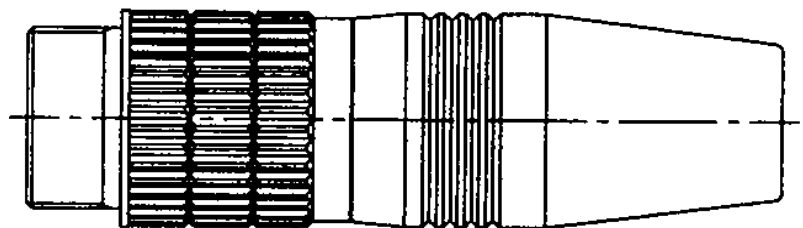

Float Solder Receptacle

## Solder Plug

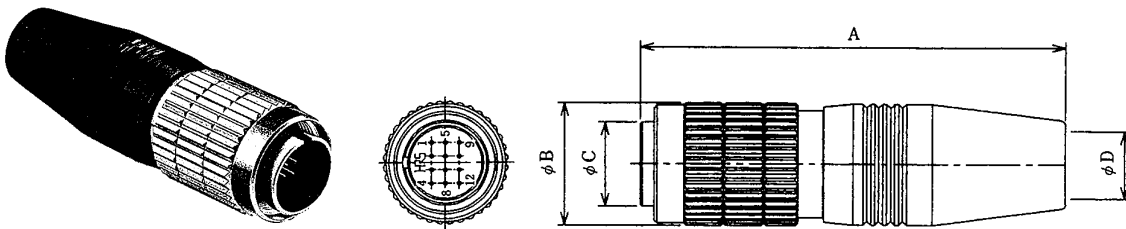

Shell Size	Part No	Contact Quantity	A	φ B	φ C	φ D
1	T85009.01PT04SH-Z	4	35	10.5	6.7	5.0
	T85009.01PT06SH-Z	6	35	10.5	6.7	5.0
	T85009.01PT08SH-Z	8	35	10.5	6.7	5.0
	T85009.01PT04SH-K	4	35	10.5	6.7	5.0
	T85009.01PT06SH-K	6	35	10.5	6.7	5.0
	T85009.01PT08SH-K	8	35	10.5	6.7	5.0
2	T85009.02PT12SH-Z	12	43	12.5	8.7	7.0
	T85009.02PT16SH-Z	16	43	12.5	8.7	7.0
	T85009.02PT20SH-Z	20	43	12.5	8.7	7.0
	T85009.02PT12SH-K	12	43	12.5	8.7	7.0
	T85009.02PT16SH-K	16	43	12.5	8.7	7.0
	T85009.02PT20SH-K	20	43	12.5	8.7	7.0
	T85009.03PT22SH-Z	22	52	16.5	12.3	8.0

## EDCON.COMPONENTS

3	T85009.03PT30SH-Z	30	67	16	12.3	8.0
	T85009.03PT22SH-K	22	52	16.5	12.3	8.0
	T85009.03PT30SH-K	30	67	16	12.3	8.0

## Solder Receptacle

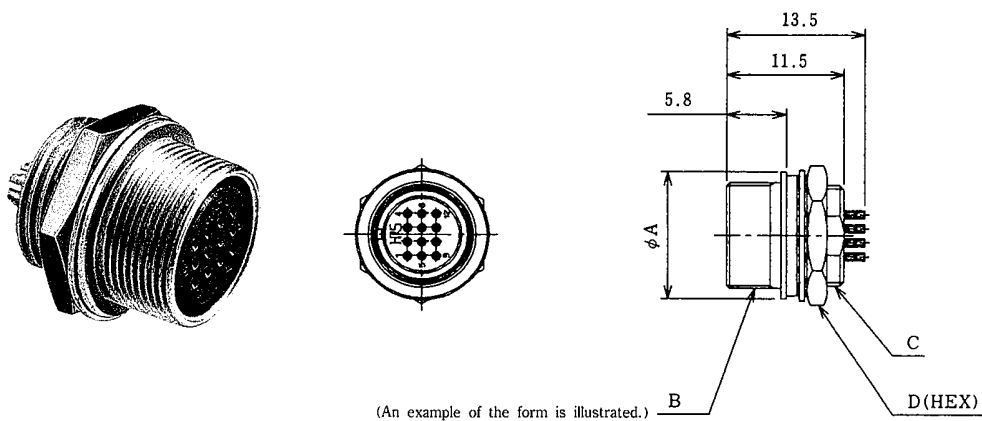

Shell Size	Part No	Contact Quantity	φ A	B	C	D
1	T85009.01PZ04SH-Z-GD	4	10.6	M8.5*0.5	M8.0*0.5	10
	T85009.01PZ06SH-Z-GD	6	10.6	M8.5*0.5	M8.0*0.5	10
	T85009.01PZ08SH-Z-GD	8	10.6	M8.5*0.5	M8.0*0.5	10
	T85009.01PZ04SH-K-GD	4	10.6	M8.5*0.5	M8.0*0.5	10
	T85009.01PZ06SH-K-GD	6	10.6	M8.5*0.5	M8.0*0.5	10
	T85009.01PZ08SH-K-GD	8	10.6	M8.5*0.5	M8.0*0.5	10
	T85009.02PZ12SH-Z-GD	12	12.6	M10.5*0.75	M10*0.75	12
	T85009.02PZ16SH-Z-GD	16	12.6	M10.5*0.75	M10*0.75	12
	T85009.02PZ20SH-Z-GD	20	12.6	M10.5*0.75	M10*0.75	12

## EDCON.COMPONENTS

2	T85009.02PZ12SH-K-GD	12	12.6	M10.5*0.75	M10*0.75	12
	T85009.02PZ16SH-K-GD	16	12.6	M10.5*0.75	M10*0.75	12
	T85009.02PZ20SH-K-GD	20	12.6	M10.5*0.75	M10*0.75	12
3	T85009.03PZ22SH-Z-GD	22	16	M14*0.6	M14*0.75	15.5
	T85009.03PZ30SH-Z-GD	30	16	M14*0.6	M14*0.75	15.5
	T85009.03PZ22SH-K-GD	22	16	M14*0.6	M14*0.75	15.5
	T85009.03PZ30SH-K-GD	30	16	M14*0.6	M14*0.75	15.5

## Float Receptacle

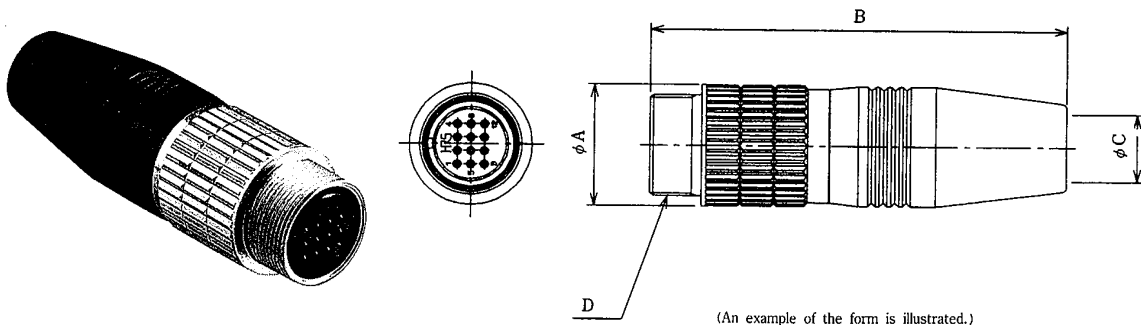

Shell Size	Part No	Contact Quantity	$\phi A$	B	$\phi C$	D
1	T85009.01PZ04SH-Z-FD	4	10.6	35	5.0	M8.5*0.5
	T85009.01PZ06SH-Z-FD	6	10.6	35	5.0	M8.5*0.5
	T85009.01PZ08SH-Z-FD	8	10.6	35	5.0	M8.5*0.5
	T85009.01PZ04SH-K-FD	4	10.6	35	5.0	M8.5*0.5
	T85009.01PZ06SH-K-FD	6	10.6	35	5.0	M8.5*0.5
	T85009.01PZ08SH-K-FD	8	10.6	35	5.0	M8.5*0.5

## EDCON.COMPONENTS

2	T85009.02PZ12SH-Z-FD	12	12.6	43	7.0	M10.5*0.75
	T85009.02PZ16SH-Z-FD	16	12.6	43	7.0	M10.5*0.75
	T85009.02PZ20SH-Z-FD	20	12.6	43	7.0	M10.5*0.75
	T85009.02PZ12SH-K-FD	12	12.6	43	7.0	M10.5*0.75
	T85009.02PZ16SH-K-FD	16	12.6	43	7.0	M10.5*0.75
	T85009.02PZ20SH-K-FD	20	12.6	43	7.0	M10.5*0.75
3		----	----	-----	-----	-----
		----	----	-----	-----	-----

### PCB Receptacle

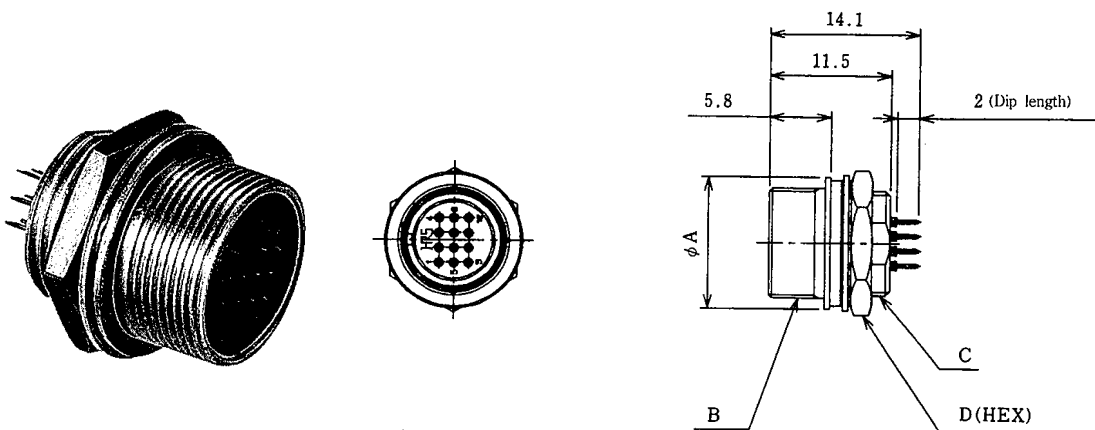

(An example of the form is illustrated.)

Shell Size	Part No	Contact Quantity	φ A	B	C	D
1	T85009.01PZ04SP-Z-GD	4	10.6	M8.5*0.5	M8.0*0.5	10
	T85009.01PZ06SP-Z-GD	6	10.6	M8.5*0.5	M8.0*0.5	10
	T85009.01PZ08SP-Z-GD	8	10.6	10.6	M8.5*0.5	M8.0*0.5
2	T85009.02PZ12SP-Z-GD	12	12.6	M10.5*0.75	M10*0.75	12
	T85009.02PZ16SP-Z-GD	16	12.6	M10.5*0.75	M10*0.75	12
	T85009.02PZ20SP-Z-GD	20	12.6	M10.5*0.75	M10*0.75	12

## EDCON.COMPONENTS

3	T85009.03PZ22SP-k-GD	22	16	M14*0.6	M14*0.75	15.5
	T85009.03PZ30SP-k-GD	30	16	M14*0.6	M14*0.75	15.5

### Solder Install Chart

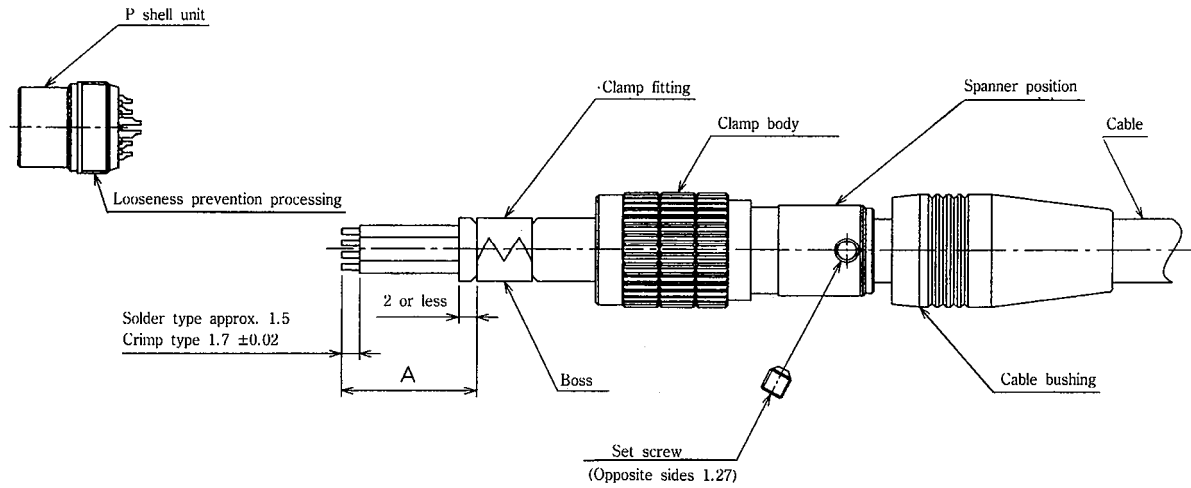

### 90° Receptacle (Used for 3# shell)

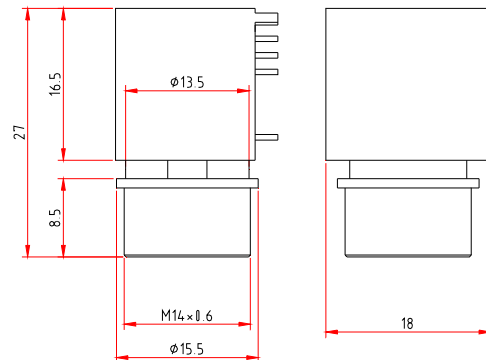

### Install Patterns Dimension



# EDCON.COMPONENTS

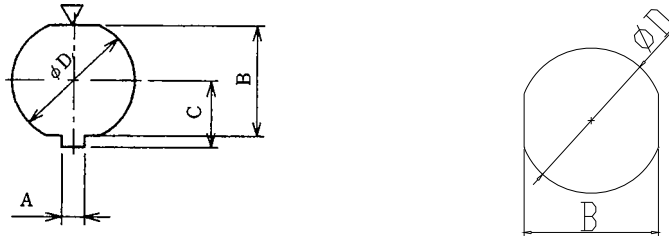

No	Shell Size		
	1#Shell	2#Shell	3#Shell
A	1.6	1.6	----
B	7.3	9.3	12.9
C	4.5	5.5	----
D	8.1	10.1	14
Install Patterns Thickness	0.7~2	0.7~2	0.7~2

## PCB Drilling Patterns Dimension

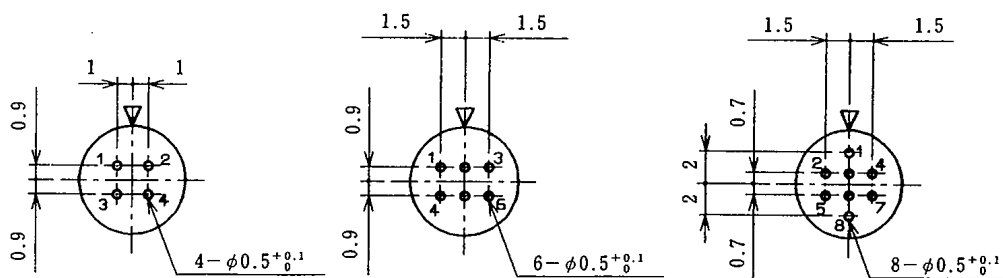

# EDCON.COMONENTS

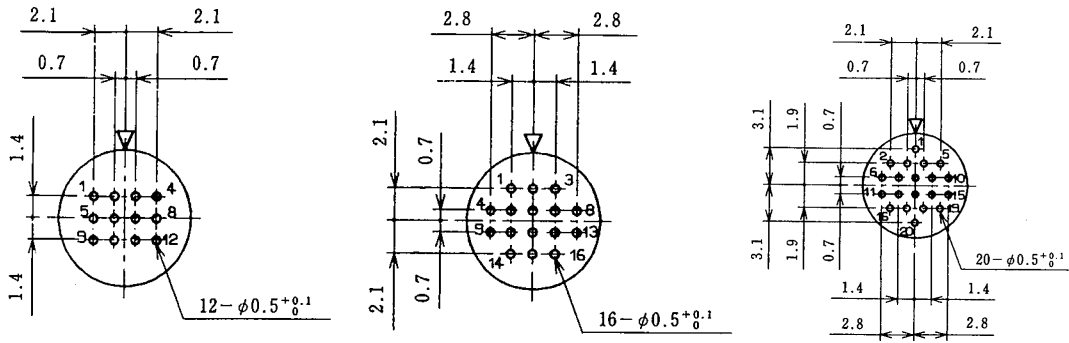

1. "▲" Stand for install mark.