

EDCON-COMPONENTS

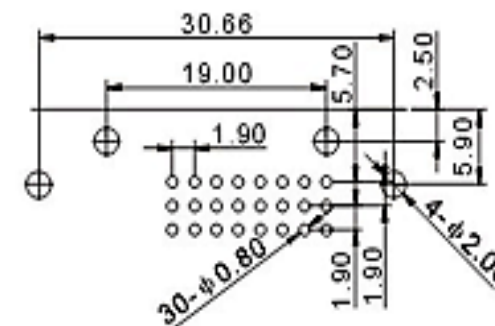

Technical Discription

Temperature Range:	. -25°C ~ +70°C
Rated Load	DC30V 0,5A
Contact Resistance:	≤ 0,03 Ω
Insulation Resistance:	≥ 500M Ω
Withstanding Voltage:	AC 250V / 50Hz) 1 min.
Insertion and Extraction Force:	5 ~ 30N
Lifetime:	1000 cycles

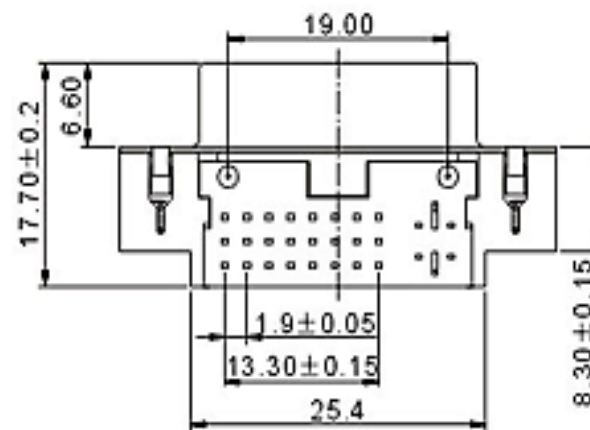
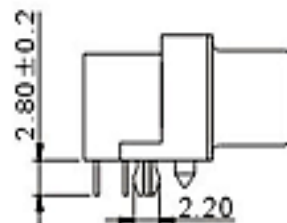
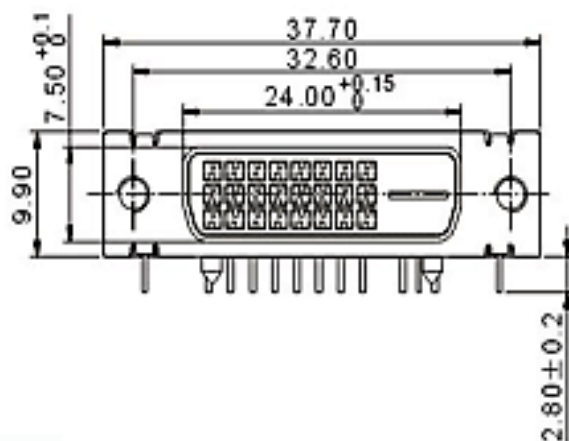

DVI-Connector Right Angle

Part No.: **T26004**

Customer:

DRW:	Jason	CHKD	Wilson	MATL:	Wilson	TOLERANCE	Mason	DATE	10.04.2009
APPD:	Schumi			FINISH	Jamy		Sheet No.		1 from 3

EDCON-COMPONENTS



Ordering Informations

Serie	Pos.	ROHS	Packing							
T26004	24	R	TY							

24= Pos.	R= ROHS Conform	TY= Tray Package
	R= ROHS Conform	BU= Bulk Ware

DVI-Connector Right Angle	
Part No.:	T26004
Customer:	

DRW:	Jason	CHKD	Wilson	MATL:	Wilson	TOLERANCE	Mason	DATE	10.04.2009
APPD:	Schumi			FINISH	Jamy		Sheet No.		2 from 3



Lead Free Soldering Curve

Classification Reflow Profile (JEDEC J-STD-020C)

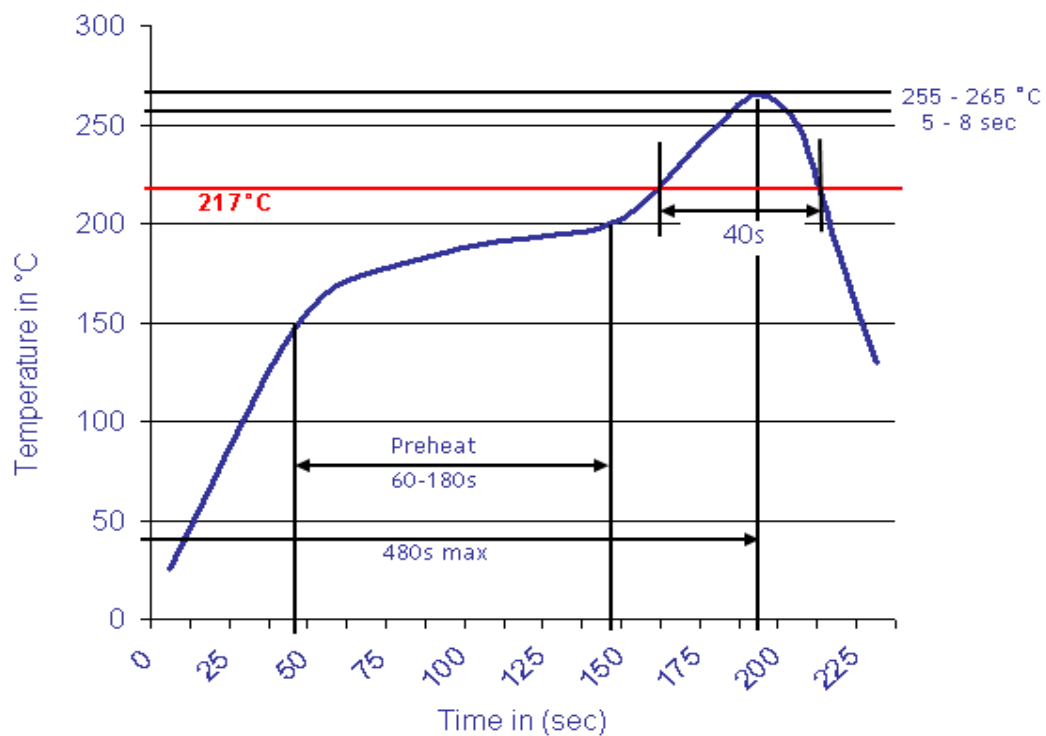

DVI-Connector Right Angle	
Part No.:	T26004
Customer:	

DRW:	Jason	CHKD:	Wilson	MATL:	Wilson	TOLERANCE:	Mason	DATE:	10.04.2009
APPD:	Schumi			FINISH:	Jamy		Sheet No.		3 from 3