

EDCON-COMPONENTS

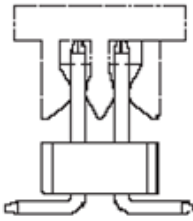

Specifications

Current Rating:	1,0 Ampere
Insulator Resistance:	1000 Megaohm min.
Dielectric Withstanding:	AC 500V
Operating Temperature:	.-40°C to +105°C
Contact Material:	Copper, Alloy
Insulator Material:	P.B.T / PA6T
Standard:	PBT
Contact Plating:	Tin, Gold or Selective Plated
Standard:	Gold Flash Overall
Selectiv Plating:	Gold flash plated on contact area / tin plated on solder area
Max. Prozessing Temp.	230°C for 60 seconds

P.C.B Layout

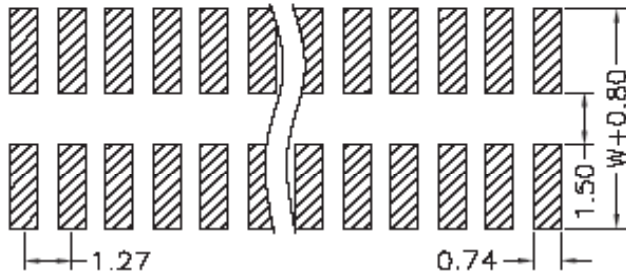

Drawing (dimensions all into mm)

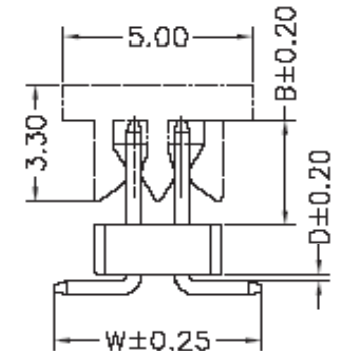
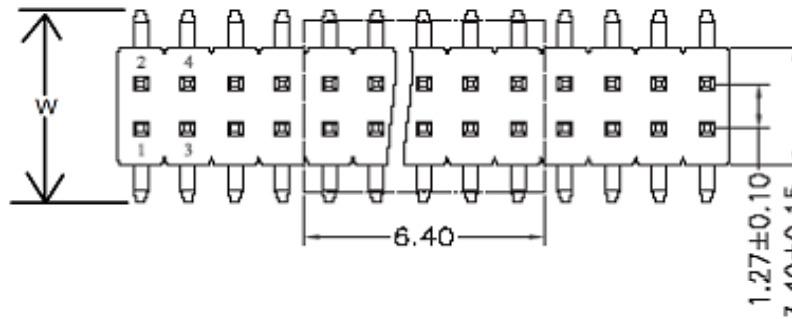
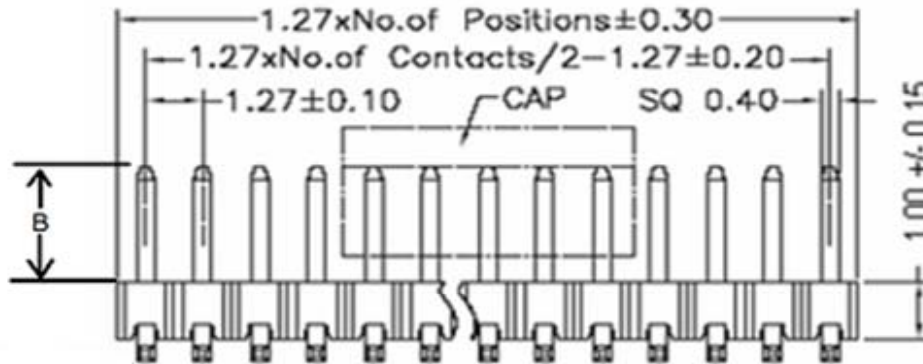

PIN Header /Dual Row / Single Body / Pitch 1,27mm	
Part No.:	T51C1059-
Customer:	

DRW:	Jason	CHKD	Wilson	MATL:	Wilson	TOLERANCE	Mason	DATE	19.07.2021
APPD:	Schumi			FINISH	Jamy		Sheet No.		1 from 4

EDCON-COMPONENTS

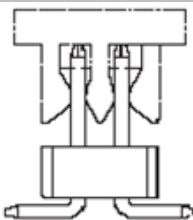

Pin Code length table free configuration (Your Pin length not in the table Please create by yourself)

Order Code	Dimension (mm)		
	B	D	W
A01	3,50	0,20	5,80
A02	1,80	2,00	5,50
A03	2,00	1,50	5,50
A04	2,30	0,20	5,50
A05	3,00	0,10	5,50
A06	2,00	0,00	5,50
A07	2,50	0,00	5,50
A08	4,00	0,00	5,50
A09	4,50	0,00	5,50
A10	5,00	0,00	5,50
A11	5,50	0,00	5,50
A12	6,00	0,00	5,50
A13	6,50	0,00	5,50
A14	7,00	0,00	5,50
A15	7,50	0,00	5,50
A16	8,00	0,00	5,50
A17	8,50	0,00	5,50
A18	9,00	0,00	5,50
A19	9,50	0,00	5,50
A20	10,00	0,00	5,50
A21	10,50	0,00	5,50
A22	11,00	0,00	5,50
A23	11,50	0,00	5,50
A24	12,00	0,00	5,50
A25	12,50	0,00	5,50
A26	13,00	0,00	5,50
A27	13,50	0,00	5,50
A28	14,00	0,00	5,50

Order Code	Dimension (mm)		
	B	D	W
A29	14,50	0,00	5,50
A30	15,00	0,00	5,50
A31	2,00	1,00	5,50
A32	2,50	1,00	5,50
A33	3,00	1,00	5,50
A34	3,50	1,00	5,50
A35	4,00	1,00	5,50
A36	4,50	1,00	5,50
A37	5,00	1,00	5,50
A38	5,50	1,00	5,50
A39	6,00	1,00	5,50
A40	6,50	1,00	5,50
A41	7,00	1,00	5,50
A42	7,50	1,00	5,50
A43	8,00	1,00	5,50
A44	8,50	1,00	5,50
A45	9,00	1,00	5,50
A46	9,50	1,00	5,50
A47	10,00	1,00	5,50
A48	10,50	1,00	5,50
A49	11,00	1,00	5,50
A50	11,50	1,00	5,50
A51	12,00	1,00	5,50
A52	12,50	1,00	5,50
A53	13,00	1,00	5,50
A54	13,50	1,00	5,50
A55	14,00	1,00	5,50
A56	14,50	1,00	5,50

Order Code	Dimension (mm)		
	B	D	W
A57	15,00	1,00	5,80
A58	2,00	2,00	5,50
A59	2,50	2,00	5,50
A60	3,00	2,00	5,50
A61	3,50	2,00	5,50
A62	4,00	2,00	5,50
A63	4,50	2,00	5,50
A64	5,00	2,00	5,50
A65	5,50	2,00	5,50
A66	6,00	2,00	5,50
A67	6,50	2,00	5,50
A68	7,00	2,00	5,50
A69	7,50	2,00	5,50
A70	8,00	2,00	5,50
A71	8,50	2,00	5,50
A72	9,00	2,00	5,50
A73	9,50	2,00	5,50
A74	10,00	2,00	5,50
A75	10,50	2,00	5,50
A76	11,00	2,00	5,50
A77	11,50	2,00	5,50
A78	12,00	2,00	5,50
A79	12,50	2,00	5,50
A80	13,00	2,00	5,50
A81	13,50	2,00	5,50
A82	14,00	2,00	5,50
A83	14,50	2,00	5,50
A84	15,00	2,00	5,50

Order Code	Dimension (mm)		
	B	D	W
A85	2,00	3,00	5,80
A86	2,50	3,00	5,50
A87	3,00	3,00	5,50
A88	3,50	3,00	5,50
A89	4,00	3,00	5,50
A90	4,50	3,00	5,50
A91	5,00	3,00	5,50
A92	5,50	3,00	5,50
A93	6,00	3,00	5,50
A94	6,50	3,00	5,50
A95	7,00	3,00	5,50
A96	7,50	3,00	5,50
A97	8,00	3,00	5,50
A98	8,50	3,00	5,50
A99	9,00	3,00	5,50
B00	9,50	3,00	5,50
B01	10,00	3,00	5,50
B02	3,00	0,30	5,50
B03	???	???	???
B04			
B05			
B06			
B07			

PIN Header /Dual Row / Single Body / Pitch 1,27mm
 Part No.: **T51C1059-**
 Customer:

DRW:	Jason	CHKD	Wilson	MATL:	Wilson	TOLERANCE	Mason	DATE	19.07.2021
APPD:	Schumi			FINISH	Jamy		Sheet No.		2 from 4

EDCON-COMPONENTS

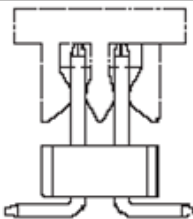

Ordering Informations

Serie	No. of Pos.	Construction	Contact Plating	Material	Special Function	Pin Length Code	ROHS	Packing		
-------	-------------	--------------	-----------------	----------	------------------	-----------------	------	---------	--	--

T51C1059-	XX	SS	G0	NY	N	A01	R	BU		
------------------	-----------	-----------	-----------	-----------	----------	------------	----------	-----------	--	--

XX = total pin of header	SS = Straight SMT	G0 = Gold Flash (Standard)	PA = Polyester 6T	N = No function	look table page 2	N =NO ROHS	BU = Bulk (Standard)
		T0 = Tin plated					NY = Nylon 6T
		GA = 10µ Gold Plating					
		GB = 15µ Gold Plating					TY = Tray packing w/o Cap
		GC = 20µ Gold Plating					TR = Tape/Reel w. pic and Place Cap
		S0 = Selectiv Plating Gold Flash / Tin					
		TN = Tin Plated					

PIN Header /Dual Row / Single Body / Pitch 1,27mm
Part No.: T51C1059-
Customer:

DRW:	Jason	CHKD	Wilson	MATL:	Wilson	TOLERANCE	Mason	DATE	19.07.2021
APPD:	Schumi			FINISH	Jamy		Sheet No.		3 from 4

www.edcon-components.com

email: info@edcon-components.com

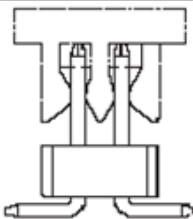

Soldering Profile for Lead Free Soldering

Classification Reflow Profile (JEDEC J-STD-020C)

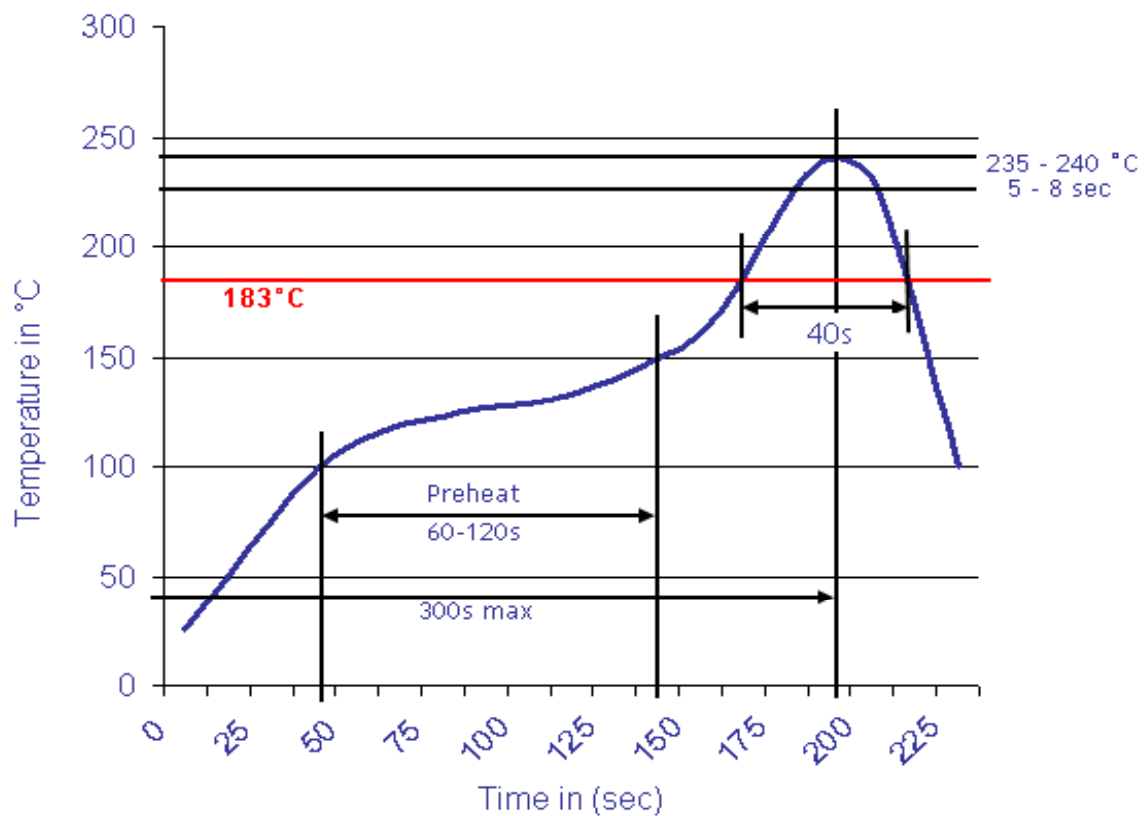

PIN Header /Dual Row / Single Body / Pitch 1,27mm	
Part No.:	T51C1059-
Customer:	

DRW:	Jason	CHKD	Wilson	MATL:	Wilson	TOLERANCE	Mason	DATE	19.07.2021
APPD:	Schumi			FINISH	Jamy		Sheet No.	4 from 4	