

# EDCON-COMPONENTS



## Specifications

### Features

- This series is UL listed under the recognized Component index file number E142814
- The plastic material used carries Underwriters Laboratory flammability recognition 94V-0
- High surge current capability
- Surge overload ratings to 300 amperes
- Terminals: Plated leads solderable per MIL-STD-202, Method 208
- Case: Molded plastic body
- Polarity symbols marked on the body

Weight 8gr.

### Maximum Ratings & Electrical Characteristics Ratings at 25°C ambient temperature

Parameter	Symbols	KBU 35005	KBU 3501	KBU 3502	KBU 3504	KBU 3506	KBU 3508	KBU 3510	Unit
Maximum reccurent peak reverse Voltage	VRRM	50	100	200	400	600	800	1000	Volt
Maximum rms Input voltage	VRMS	35	70	140	280	420	560	700	Volt
Maximum dc blocking Voltage	VDC	50	100	200	400	600	800	1000	Volt
Maximum average forward output rectified TA=100°C	I(AV)	35							Amps
Peak forward surge current 8,3ms single half sine-wave	IFSM	400							Amps
Maximum forward voltage drop	VF	1,00							Volt
Maximum revese voltage TA=25°C	IR	10							µA
Maximum revese voltage TA=125°C	IR	500							µA
Operating and storage temperature range	TJ TSTG	-55°C to + 150°C							°C
I <sup>2</sup> t rating for fusing	I <sup>2</sup> t	240							A <sup>2</sup> t
Typical thermal resistance junction to case	R 0 JA	0,8							°C/W

## Technical Drawing (Unit: inch(mm))

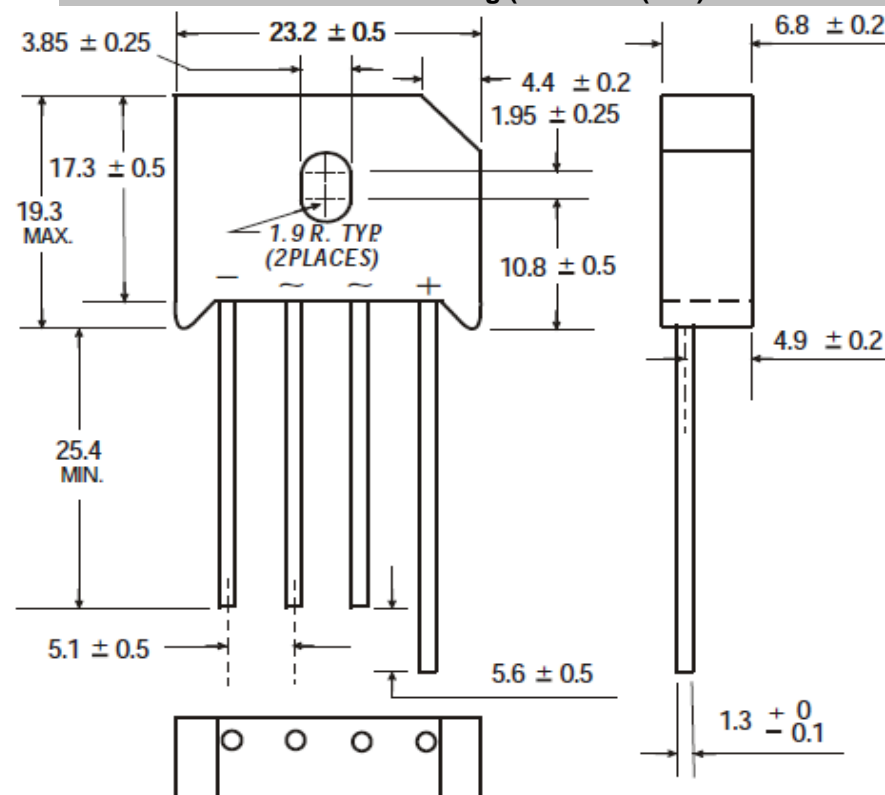

**Single In-Line Bridge Rectifier  
35A**

EDCON-Ser. **E15033**

International Serie: **KBU35xx**

DRW:	Jason	CHKD	Wilson	MATL:	Wilson	TOLERANCE	Mason	DATE	10.05.2010
APPD:	Schumi			FINISH	Jamy		Sheet No.		1 from 5

[www.edcon-components.com](http://www.edcon-components.com)

email: [info@edcon-components.com](mailto:info@edcon-components.com)



Rating & Characteristics Curves (TA=25°C unless otherwise noted)

Derating Curve for Output Rectified Current

Maximum NON Repetitive Forward Surge Current

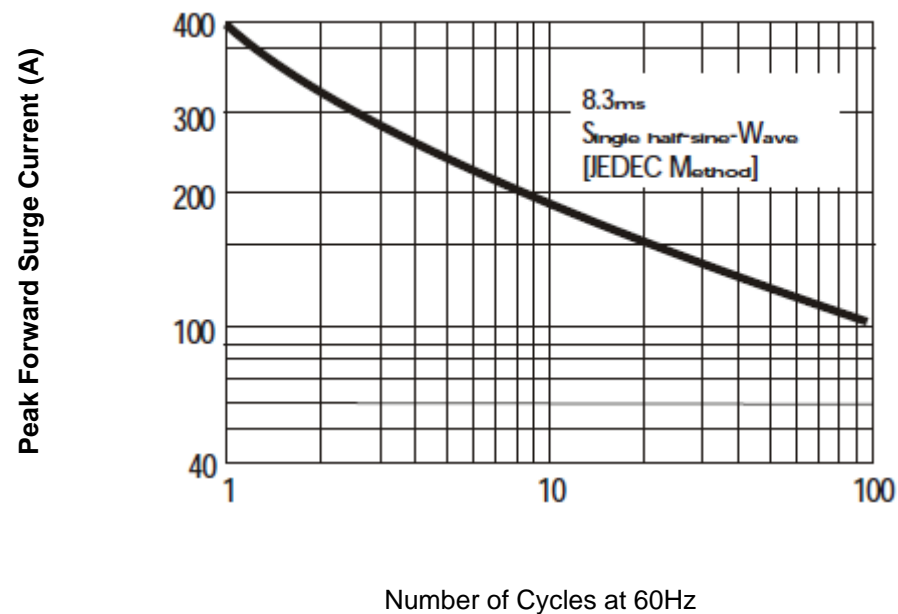
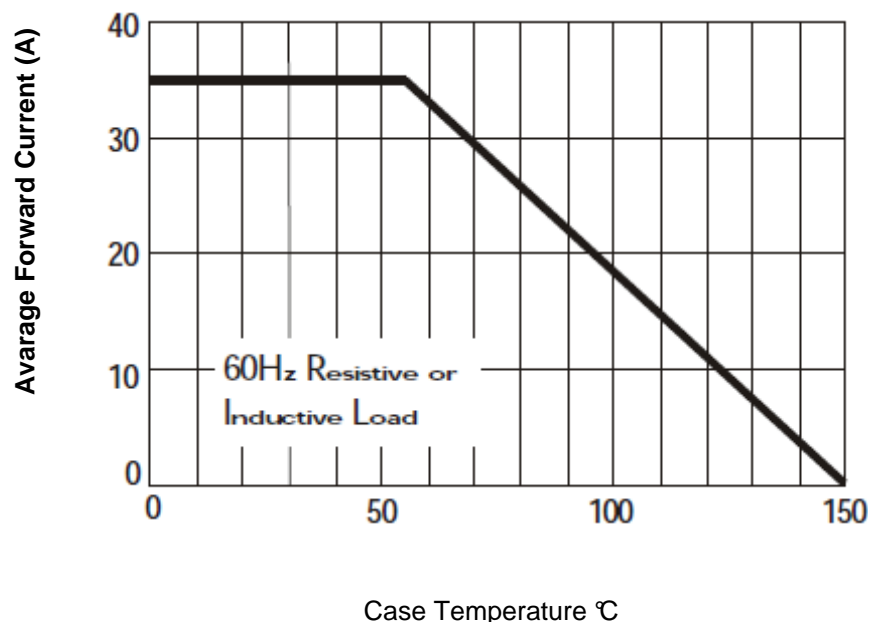

<b>Single Inline Bridge Rectifier 35A</b>	
EDCON-Ser.	<b>E15033</b>
International Serie:	<b>KBU35xx</b>

DRW:	Jason	CHKD	Wilson	MATL:	Wilson	TOLERANCE	Mason	DATE	10.05.2010
APPD:	Schumi			FINISH	Jamy		Sheet No.	2 from 5	



Rating & Characteristics Curves (TA=25°C unless otherwise noted)

Typical Forward Characteristics

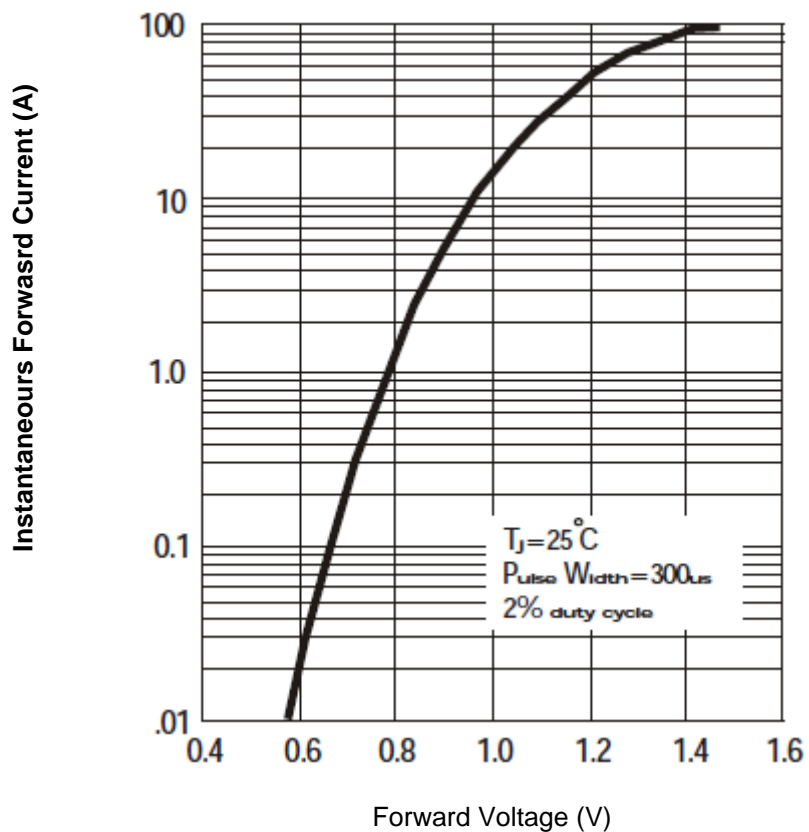

Typical Reverse Characteristics

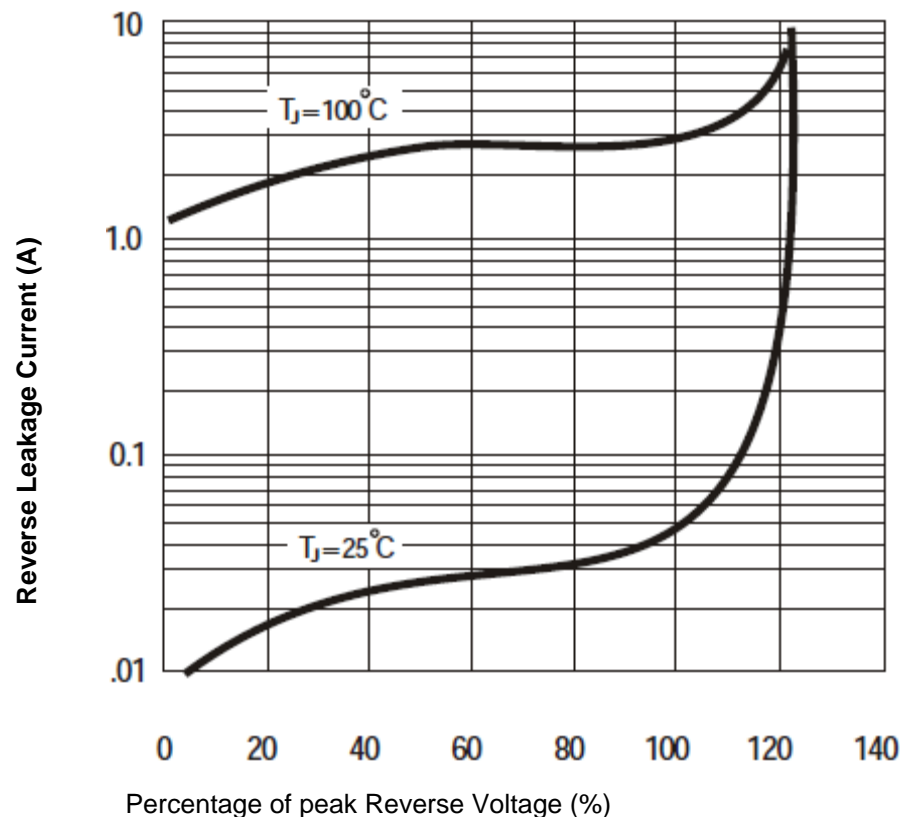

<b>Single In-line Bridge Rectifier 35A</b>	
EDCON-Ser.	<b>E15033</b>
International Serie:	<b>KBU35xx</b>

DRW:	Jason	CHKD	Wilson	MATL:	Wilson	TOLERANCE	Mason	DATE	10.05.2010
APPD:	Schumi			FINISH	Jamy		Sheet No.		3 from 5

# EDCON-COMPONENTS



Rating & Characteristics Curves (TA=25°C unless otherwise noted)

## Ordering Informations

EDCON Serie	International Type	Lead information	ROHS	Package					
<b>E15033</b>	<b>KBU35xx</b>	<b>LL</b>	<b>R</b>	<b>BX</b>					

Look Voltage Code Table	<b>LL</b> = Long Lead	<b>R</b> = ROHS Conform	<b>BX</b> = Box
	<b>L4</b> = Lead length 4mm	<b>N</b> = NON ROHS Conform	

<b>Single Inline Bridge Rectifier 35A</b>	
EDCON-Ser.	<b>E15033</b>
International Serie:	<b>KBU35xx</b>

DRW:	Jason	CHKD	Wilson	MATL:	Wilson	TOLERANCE	Mason	DATE	10.05.2010
APPD:	Schumi			FINISH	Jamy		Sheet No.	4 from 5	



Soldering Profile Curve

Classification Reflow Profile (JEDEC J-STD-020C)

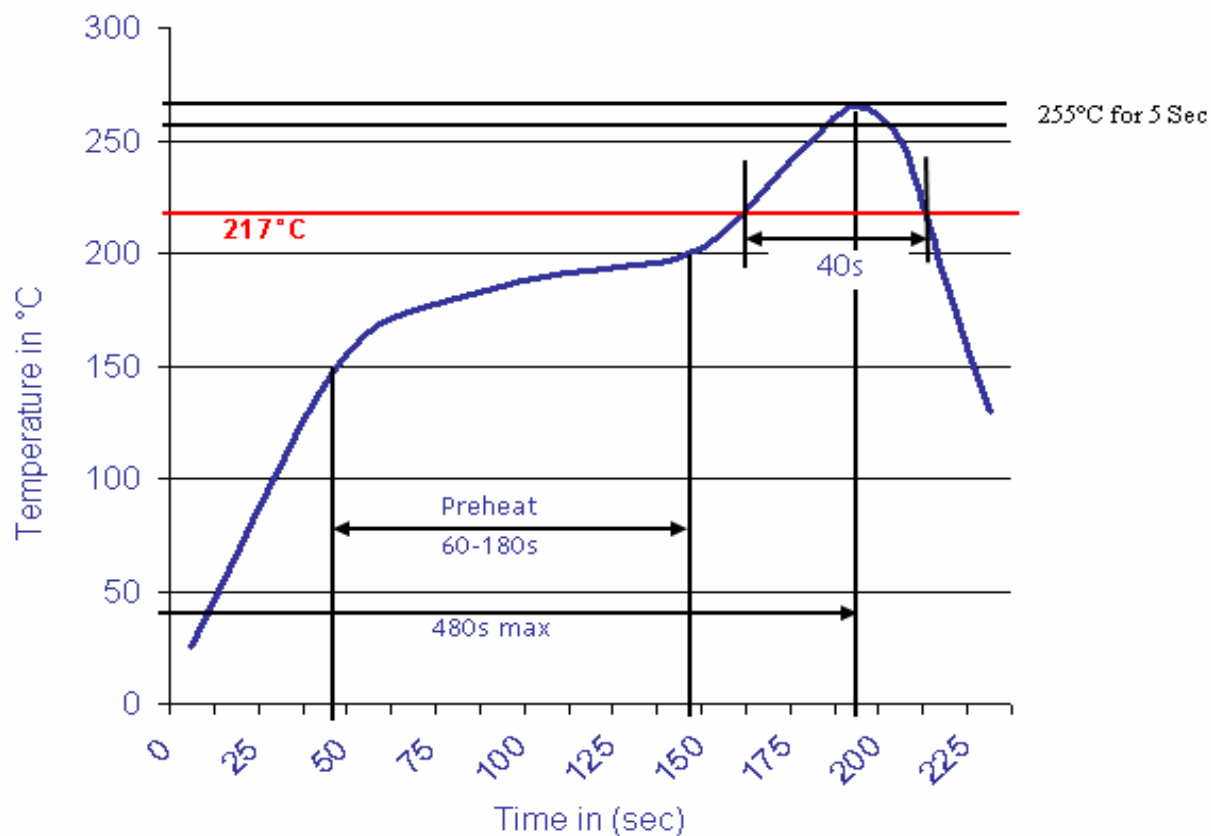

<b>Single In-line Bridge Rectifier 35A</b>	
EDCON-Ser.	<b>E15033</b>
International Serie:	<b>KBU35xx</b>

DRW:	Jason	CHKD	Wilson	MATL:	Wilson	TOLERANCE	Mason	DATE	10.05.2010
APPD:	Schumi			FINISH	Jamy		Sheet No.	5 from 5	