

EDCON-COMPONENTS



Specifications

Features

- This series is UL listed under the recognized Component index file number E142814
- The plastic material used carries Underwriters Laboratory flammability recognition 94V-0
- High surge current capability
- Surge overload ratings to 300 amperes
- Terminals: Plated leads solderable per MIL-STD-202, Method 208
- Case: Molded plastic body
- Polarity symbols marked on the body

Weight 8gr.

Maximum Ratings & Electrical Characteristics Ratings at 25°C ambient temperature

| Parameter | Symbols | KBU 15005 | KBU 1501 | KBU 1502 | KBU 1504 | KBU 1506 | KBU 1508 | KBU 1510 | Unit |
|---|------------|------------------|----------|----------|----------|----------|----------|----------|------|
| Maximum reeurrent peak reverse Voltage | VRRM | 50 | 100 | 200 | 400 | 600 | 800 | 1000 | Volt |
| Maximum rms Input voltage | VRMS | 35 | 70 | 140 | 280 | 420 | 560 | 700 | Volt |
| Maximum dc blocking Voltage | VDC | 50 | 100 | 200 | 400 | 600 | 800 | 1000 | Volt |
| Maximum average forward output rectified TA=100°C | I(AV) | 15 | | | | | | | Amps |
| Peak forward surge current 8,3ms single half sine-wave | IFSM | 300 | | | | | | | Amps |
| Maximum forward voltage drop | VF | 1,00 | | | | | | | Volt |
| Maximum revese voltage TA=25°C | IR | 10 | | | | | | | µA |
| Maximum revese voltage TA=125°C | IR | 500 | | | | | | | µA |
| Operating and storage temperature range | TJ TSTG | -55°C to + 150°C | | | | | | | °C |
| I²t rating for fusing | I²t | 300 | | | | | | | A²t |
| Typical thermal resistance junction to case | R 0 JA | 2,7 | | | | | | | °C/W |

Technical Drawing (Unit: inch(mm))

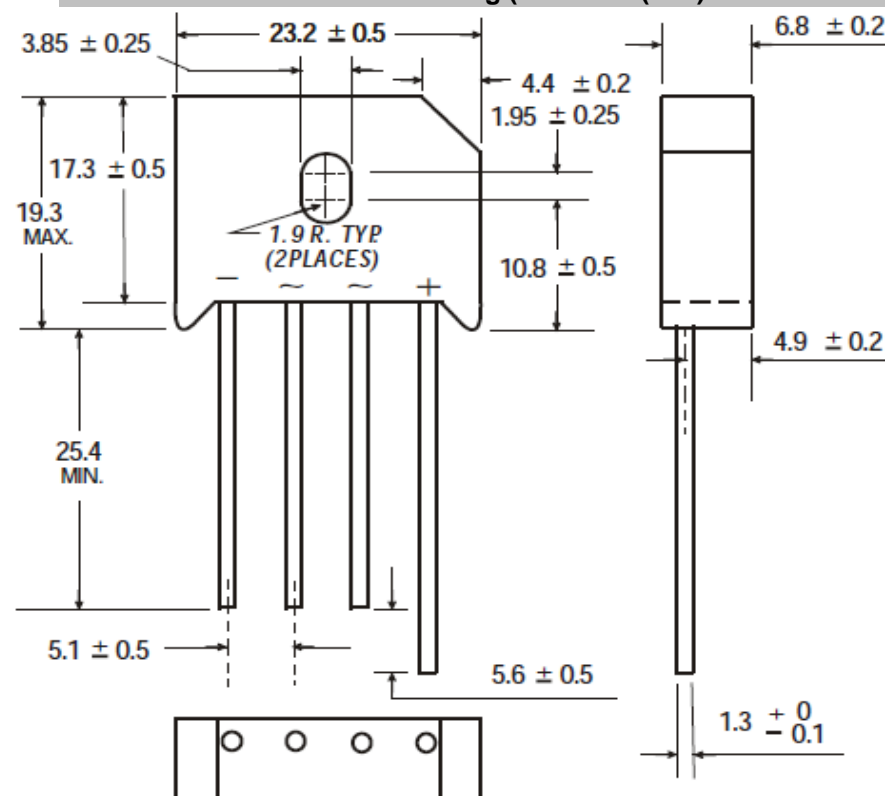

**Single In-Line Bridge Rectifier
15A**

EDCON-Ser. **E15027**

International Serie: **KBU15xx**

| | | | | | | | | | |
|-------|--------|------|--------|--------|--------|-----------|-----------|------|------------|
| DRW: | Jason | CHKD | Wilson | MATL: | Wilson | TOLERANCE | Mason | DATE | 10.05.2010 |
| APPD: | Schumi | | | FINISH | Jamy | | Sheet No. | | 1 from 5 |

www.edcon-components.com

email: info@edcon-components.com



Rating & Characteristics Curves (TA=25°C unless otherwise noted)

Derating Curve for Output Rectified Current

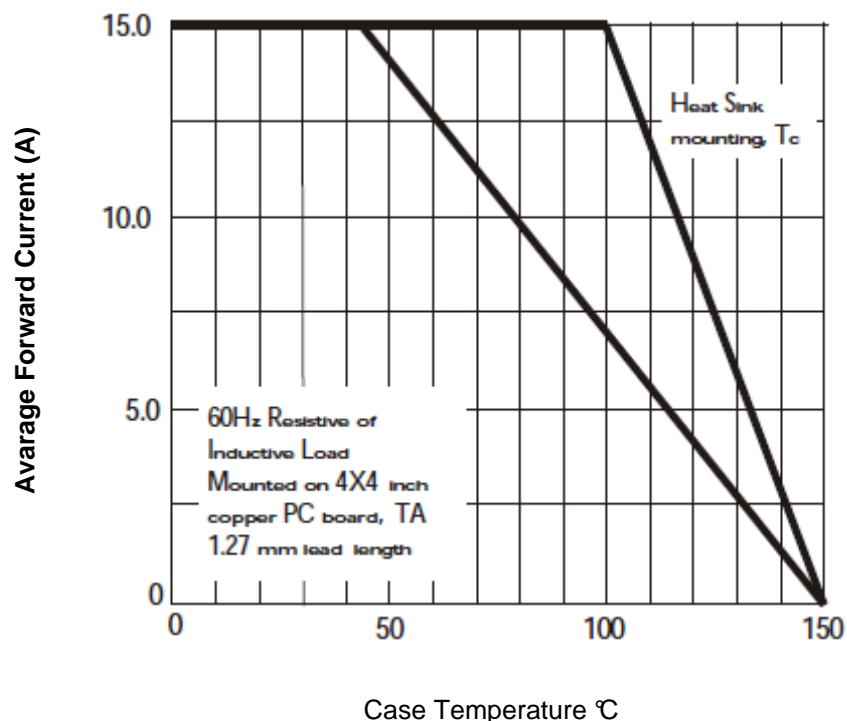

Maximum NON Repetitive Forward Surge Current

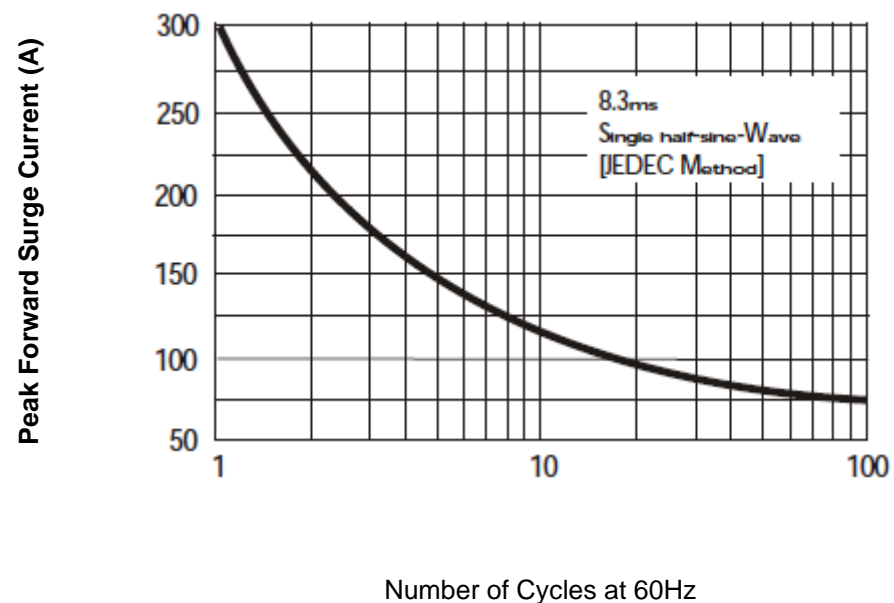

**Single Inline Bridge Rectifier
15A**

EDCON-Ser. **E15027**

International Serie: **KBU15xx**

| | | | | | | | | | |
|-------|--------|------|--------|--------|--------|-----------|-----------|----------|------------|
| DRW: | Jason | CHKD | Wilson | MATL: | Wilson | TOLERANCE | Mason | DATE | 10.05.2010 |
| APPD: | Schumi | | | FINISH | Jamy | | Sheet No. | 2 from 5 | |



Rating & Characteristics Curves (TA=25°C unless otherwise noted)

Typical Forward Characteristics

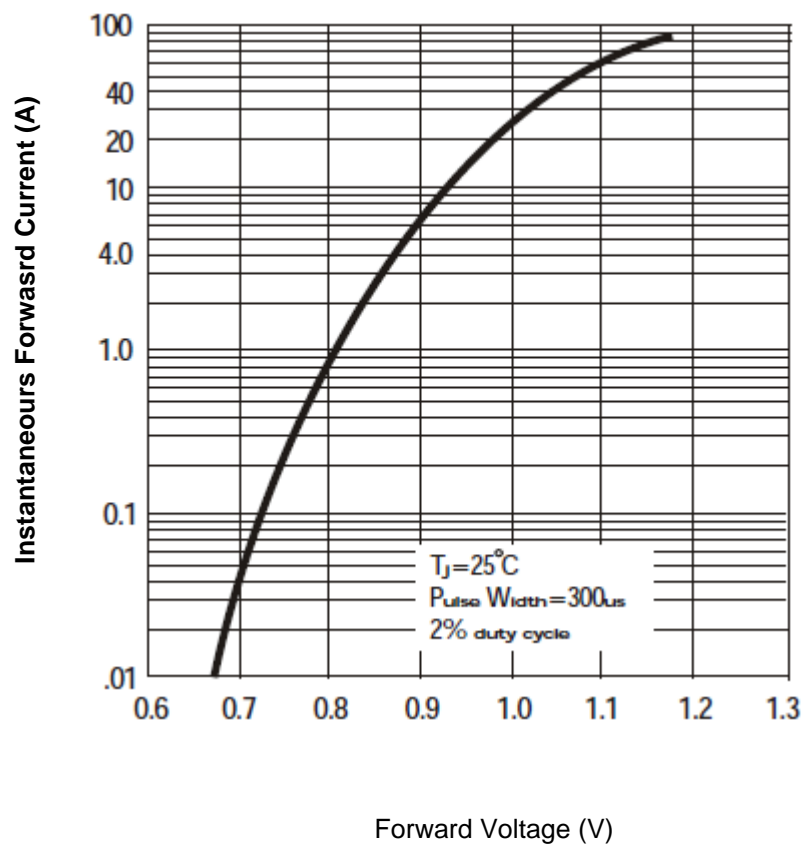

Typical Reverse Characteristics

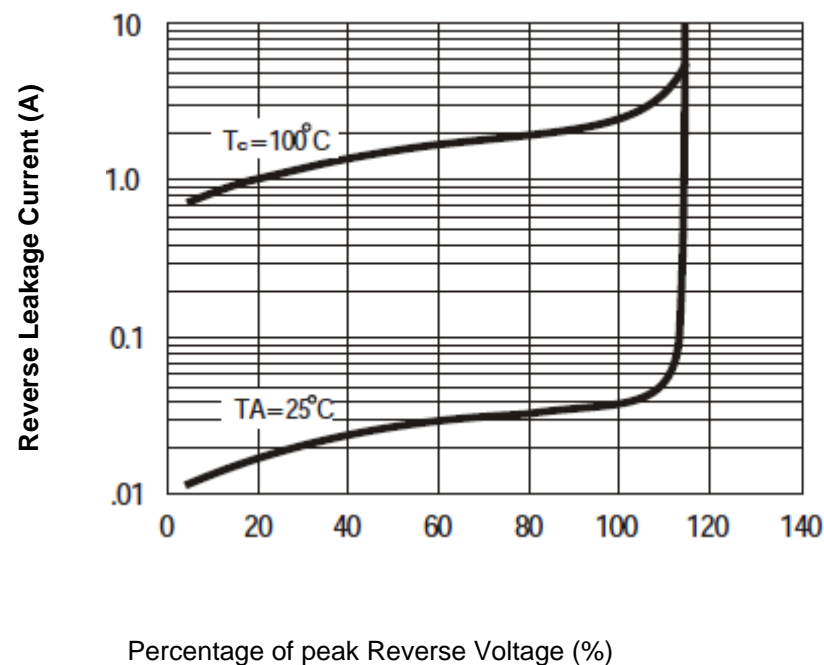

| | |
|--|----------------|
| Single In-line Bridge Rectifier 15A | |
| EDCON-Ser. | E15027 |
| International Serie: | KBU15xx |

| | | | | | | | | | |
|-------|--------|------|--------|--------|--------|-----------|-----------|------|------------|
| DRW: | Jason | CHKD | Wilson | MATL: | Wilson | TOLERANCE | Mason | DATE | 10.05.2010 |
| APPD: | Schumi | | | FINISH | Jamy | | Sheet No. | | 3 from 5 |

EDCON-COMPONENTS



Rating & Characteristics Curves (TA=25°C unless otherwise noted)

Forward Current Derating Curve

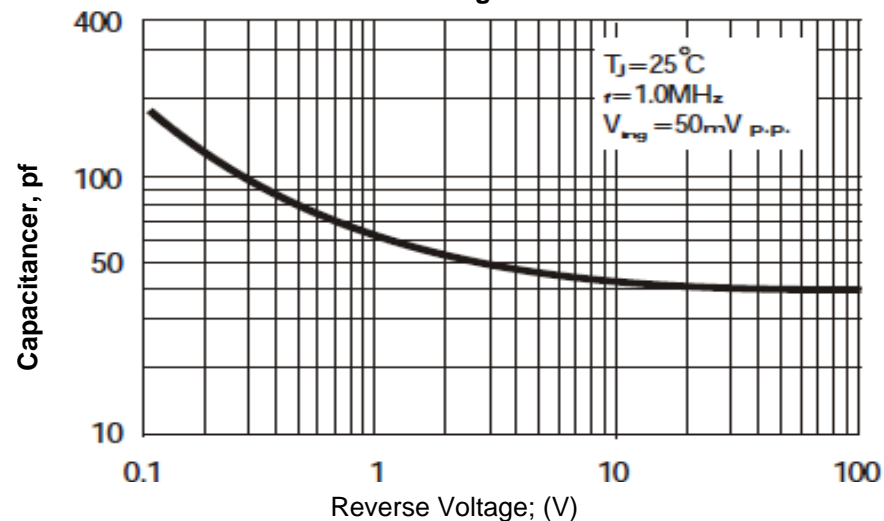

Ordering Informations

| | | | | | | | | | |
|---------------|--------------------|------------------|----------|-----------|--|--|--|--|--|
| EDCON Serie | International Type | Lead information | ROHS | Package | | | | | |
| E15027 | KBU15xx | LL | R | BX | | | | | |

| | | | |
|-------------------------|-----------------------------|-----------------------------|-----------------|
| Look Voltage Code Table | LL = Long Lead | R = ROHS Conform | BX = Box |
| | L4 = Lead length 4mm | N = NON ROHS Conform | |

| | |
|---|----------------|
| Single Inline Bridge Rectifier 15A | |
| EDCON-Ser. | E15027 |
| International Serie: | KBU15xx |

| | | | | | | | | | |
|-------|--------|------|--------|--------|--------|-----------|-----------|------|------------|
| DRW: | Jason | CHKD | Wilson | MATL: | Wilson | TOLERANCE | Mason | DATE | 10.05.2010 |
| APPD: | Schumi | | | FINISH | Jamy | | Sheet No. | | 4 from 5 |



Soldering Profile Curve

Classification Reflow Profile (JEDEC J-STD-020C)



| | |
|--|----------------|
| Single In-line Bridge Rectifier 15A | |
| EDCON-Ser. | E15027 |
| International Serie: | KBU15xx |

| | | | | | | | | | |
|-------|--------|------|--------|--------|--------|-----------|-----------|----------|------------|
| DRW: | Jason | CHKD | Wilson | MATL: | Wilson | TOLERANCE | Mason | DATE | 10.05.2010 |
| APPD: | Schumi | | | FINISH | Jamy | | Sheet No. | 5 from 5 | |