

# EDCON-COMPONENTS

## 16VA Standard PCB Encapsulated -Transformer

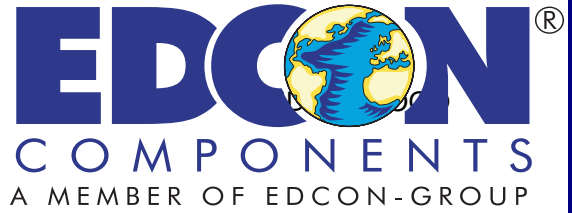

### Technical specifications

Power from 0,6VA to 36VA  
 Dielectric Strength - 3750 Vrms  
 High ambient operation temperature (+75°C)  
 Primary ( 115V 60HZ / 230V/50Hz )  
 Secondary Single or Dual Output  
 Insulation Class - Class B ( 130°C )  
 Safety Approvals VDE / CE

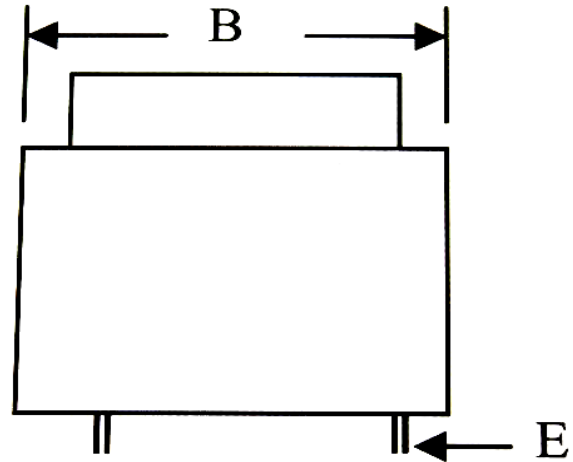

### Technical drawing

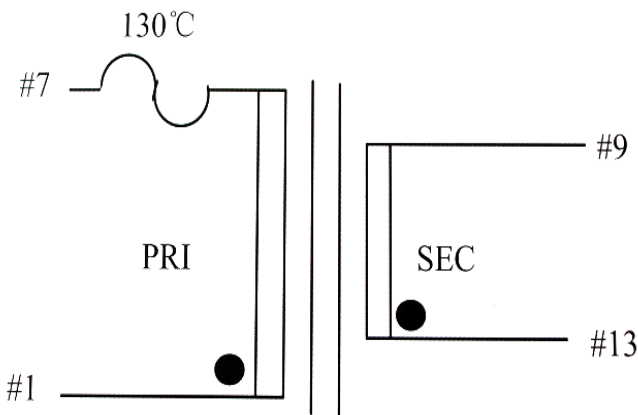
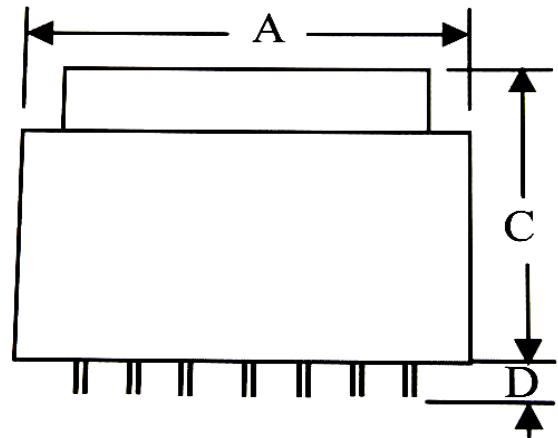
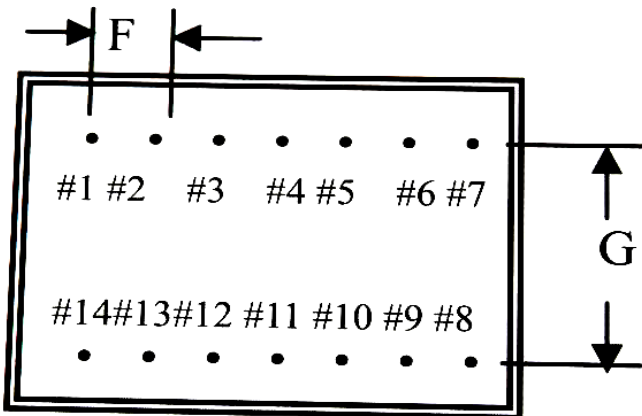

Single Output

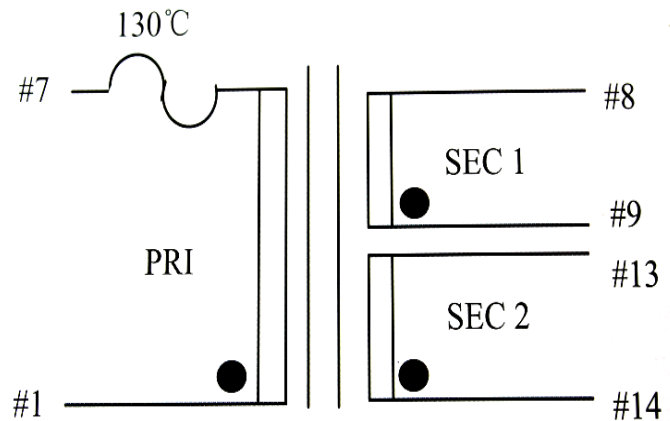

Dual Output

Standard PCB Encapsulated Transformer

# EDCON-COMPONENTS

## 16VA Standard PCB Encapsulated -Transformer

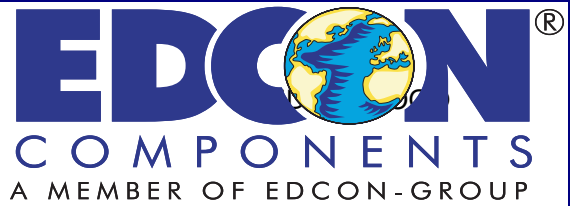

### Technical specifications

Power from 0,6VA to 36VA  
 Dielectric Strength - 3750 Vrms  
 High ambient operation temperature (+75°C)  
 Primary ( 115V 60HZ / 230V/50Hz )  
 Secondary Single or Dual Output  
 Insulation Class - Class B ( 130°C )  
 Safety Approvals VDE / CE

### Technical drawing

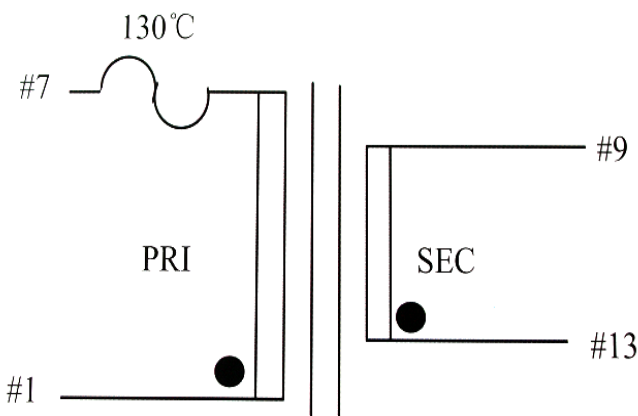
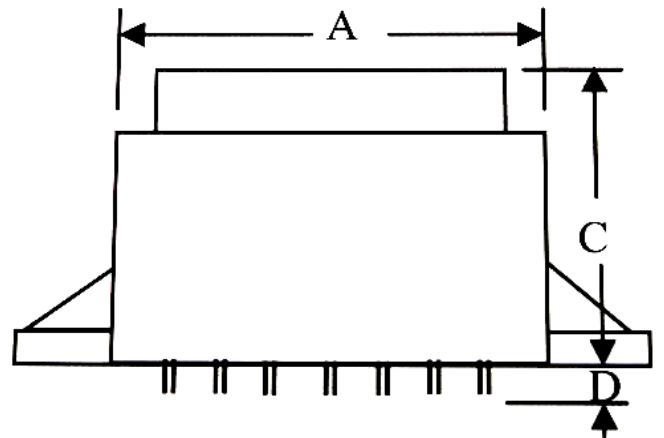
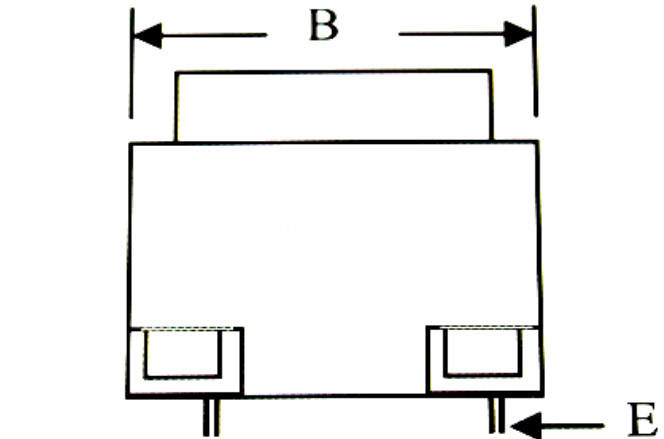
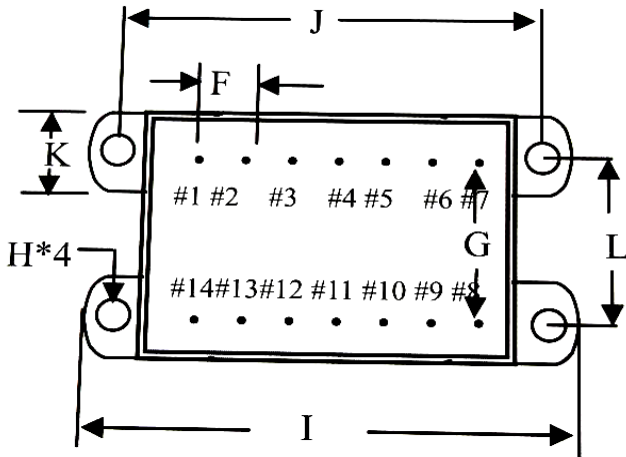

Single Output

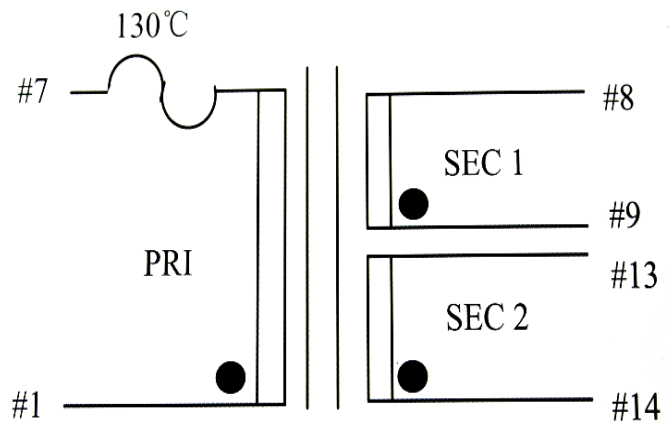

Dual Output

Standard PCB Encapsulated Transformer

# EDCON-COMPONENTS

## 16VA Standard PCB Encapsulated -Transformer

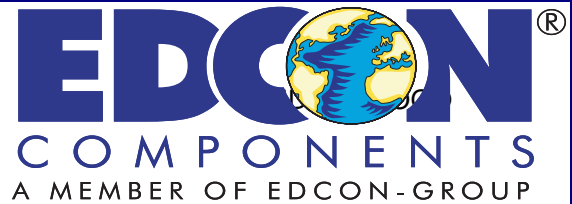

### Technical dimensions

Serie	Dimensions (mm)						
	A	B	C	D	E	F	G
<b>16 (VA)</b>	58,5	49,5	40,0	4,0	0,8	5,0	30,0
Toler. (mm)	Max.	Max.	Max.	.+/-1,0	.+/-0,1	.+/-0,2	.+/-0,5
	H	I	J	K	L		
	4,2	76,5	65,0	10,0	37,5		
Toler. (mm)	.+/-0,2	Max.	.+/-0,5	.+/-0,5	.+/-0,5		

### Ordering Informations

Serie	Core	Output Layer	Output Voltage	Mounting Ear
<b>V11048</b>	<b>54</b>	<b>D</b>	<b>060</b>	<b>M</b>

<b>D</b> = Single Output for 230VAC	<b>060</b> = 6V <b>072</b> = 7,2V <b>090</b> = 9V <b>100</b> = 10V	Empty W/O Mounting ear
<b>DS</b> = Single Output for 115VAC	<b>120</b> = 12V <b>150</b> = 15V <b>180</b> = 18V <b>240</b> = 24V	<b>M</b> = with Mounting ears

2x6V = 2x1333mA  
 2x7,2V = 2x1111mA  
 2x9V = 2x888mA  
 2x10V = 2x800mA  
 2x12V = 2x666mA  
 2x15V = 2x533mA  
 2x18V = 2x444mA  
 2x24V = 2x333mA

Standard PCB Encapsulated Transformer