

EDCON-COMPONENTS

23VA Standard PCB Encapsulated -Transformer

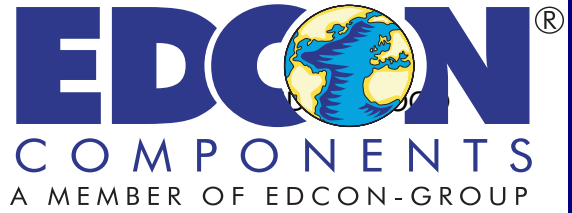

Technical specifications

Power from 0,6VA to 36VA
 Dielectric Strength - 3750 Vrms
 High ambient operation temperature (+75°C)
 Primary (115V 60HZ / 230V/50Hz)
 Secondary Single or Dual Output
 Insulation Class - Class B (130°C)
 Safety Approvals VDE / CE

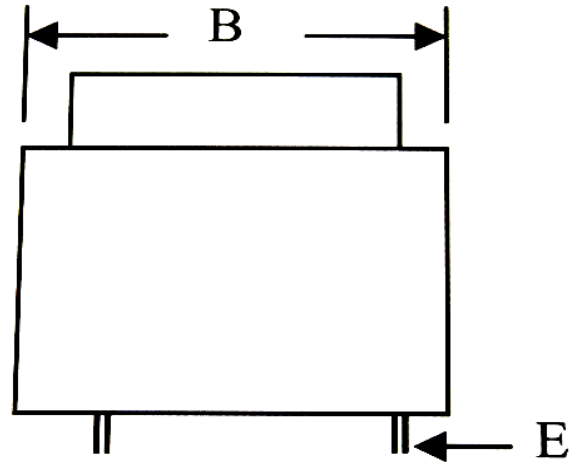

Technical drawing

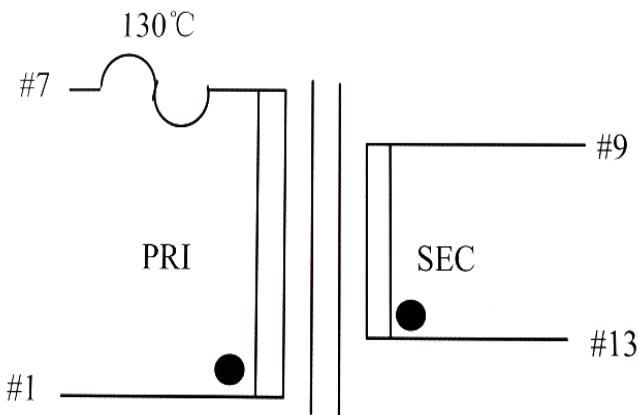
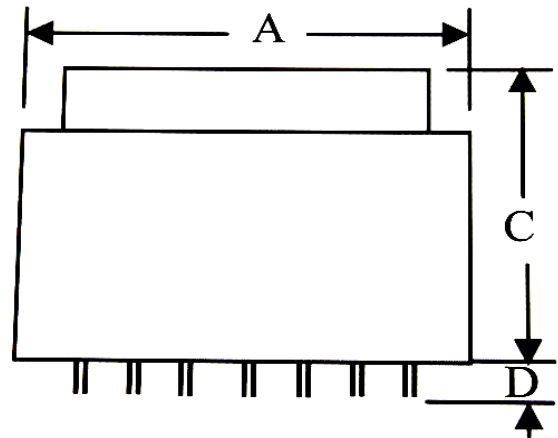
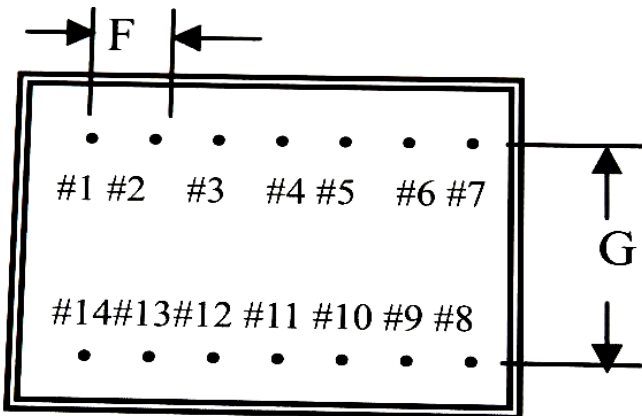

Single Output

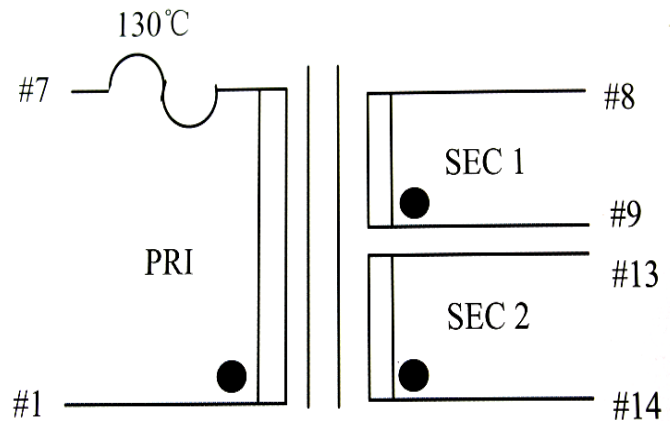

Dual Output

Standard PCB Encapsulated Transformer

EDCON-COMPONENTS

23VA Standard PCB Encapsulated -Transformer

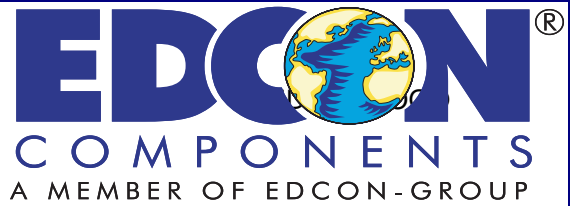

Technical specifications

Power from 0,6VA to 36VA
 Dielectric Strength - 3750 Vrms
 High ambient operation temperature (+75°C)
 Primary (115V 60HZ / 230V/50Hz)
 Secondary Single or Dual Output
 Insulation Class - Class B (130°C)
 Safety Approvals VDE / CE

Technical drawing

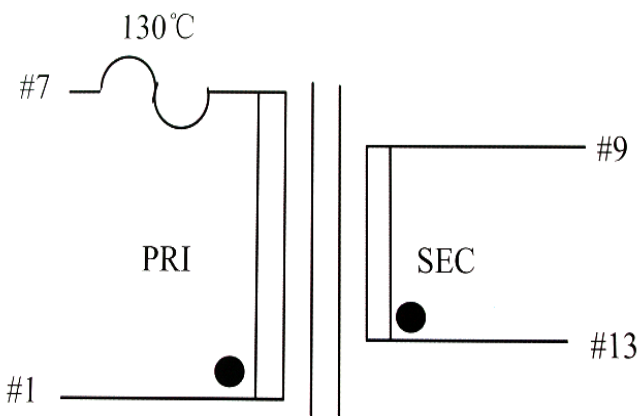
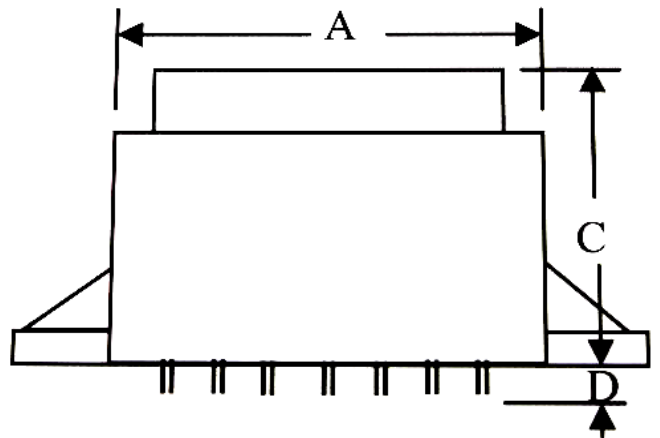
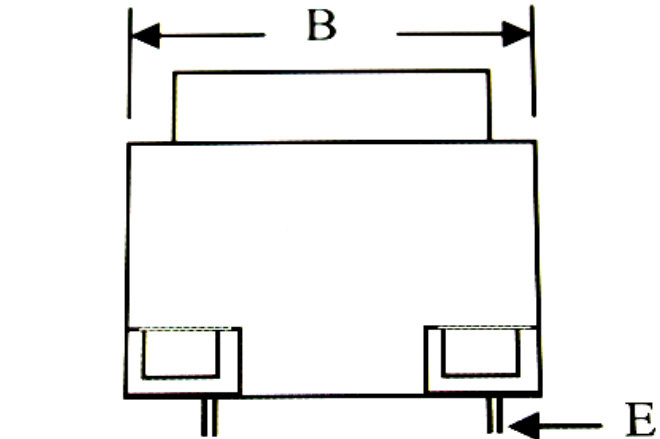
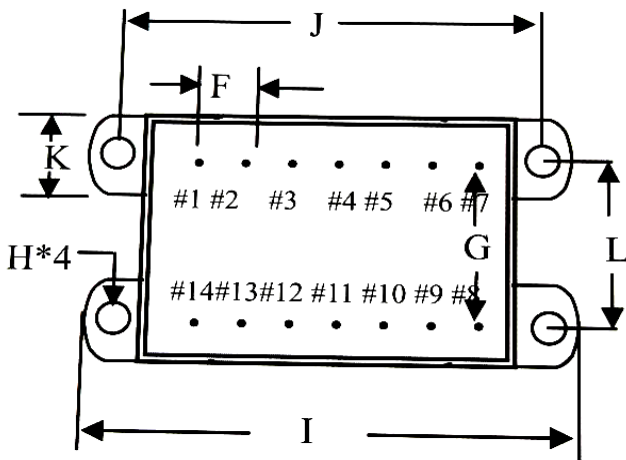

Single Output

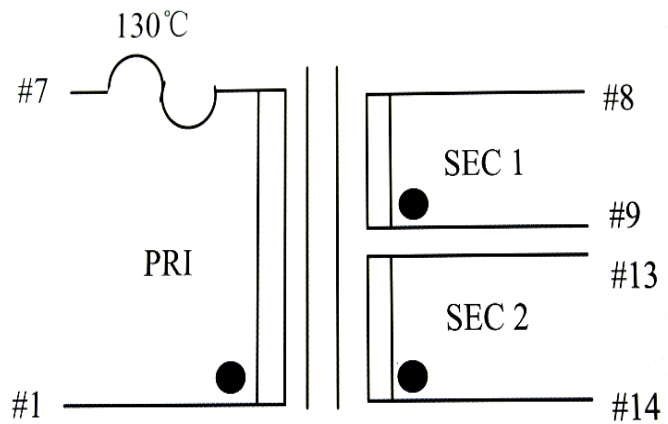

Dual Output

Standard PCB Encapsulated Transformer

EDCON-COMPONENTS

23VA Standard PCB Encapsulated -Transformer

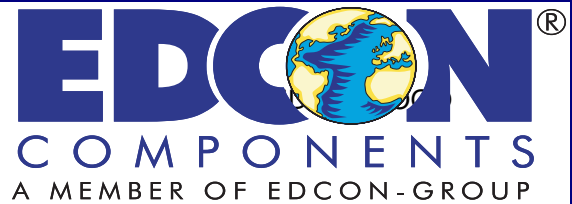

Technical dimensions

Serie	Dimensions (mm)						
	A	B	C	D	E	F	G
23 (VA)	54,0	49,5	45,0	4,0	0,8	5,0	30,0
Toler. (mm)	Max.	Max.	Max.	.+/-1,0	.+/-0,1	.+/-0,2	.+/-0,5
	H	I	J	K	L		
	4,2	76,5	65,0	10,0	37,5		
Toler. (mm)	.+/-0,2	Max.	.+/-0,5	.+/-0,5	.+/-0,5		

Ordering Informations

Serie	Core	Output Layer	Output Voltage	Mounting Ear
V11022	60	S	060	M

S = Single Output for 230VAC	060 = 6V 072 = 7,2V 090 = 9V 100 = 10V	Empty W/O Mounting ear
US = Single Output for 115VAC	120 = 12V 150 = 15V 180 = 18V 240 = 24V	M = with Mounting ears

6V = 3833mA
 7,2V = 3194mA
 9V = 2555mA
 10V = 2300mA
 12V = 1916mA
 15V = 1533mA
 18V = 1277mA
 24V = 958mA

Standard PCB Encapsulated Transformer