

EDCON-COMPONENTS

16VA Standard PCB Encapsulated -Transformer

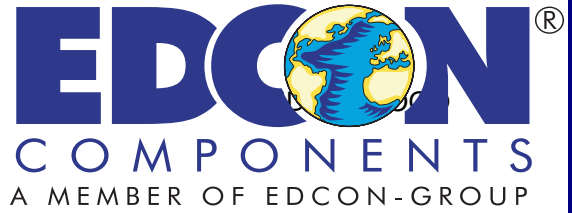

Technical specifications

Power from 0,6VA to 36VA
 Dielectric Strength - 3750 Vrms
 High ambient operation temperature (+75°C)
 Primary (115V 60HZ / 230V/50Hz)
 Secondary Single or Dual Output
 Insulation Class - Class B (130°C)
 Safety Approvals VDE / CE

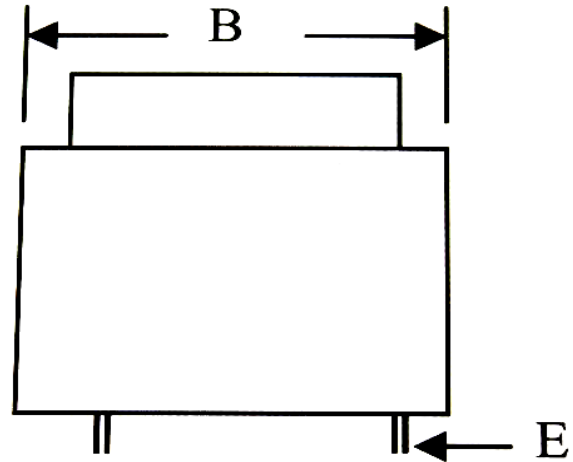

Technical drawing

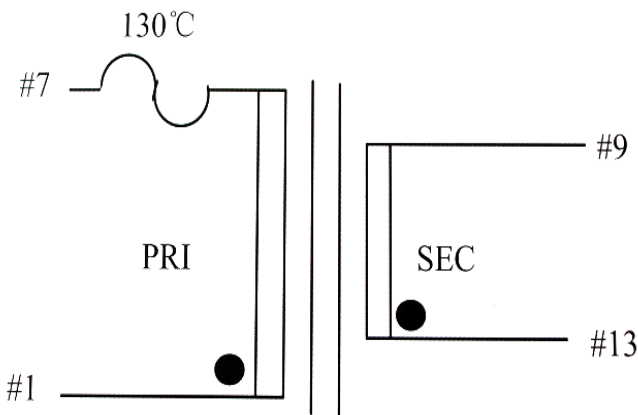
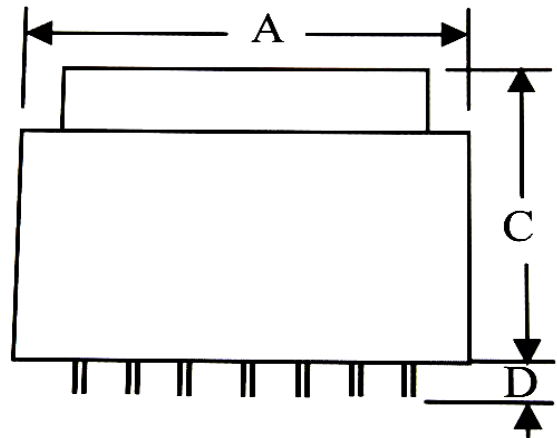
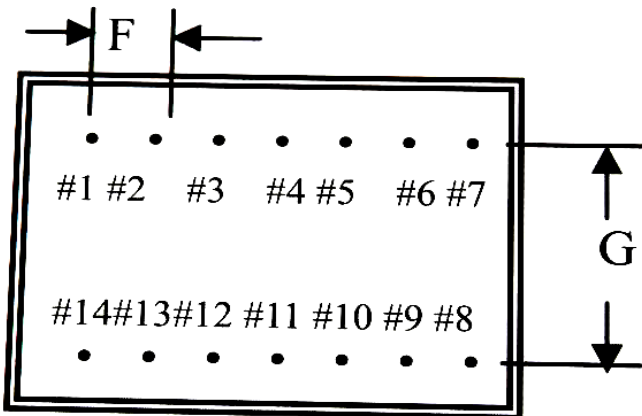

Single Output

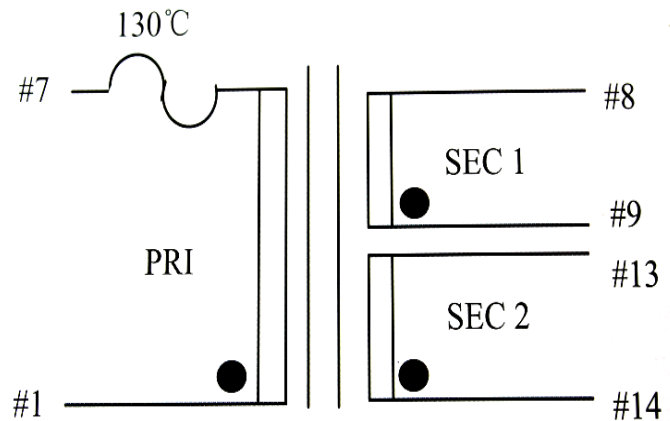

Dual Output

Standard PCB Encapsulated Transformer

EDCON-COMPONENTS

16VA Standard PCB Encapsulated -Transformer

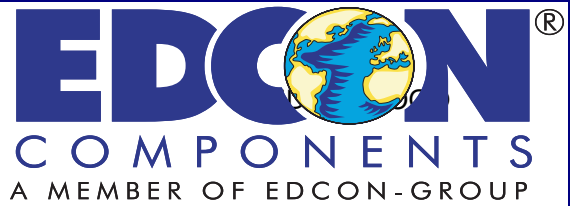

Technical specifications

Power from 0,6VA to 36VA
 Dielectric Strength - 3750 Vrms
 High ambient operation temperature (+75°C)
 Primary (115V 60HZ / 230V/50Hz)
 Secondary Single or Dual Output
 Insulation Class - Class B (130°C)
 Safety Approvals VDE / CE

Technical drawing

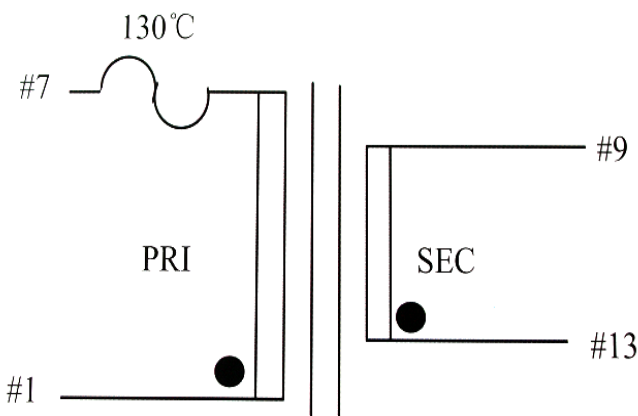
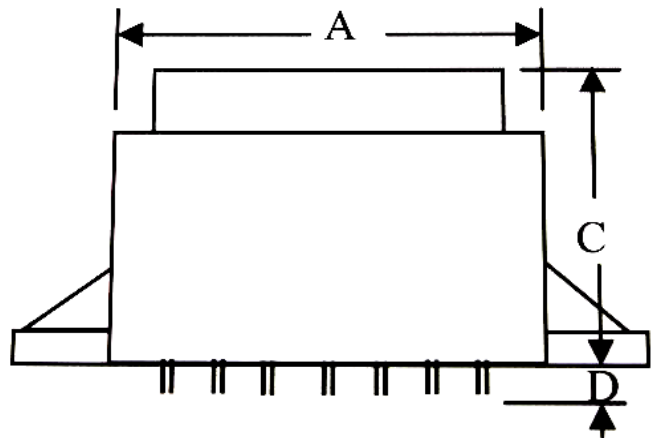
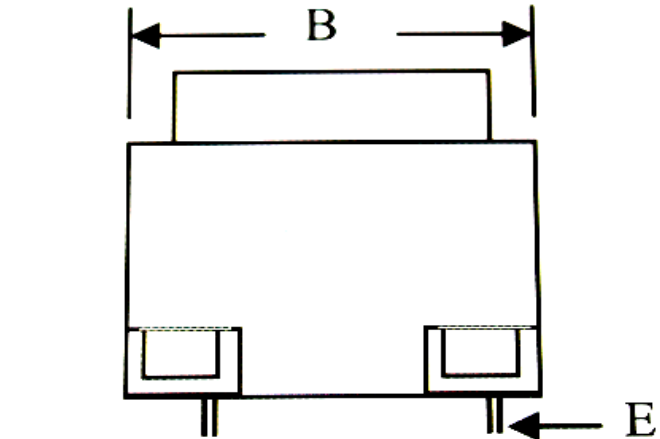
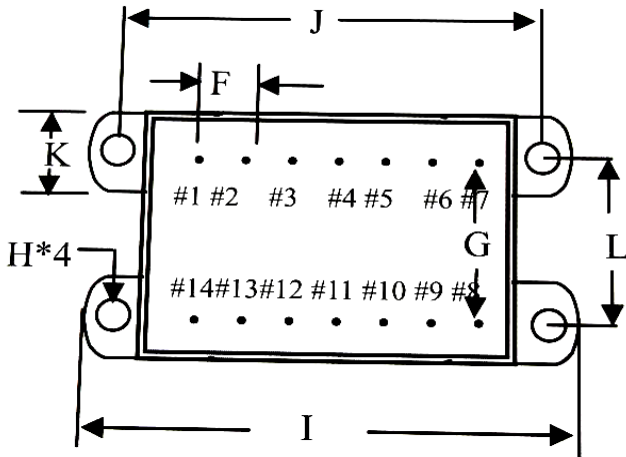

Single Output

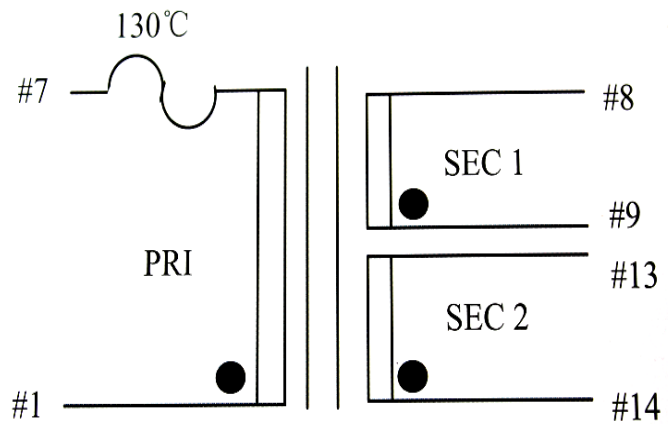

Dual Output

Standard PCB Encapsulated Transformer

EDCON-COMPONENTS

16VA Standard PCB Encapsulated -Transformer

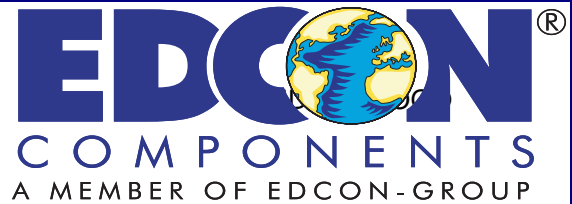

Technical dimensions

| Serie | Dimensions (mm) | | | | | | |
|----------------|-----------------|------|---------|---------|---------|---------|---------|
| | A | B | C | D | E | F | G |
| 16 (VA) | 51,0 | 43,0 | 39,0 | 4,0 | 0,8 | 5,0 | 27,5 |
| Toler. (mm) | Max. | Max. | Max. | .+/-1,0 | .+/-0,1 | .+/-0,2 | .+/-0,5 |
| | H | I | J | K | L | | |
| | 4,2 | 76,5 | 65,0 | 10,0 | 37,5 | | |
| Toler. (mm) | .+/-0,2 | Max. | .+/-0,5 | .+/-0,5 | .+/-0,5 | | |

Ordering Informations

| Serie | Core | Output Layer | Output Voltage | Mounting Ear |
|---------------|-----------|--------------|----------------|--------------|
| V11019 | 48 | S | 060 | M |

| | | |
|--------------------------------------|--|-------------------------------|
| S = Single Output for 230VAC | 060 = 6V 072 = 7,2V 090 = 9V 100 = 10V | Empty W/O Mounting ear |
| US = Single Output for 115VAC | 120 = 12V 150 = 15V 180 = 18V 240 = 24V | M = with Mounting ears |

| |
|---------------|
| 6V = 2666mA |
| 7,2V = 2222mA |
| 9V = 1777mA |
| 10V = 1600mA |
| 12V = 1333mA |
| 15V = 1066mA |
| 18V = 888mA |
| 24V = 666mA |

Standard PCB Encapsulated Transformer