





**Specifications**

| <i>Electrical</i>               |                |                |
|---------------------------------|----------------|----------------|
| Impedance                       |                | 50 Ω           |
| Frequency Range                 |                | 0 - 10 GHz     |
| Working Voltage                 |                | 500 VRMS max.  |
| Dielectric Withstanding Voltage |                | 1500 VRMS min. |
| VSWR                            | Straight       | 1.3 max.       |
|                                 | Right Angle    | 1.5 max.       |
| Contact Resistance              | Center Contact | 3 mΩ max.      |
|                                 | Outer Contact  | 2 mΩ max.      |
| Insulator Resistance            |                | 5000 MΩ min.   |

| <i>Material</i>   |  |  |
|-------------------|--|--|
| Parts Name        | Material   | Finish                                     |
| Body, Metal Parts | Brass per QQ-B-626   | Nickel 70 micro-inches                     |
| Center Contacts   | Male: Brass per QQ-B-626<br>Female: Phosphor Bronze per QQ-C-750 | Gold 3 micro-inches<br>Gold 3 micro-inches |
| Insulators        | Teflon, Delrin   | None                                       |
| Crimp Ferrules    | Annealed Brass   | Nickel 70 micro-inches                     |
| Clamp Gaskets     | Silicone rubber  | None                                       |

| <i>Mechanical &amp; Environmental</i> |                                     |
|---------------------------------------|-------------------------------------|
| Engagement Force                      | 2 in-lbs. max.                      |
| Disengagement Force                   | 2 in-lbs. max.                      |
| Coupling Nut Retention                | 100 lbs. min.                       |
| Coupling Proof Torque                 | 15 in-lbs. Min.                     |
| Contact Retention                     | 6 lbs. min.                         |
| Durability (Mating)                   | 500 cycles                          |
| Temperature Range                     | -65°C ~ 165°C                       |
| Vibration                             | MIL-STD-202 Method 204 Test Cond. B |
| Salt Spray                            | MIL-STD-202 Method 101 Test Cond. B |
| Thermal Shock                         | MIL-STD-202 Method 107 Test Cond. B |

**Cable, Crimp  
 TNC Reverse Polarity**

Part No.: **T55W1021**

Customer:

|       |      |      |       |        |      |       |            |
|-------|------|------|-------|--------|------|-------|------------|
| DRW:  | Dong | CHKD | Chang | MATL:  | Chui | DATE  | 11.05.2010 |
| APPD: | Ping |      |       | FINISH | Hui  | Sheet | 2 from 3   |



**Technical Drawing**

7/16-28UNEF-2A

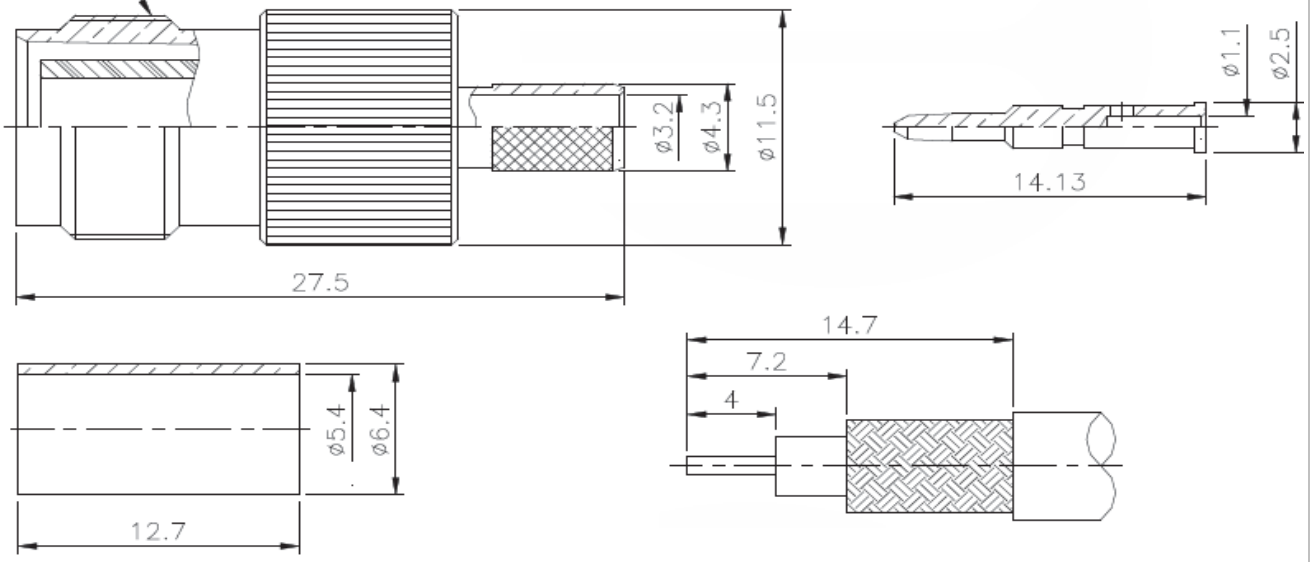

**Odering Information**

| Serie       | - | Cable Group                | Impedance    | No Function | RoHS  | Packing   |
|-------------|---|----------------------------|--------------|-------------|---|---|
| T55W1021    | - | A1                         | 50           | XX          | R   | BU  |
| EDCON-Serie | - | A1<br>= 58/U, 58A/U, 58C/U | 50<br>= 50 Ω | XX          | N<br>= no RoHS conform<br>R<br>= RoHS conform | BU<br>= Bulk Ware<br>IV<br>= Individual Packing |

**Cable, Crimp**  
**TNC Reverse Polarity**

Part No.: **T55W1021**

Customer:

|       |      |      |       |        |      |       |            |
|-------|------|------|-------|--------|------|-------|------------|
| DRW:  | Dong | CHKD | Chang | MATL:  | Chui | DATE  | 11.05.2010 |
| APPD: | Ping |      |       | FINISH | Hui  | Sheet | 3 from 3   |