

# EDCON-COMPONENTS



**Contact**



## SPECIFICATION:

Working Current: 10A  
 Cable Mounting: Crimp Contact  
 Contact Resistance:  $\leq 3m\Omega$

## Technical Drawing

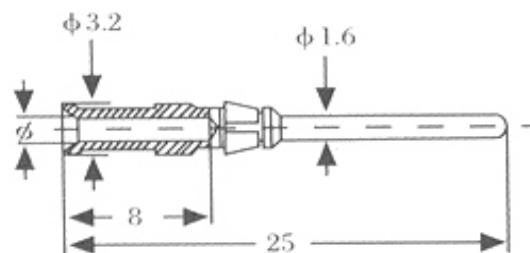

Male Contact

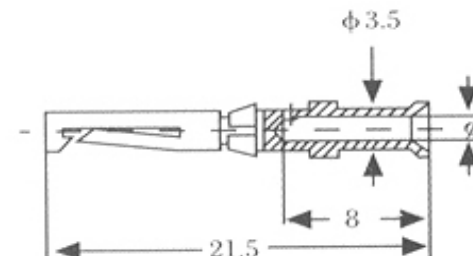

Female Contact

### Male Order Serie DD

Order Code	Ma.	Serie	Code	mm <sup>2</sup>	AWG
MDD-050	M	DD	050	0,5	20
MDD-075	M	DD	075	0,75	18
MDD-100	M	DD	100	1,0	18
MDD-150	M	DD	150	1,5	15
MDD-250	M	DD	250	2,5	14

### Female Order Serie DD

Order Code	Fem.	Serie	Code	mm <sup>2</sup>	AWG
FDD-050	F	DD	050	0,5	20
FDD-075	F	DD	075	0,75	18
FDD-100	F	DD	100	1,0	18
FDD-150	F	DD	150	1,5	15
FDD-250	F	DD	250	2,5	14

**Heavy Contact to Serie 09  
 Type HDD 10A**

Part No.: **0976001**

DRW:	Jason	CHKD	Wilson	MATL:	Wilson	TOLERANCE	Mason	DATE	01.08.2010
APPD:	Schumi			FINISH	Jamy		Sheet No.		1 from 2

Customer:

# EDCON-COMPONENTS



**Contact**



## Ordering Informations

Serie	Male / Female	Serie	Wire Size mm <sup>2</sup>	ROHS	Packing					
<b>0976001</b>	-	<b>M</b>	<b>DD</b>	<b>050</b>	<b>R</b>	<b>PB</b>				

<b>M= Male</b>	<b>DD= Heavy Serie HDD</b>	<b>050= 0,5mm<sup>2</sup></b>	<b>R= ROHS Conform</b>	<b>PB= Polybag</b>					
<b>F= Female</b>		<b>075= 0,75mm<sup>2</sup></b>	<b>N= NON ROHS Conform</b>						
		<b>100= 1,0mm<sup>2</sup></b>							
		<b>150= 1,5mm<sup>2</sup></b>							
		<b>250= 2,5mm<sup>2</sup></b>							

**Heavy Contact to Serie 09  
Type HDD 10A**

Part No.: **0976001**  
Customer:

DRW:	Jason	CHKD	Wilson	MATL:	Wilson	TOLERANCE	Mason	DATE	01.08.2010
APPD:	Schumi			FINISH	Jamy		Sheet No.		2 from 2