

EDCON-COMPONENTS



Contact



SPECIFICATION:

Working Current:	35A
Working Voltage:	400V/690V
Rated Impulse Voltage:	6KV
Isolation Resistance:	> 1010 Ohm
Temperature Range:	.-40°C to + 125°C
Flammability acc.	VO (UL94)
Cable Mounting:	Screw type

Technical Drawing

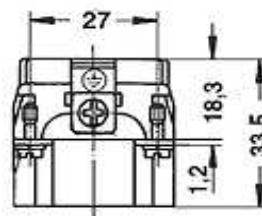

Distance to contact max. 21mm

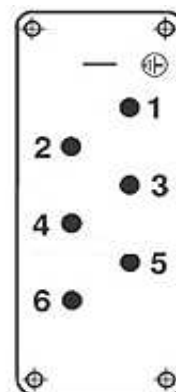
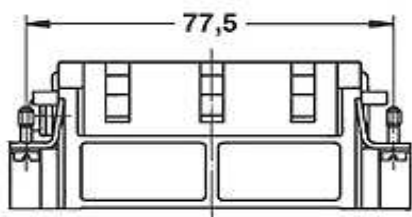

Contact arrangement view from termination side

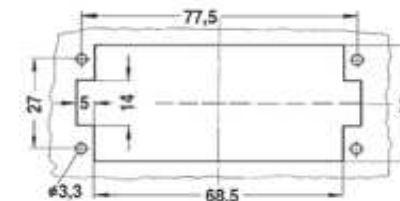

Panel cut out

**Heavy Connector Serie
HSB-006**

Part No.: **0953002**

DRW:	Jason	CHKD	Wilson	MATL:	Wilson	TOLERANCE	Mason	DATE	10.08.2010
APPD:	Schumi			FINISH	Jamy		Sheet No.	1 from 2	Customer:

www.edcon-components.com

email: info@edcon-components.com

EDCON-COMPONENTS



Contact



Ordering Informations

Serie	Pos	Connecting	ROHS	Packing						
0953002	6	M	R	CA						

6= 6Pos.	M= Male	R= ROHS Conform	CA= Carton						
		N= NON ROHS Conform							

Heavy Connector Serie HSB-006
Part No.: 0953002
Customer:

DRW:	Jason	CHKD	Wilson	MATL:	Wilson	TOLERANCE	Mason	DATE	10.08.2010
APPD:	Schumi			FINISH	Jamy			Sheet No.	2 from 2