

# EDCON-COMPONENTS



## SPECIFICATION:

Working Current: 10A  
 Working Voltage: 250V  
 Rated Impulse Voltage: 4KV  
 Isolation Resistance: > 1010 Ohm  
 Temperature Range: -40°C to + 125°C  
 Flammability acc. VO ( UL94)  
 Cable Mounting: Crimp

## Technical Drawing

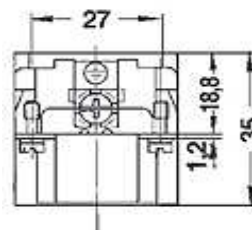

Distance to contact max. 21mm

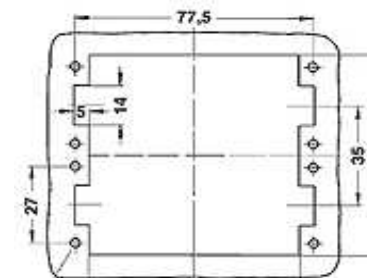
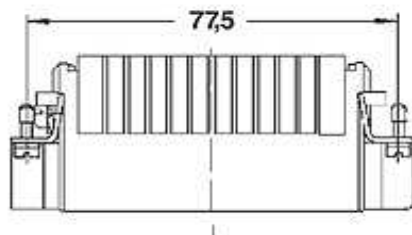

Panel cut out

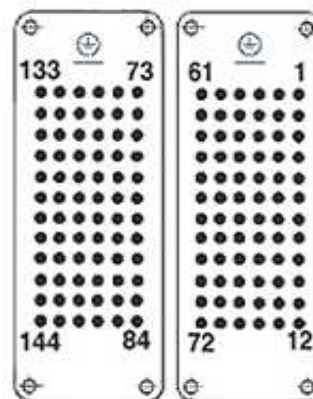

Contact arrangement view from termination side

**Heavy Connector Serie  
HDD-144**

Part No.: **0945002**

Customer:

DRW:	Jason	CHKD	Wilson	MATL:	Wilson	TOLERANCE	Mason	DATE	10.08.2010
APPD:	Schumi			FINISH	Jamy		Sheet No.	1 from 2	

# EDCON-COMPONENTS



**Contact**



## Ordering Informations

Serie	Pos	Connecting	ROHS	Packing						
<b>0945002</b>	<b>144</b>	<b>M</b>	<b>R</b>	<b>CA</b>						

144= 144Pos.	M= Male	R= ROHS Conform	CA= Carton						
		N= NON ROHS Conform							

<b>Heavy Connector Serie HDD-144</b>	
Part No.:	<b>0945002</b>
Customer:	

DRW:	Jason	CHKD	Wilson	MATL:	Wilson	TOLERANCE	Mason	DATE	10.08.2010
APPD:	Schumi			FINISH	Jamy			Sheet No.	2 from 2