

# EDCON-COMPONENTS



**Contact**



## SPECIFICATION:

Working Current: 10A  
 Working Voltage: 250V  
 Rated Impulse Voltage: 4KV  
 Isolation Resistance: > 1010 Ohm  
 Temperature Range: -40°C to + 125°C  
 Flammability acc. VO ( UL94)  
 Cable Mounting: Crimp

## Technical Drawing

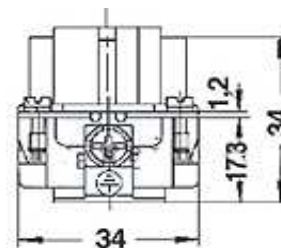

Distance to contact max. 21mm

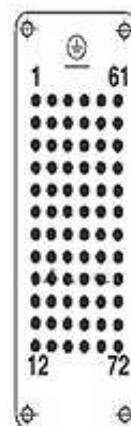
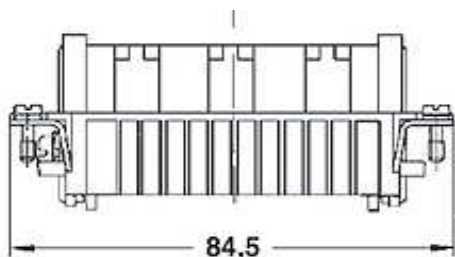

Contact arrangement view from termination side

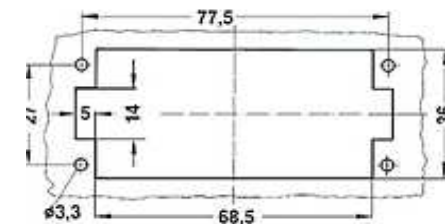

Panel cut out

**Heavy Connector Serie  
HDD-072**

Part No.: **0943001**

Customer:

DRW:	Jason	CHKD	Wilson	MATL:	Wilson	TOLERANCE	Mason	DATE	10.08.2010
APPD:	Schumi			FINISH	Jamy		Sheet No.	1 from 2	

# EDCON-COMPONENTS



**Contact**



## Ordering Informations

Serie	Pos	Connecting	ROHS	Packing						
<b>0943001</b>	<b>72</b>	<b>F</b>	<b>R</b>	<b>CA</b>						

72= 72Pos.	F= Female	R= ROHS Conform	CA= Carton						
		N= NON ROHS Conform							

<b>Heavy Connector Serie HDD-072</b>
Part No.: <b>0943001</b>
Customer:

DRW:	Jason	CHKD	Wilson	MATL:	Wilson	TOLERANCE	Mason	DATE	10.08.2010
APPD:	Schumi			FINISH	Jamy			Sheet No.	2 from 2