

# EDCON-COMPONENTS



**Contact**



## SPECIFICATION:

Working Current: 16A  
 Working Voltage: 500V  
 Rated Impulse Voltage: 6KV  
 Isolation Resistance: > 1010 Ohm  
 Temperature Range: -40°C to + 125°C  
 Flammability acc. VO ( UL94)  
 Cable Mounting: Crimp

## Technical Drawing

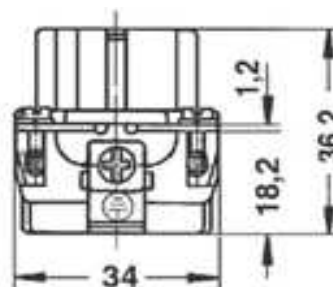

Distance to contact max. 21mm

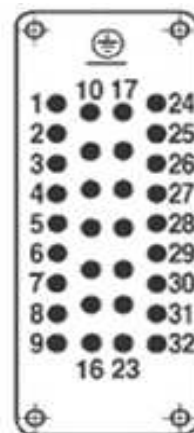
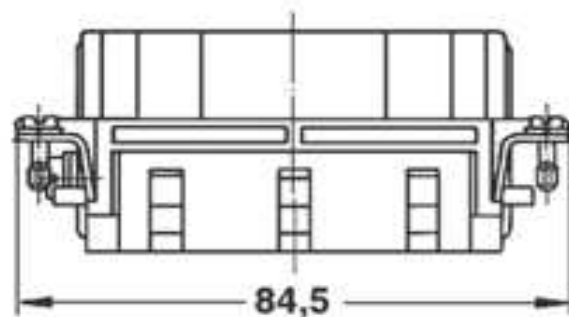

Contact arrangement view from termination side

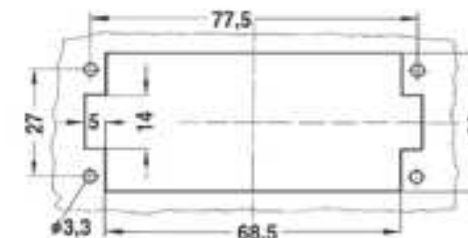

Panel cut out

<b>Heavy Connector Serie HEE-032</b>
Part No.: <b>0925001</b>
Customer:

DRW:	Jason	CHKD	Wilson	MATL:	Wilson	TOLERANCE	Mason	DATE	10.08.2010
APPD:	Schumi			FINISH	Jamy		Sheet No.	1 from 2	

[www.edcon-components.com](http://www.edcon-components.com)

email: [info@edcon-components.com](mailto:info@edcon-components.com)

# EDCON-COMPONENTS



**Contact**



## Ordering Informations

Serie	Pos	Connecting	ROHS	Packing						
<b>0925001</b>	<b>32</b>	<b>F</b>	<b>R</b>	<b>CA</b>						

<b>32= 32Pos.</b>	<b>F= Female</b>	<b>R= ROHS Conform</b>	<b>CA= Carton</b>						
		<b>N= NON ROHS Conform</b>							

<b>Heavy Connector Serie HEE-032</b>
Part No.: <b>0925001</b>
Customer:

DRW:	Jason	CHKD	Wilson	MATL:	Wilson	TOLERANCE	Mason	DATE	10.08.2010
APPD:	Schumi			FINISH	Jamy		Sheet No.		2 from 2