

# EDCON-COMPONENTS

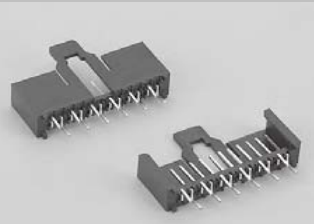

## Technical Description

Current Rating: 5,0A  
 Contact Resistance: 10mΩ max.  
 Withstanding Voltage: 1500VAC for 1 minute  
 Insulation Resistance: 1000MΩ Min  
 Operating Temperature: -40°C to + 105°C  
 Contact Material: Brass  
 Contact Plating: Matte SN over Ni  
 Insulator Material: PBT + 30% GF UL94V-0  
 Terminated with 2,5mm FLAT-ribbon Cable  
 Voltage Rating: 125VAC

## Drawing

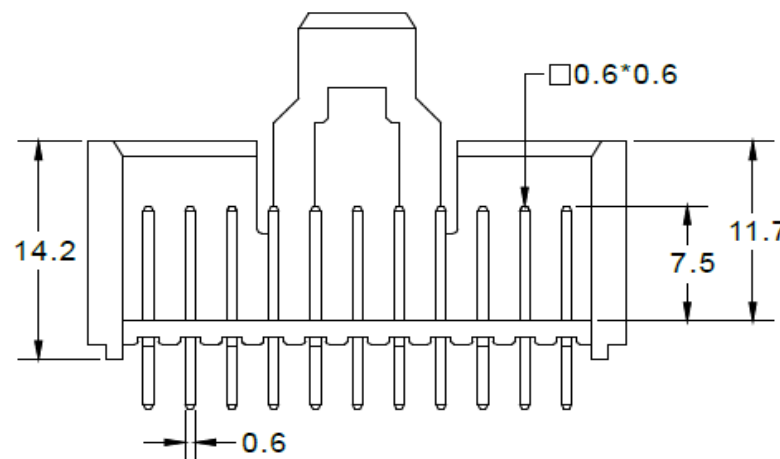
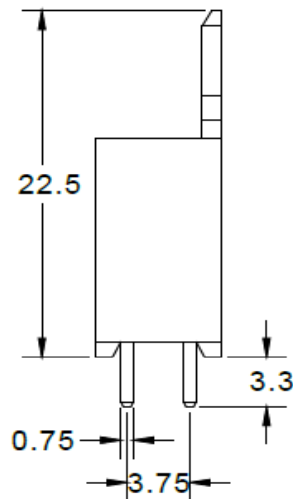

## PCB Layout

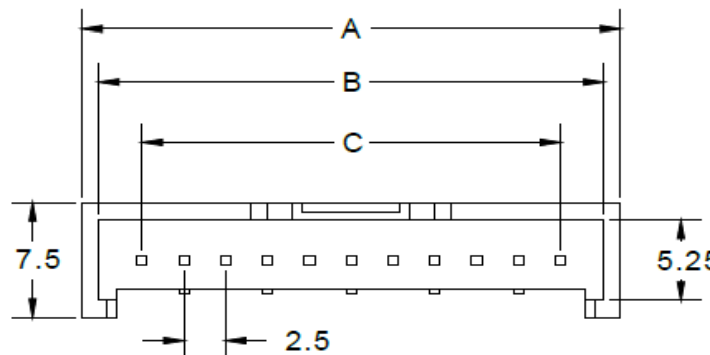
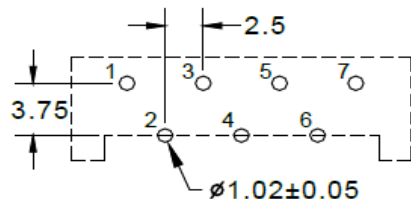
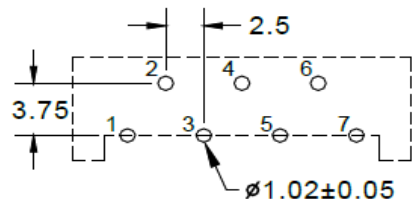

Layout TYPE A

Layout TYPE B

**IDC Wire to Board Connector  
Single Inline Row**

DRW:	Jason	CHKD	Wilson	MATL:	Tolerance				Angle
					x	x.x	x.xx	x.xxx	
APPD:	Schumi			FINISH	±	±0,40	±0,25	±0,15	± 3°
									08.05.2020
							Sheet No.		1 from 4

Part No.: **T68P174**  
 Customer:





# EDCON-COMPONENTS

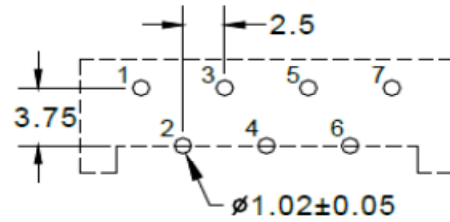
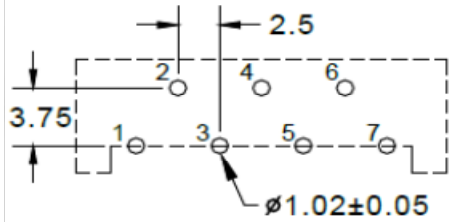

## Soldering Profile Curve

### Classification Reflow Profile (JEDEC J-STD-020C)

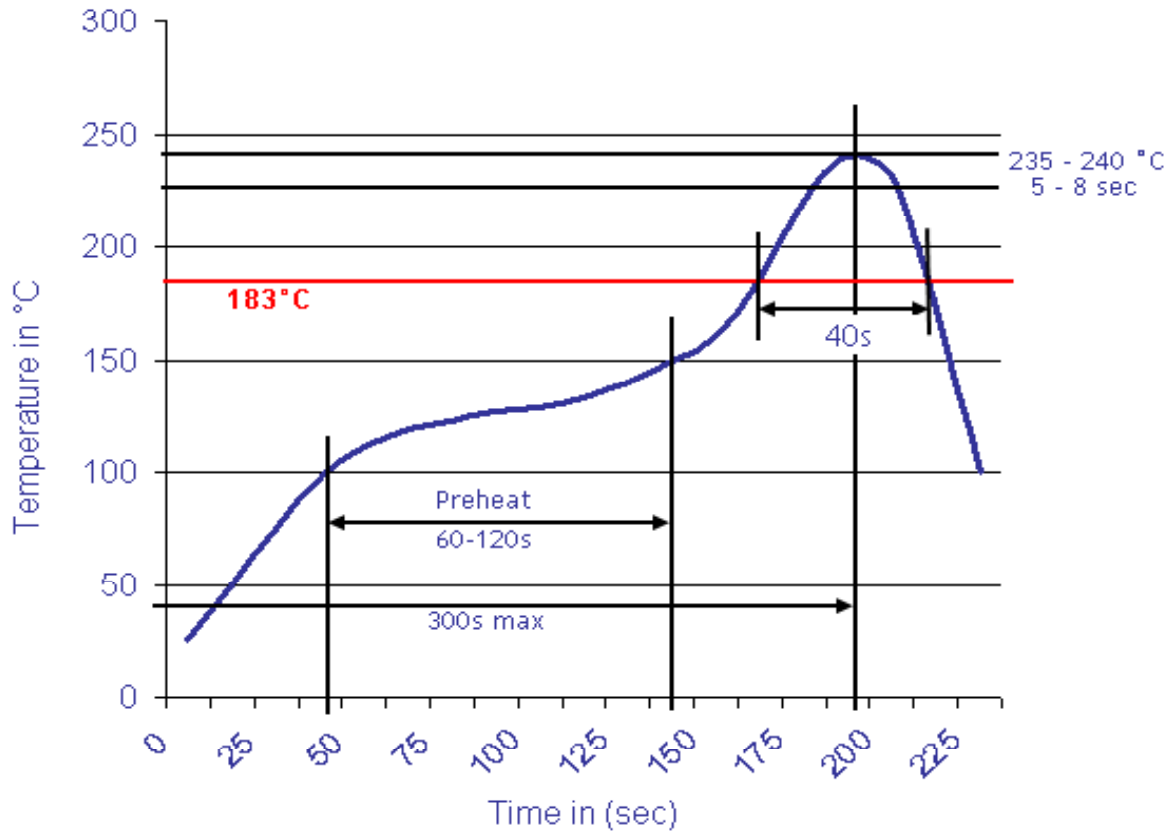

<b>IDC Wire to Board Connector Single Inline Row</b>	
Part No.:	<b>T68P174</b>
Customer:	

DRW:	Jason	CHKD	Wilson	MATL:	Wilson	TOLERANCE	Mason	DATE	08.05.2020
APPD:	Schumi			FINISH	Jamy		Sheet No.	4 from 4	