

# EDCON-COMPONENTS



## Specifications

Voltage Rating:	32V AC/DC
Current Rating:	5A AC/DC
Operating Temperature:	-.40°C ~ +115°C
Contact Resistance:	15mΩ max.
Withstanding Voltage:	1500V AC/Minute
Insulation Resistance:	100MΩ min
Applicable Wire:	like order Code
Applicable P.C.B:	
Applicable FPC/FFC:	
Solder Height:	
Crimp Tensile Strength:	
Material Housing:	Standard PBT /UL94V-0 other like Order Code
Material Contact:	Phosphor Bronze w. Tin Plated Standard other like Order Code

## Drawing ( dimensions all into mm)

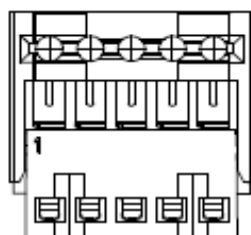
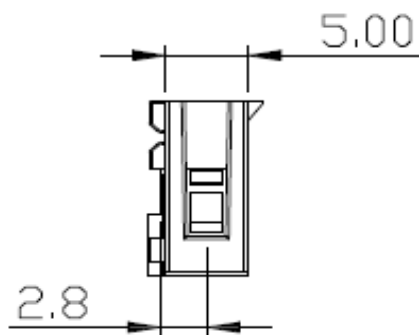
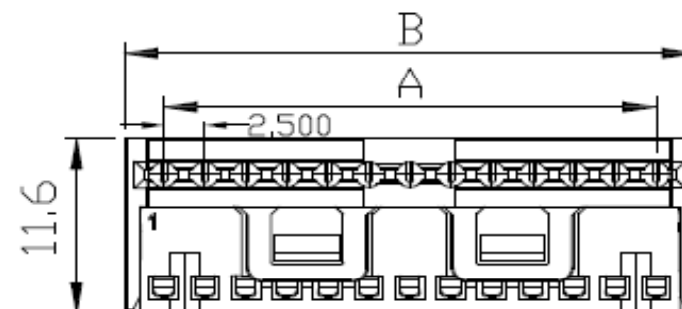
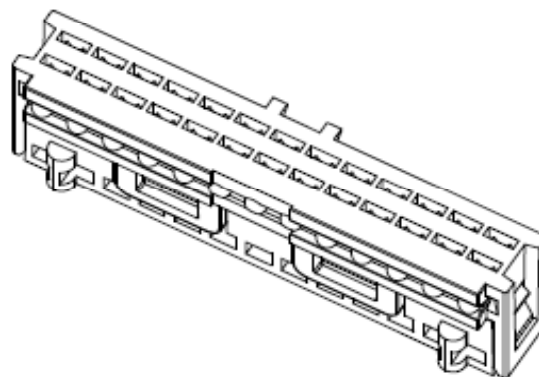

02 ~07 Pos.

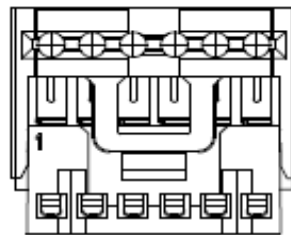

08 ~15 Pos.

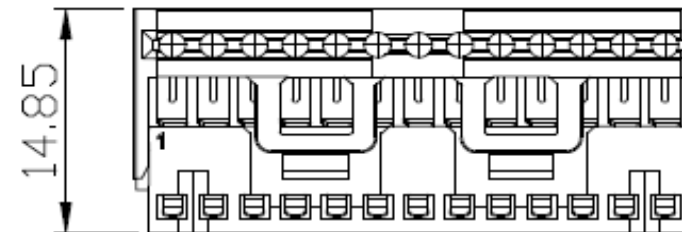

16 ~20 Pos.

**Wire to Board IDC Serie  
T68P156 Pitch 2,50mm**

					Tolerance (mm) / (°)						
					.X ±0.40	.XX ±0.25	.XXX ±0.15	ANG. ±5°		Part No.:	T68P156-
DRW:	Jason	CHKD	Wilson	MATL:	Wilson	TOLERANCE	Mason	DATE	09.02.2018	Customer:	
APPD:	Schumi			FINISH	Jamy		Sheet No.		1 from 3		



Dimension Information about Housing

Pos.	Dimension (mm)					
	A	B	C	D	E	F
2	2,50	7,30				
3	5,00	9,80				
4	7,50	12,30				
5	10,00	14,80				
6	12,50	17,30				
7	15,00	19,80				
8	17,50	22,30				
9	20,00	24,80				
10	22,50	27,30				
11	25,00	29,80				
12	27,50	32,30				
13	30,00	34,80				
14	32,50	37,30				
15	35,00	39,80				
16	37,50	42,30				
17	40,00	44,80				
18	42,50	47,30				
19	45,00	49,80				
20	47,50	52,30				

<b>Wire to Board IDC Serie T68P156 Pitch 2,50mm</b>	
Part No.:	<b>T68P156-</b>
Customer:	

DRW:	Jason	CHKD	Wilson	MATL:	Wilson	TOLERANCE	Mason	DATE	09.02.2018
APPD:	Schumi			FINISH	Jamy			Sheet No.	2 from 3

# EDCON-COMPONENTS

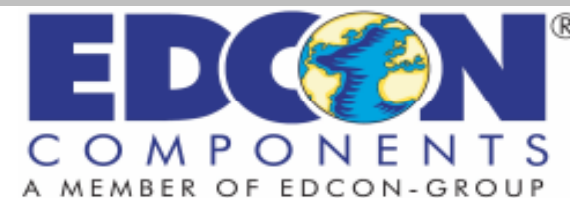

## Ordering Informations

Serie	Number of Pos.	Contact Plating	Colour of Body	Material of Body	Wire Range Contact	Special function	Special function	ROHS Conform	Packing
<b>T68P156-</b>	<b>02</b>	<b>TN</b>	<b>GY</b>	<b>PB</b>	<b>22</b>	<b>N</b>	<b>N</b>	<b>R</b>	<b>BU</b>

<b>xx = Pos.</b>	<b>TN = Tin Plated</b>	<b>GY = Gray Colour</b>	<b>PB = PBT</b>	<b>22 = AWG22</b>	<b>N = No function</b>	<b>N = No function</b>	<b>R= ROHS Conform</b>	<b>BU= Bulk Packing</b>
<b>2 to 20Pos.</b>	<b>GF = Gold Flash Plated</b>		<b>PA = PA46</b>	<b>24 = AWG24</b>			<b>N= NON ROHS Conform</b>	<b>TY= Tray Packing</b>
			<b>P6 = PA6T</b>	<b>26 = AWG26</b>				<b>TU= Tube Packing</b>
			<b>P9 = PA9T</b>	<b>28 = AWG28</b>				<b>TR= Tap Reel Pack.</b>
			<b>LC = LCP</b>					<b>IV= Individual Packing</b>

**Wire to Board IDC Serie  
T68P156 Pitch 2,50mm**

Part No.: **T68P156-**

DRW:	Jason	CHKD	Wilson	MATL:	Wilson	TOLERANCE	Mason	DATE	09.02.2018
APPD:	Schumi			FINISH	Jamy		Sheet No.		3 from 3

Customer: