

EDCON-COMPONENTS



Specifications

Voltage Rating: 30 VAC
 Current Rating: 1,0A
 Operating Temperature: -55°C to + 85°C
 Contact Resistance: 50m Ohm max.
 Withstanding Voltage: 100VAC min.
 Insulation Resistance: >100M Ohm min.
 Contact Thickness: 0,25mm

Material:

Insulator : look order code
 Color: look order code
 Contact Material: look order code
 Contact Type: Stamped
 Contact Plating: look order code
 Shielding: look order code
 Lifetime: 5000 cycles min.
 Force: 35N Max.

Drawing (dimensions all into mm)

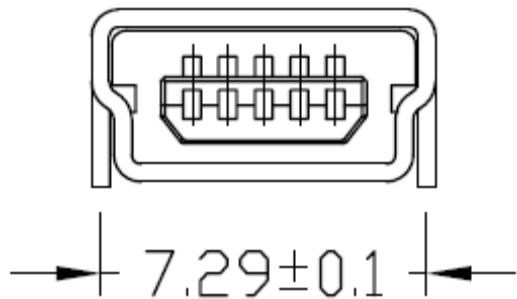
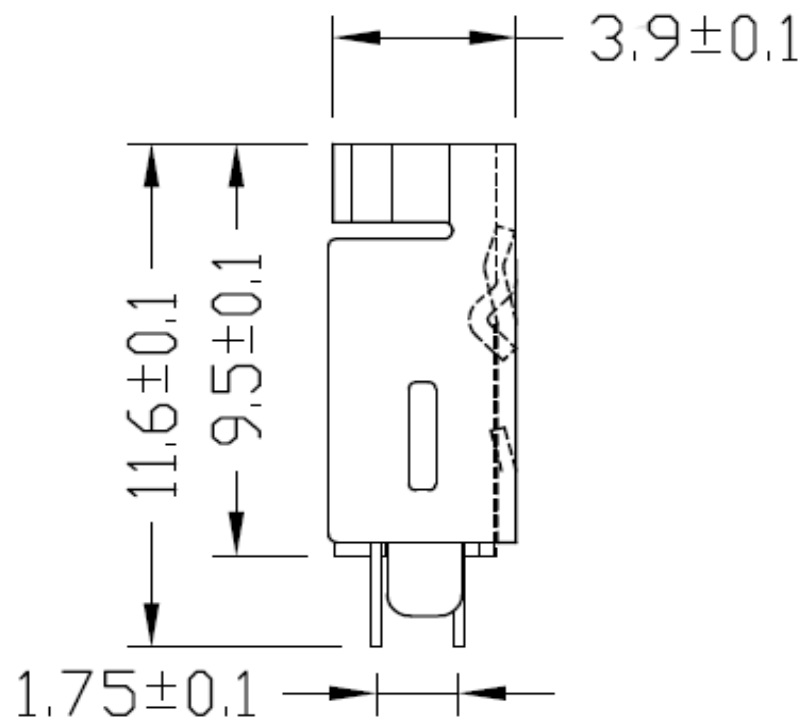

**THT Mini USB Connector 5P
 Female Type Short Body
 Straight**

Part No.: **T64100**

| | | | | | | | | | |
|-------|--------|------|--------|--------|--------|-----------|-----------|----------|------------|
| DRW: | Jason | CHKD | Wilson | MATL: | Wilson | TOLERANCE | Mason | DATE | 24.08.2015 |
| APPD: | Schumi | | | FINISH | Jamy | | Sheet No. | 1 from 4 | |

Customer:

EDCON-COMPONENTS



PCB Layout

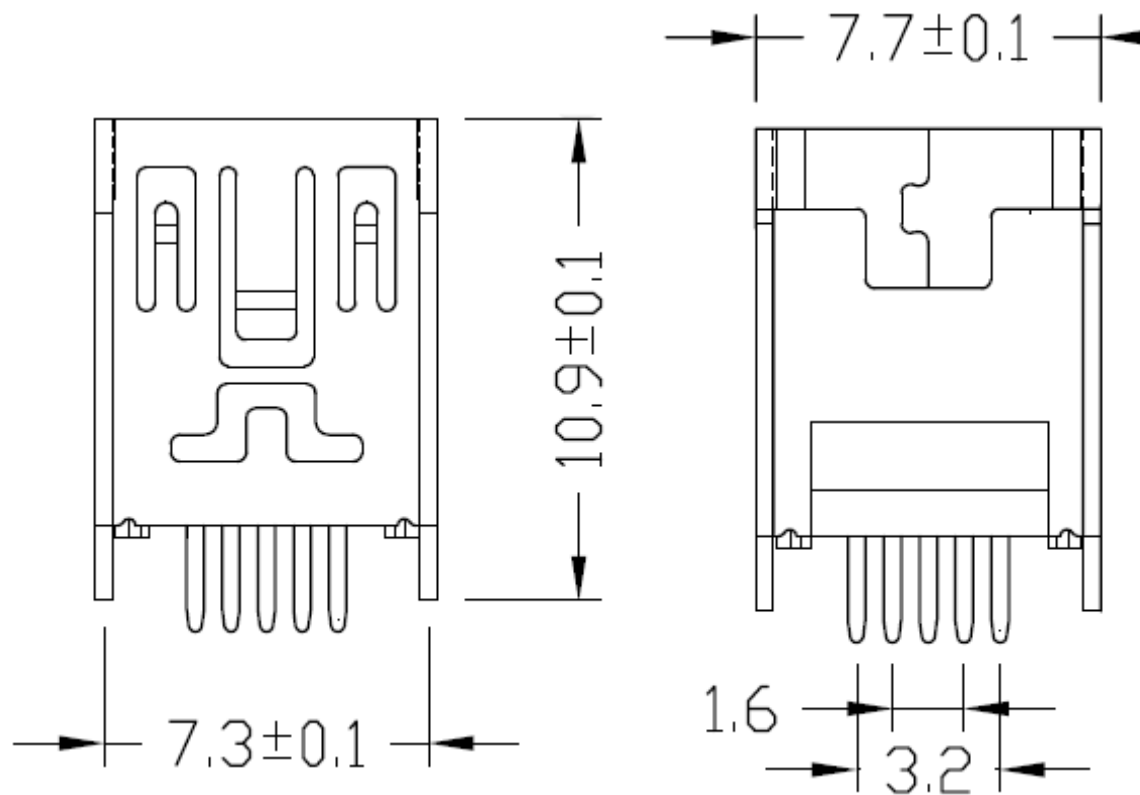
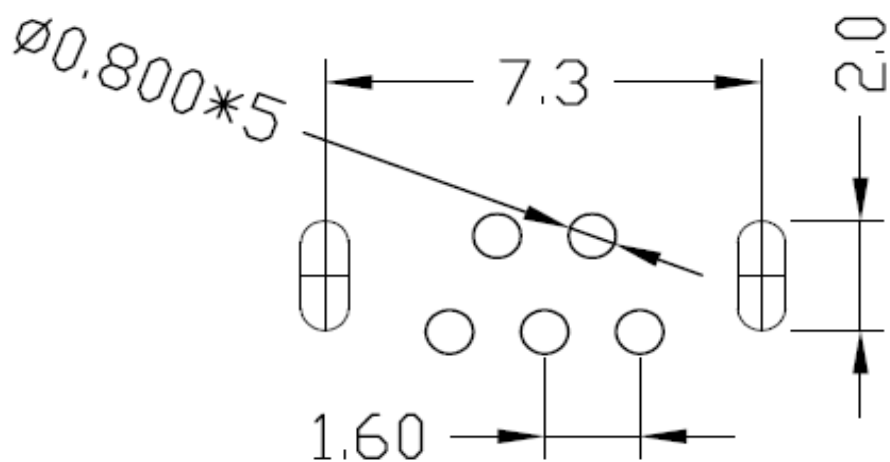

| | |
|--|---------------|
| THT Mini USB Connector 5P Female Type Short Body Straight | |
| Part No.: | T64100 |
| Customer: | |

| | | | | | | | | | |
|-------|--------|------|--------|--------|--------|-----------|-----------|----------|------------|
| DRW: | Jason | CHKD | Wilson | MATL: | Wilson | TOLERANCE | Mason | DATE | 24.08.2015 |
| APPD: | Schumi | | | FINISH | Jamy | | Sheet No. | 2 from 4 | |

EDCON-COMPONENTS



Ordering Informations

| Serie | Color Inside | Shell Material | Insulator Material | Contact Material | Contact Plating | Special function | Packing | Packing | | |
|---------------|--------------|----------------|--------------------|------------------|-----------------|------------------|----------|-----------|--|--|
| T64100 | BK | B | P | B | G0 | 0 | R | BU | | |

| | | | | | | | |
|-------------------------|----------------------------|-------------------------|----------------------------|-----------------------------------|--------------------------------|-----------------------------|---|
| BK = Black Color | B = Brass | P = PBT + 30% GF | B = Brass | G0 = Gold Flash (Standard) | 0 = No Special function | R = ROHS conform | BU = Bulk Ware |
| WH = White Color | I = Iron | L = LCP | P = Phosphor Copper | G1 = 3μ Gold | | N = NON ROHS conform | TY = Tray Packing |
| | S = Stainless Steel | | | G1 = 5μ Gold | | | TR = Tape / Reel w. Pic and Place Foil |
| | | | | G1 = 10μ Gold | | | IV = Individual Packing |
| | | | | G1 = 15μ Gold | | | |
| | | | | G1 = 30μ Gold | | | |
| | | | | | | | |

PIC and PLACE FOIL for automatic assembly machine



**THT Mini USB Connector 5P
Female Type Short Body
Straight**

Part No.: **T64100**

| | | | | | | | | | |
|-------|--------|------|--------|--------|--------|-----------|-----------|------|------------|
| DRW: | Jason | CHKD | Wilson | MATL: | Wilson | TOLERANCE | Mason | DATE | 24.08.2015 |
| APPD: | Schumi | | | FINISH | Jamy | | Sheet No. | | 3 from 4 |

Customer:



Soldering Profile Curve

Classification Reflow Profile (JEDEC J-STD-020C)

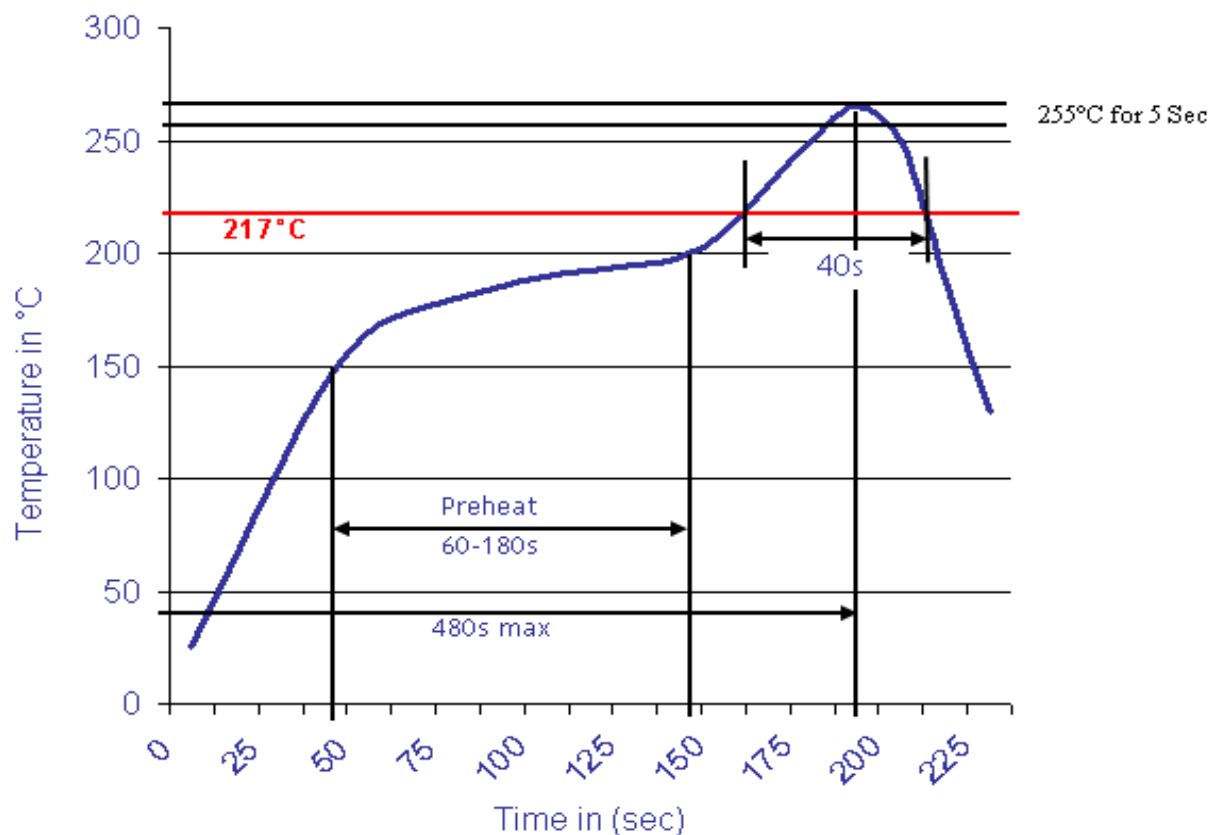

**TH1 Mini USB Connector
5P Female Type Short
Body Straight**

Part No.: **T64100**

| | | | | | | | | | |
|-------|--------|------|--------|--------|--------|-----------|-----------|----------|------------|
| DRW: | Jason | CHKD | Wilson | MATL: | Wilson | TOLERANCE | Mason | DATE | 24.08.2015 |
| APPD: | Schumi | | | FINISH | Jamy | | Sheet No. | 4 from 4 | Customer: |