

# EDCON-COMPONENTS

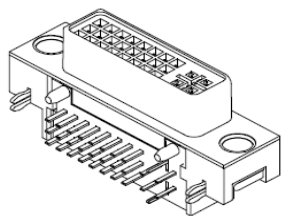

## Technical Discription

Temperature Range:	-20°C ~ +85°C
Rated Load	DC40V 1,5A
Contact Resistance:	≤ 0,03 Ω
Insulation Resistance:	≥ 1000M Ω
Withstanding Voltage:	AC 500V / 50Hz) 1 min.
Insertion and Extraction Force:	5 ~ 30N
Lifetime:	1000 cycles
Contact Material:	Brass or Bronze
Housing:	Thermoplastic UL-9\$V-0
Shell:	SPCC Zinc Alloy Nickel Plating all Area
Contact:	Gold over Nickel

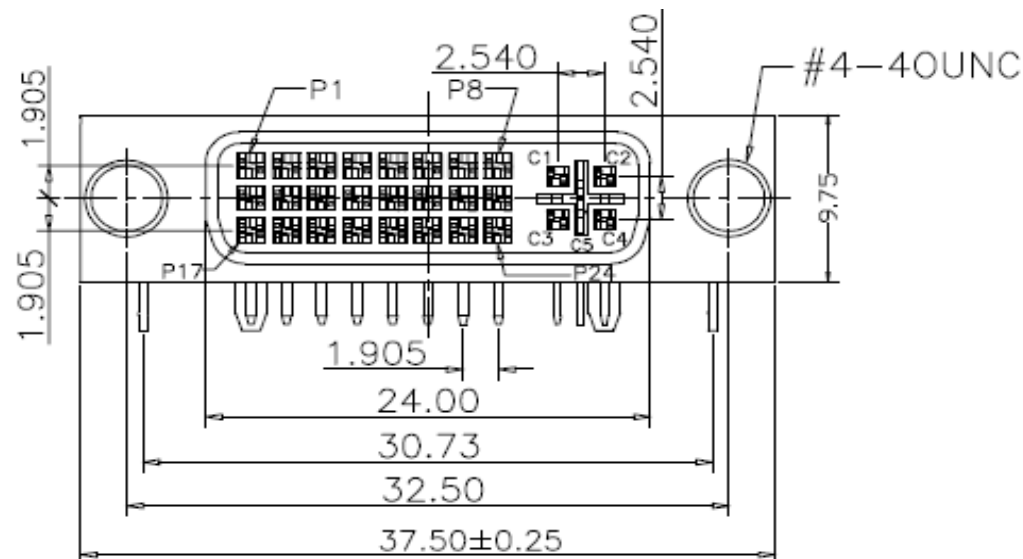

## PCB Layout

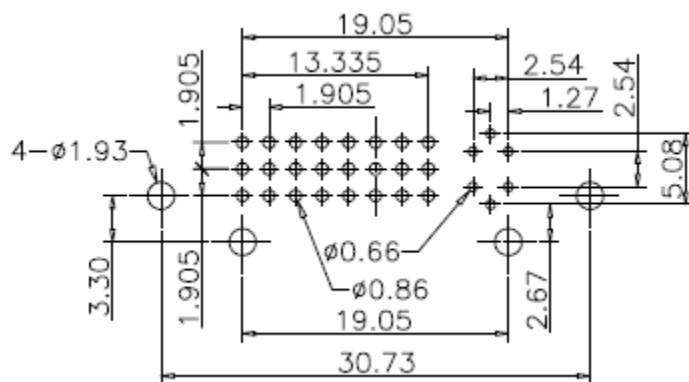

**DVI-Connector Right angle**

Part No.: **T26010-**

Customer:

DRW:	Jason	CHKD	Wilson	MATL:	Wilson	TOLERANCE	Mason	DATE	10.10.2014
APPD:	Schumi			FINISH	Jamy		Sheet No.		1 from 4

# EDCON-COMPONENTS

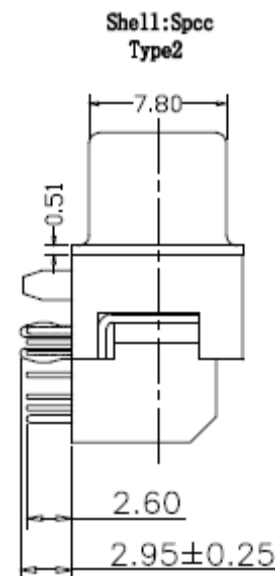
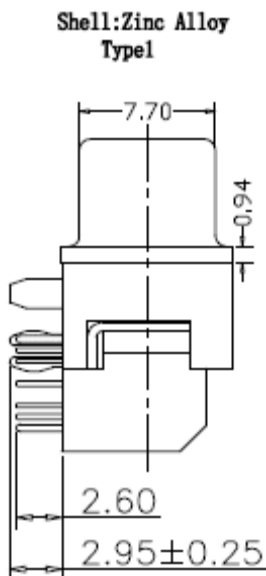
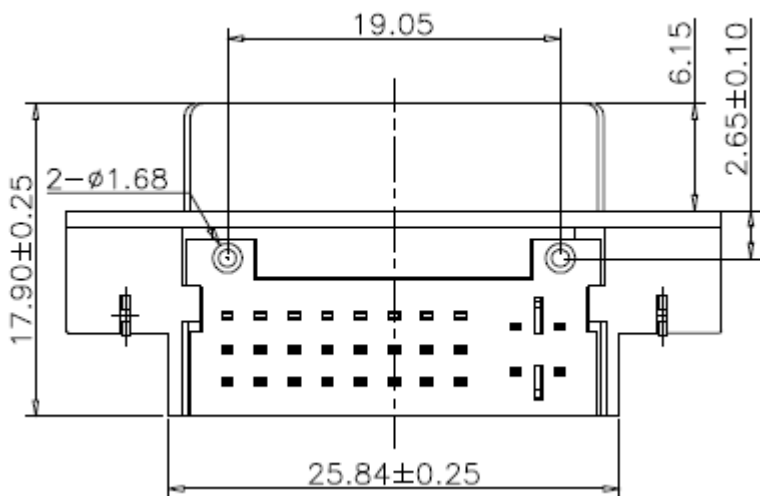
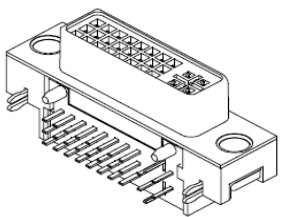

## Mounting Options

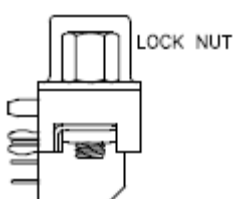

Type A

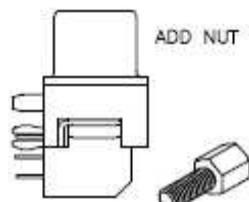

Type B

**DVI-Connector Right angle**

Part No.: **T26010-**

Customer:

DRW:	Jason	CHKD	Wilson	MATL:	Wilson	TOLERANCE	Mason	DATE	10.10.2014
APPD:	Schumi			FINISH	Jamy		Sheet No.		2 from 4

[www.edcon-components.com](http://www.edcon-components.com)

email: [info@edcon-components.com](mailto:info@edcon-components.com)

# EDCON-COMPONENTS

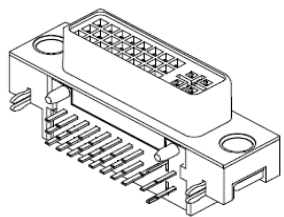

## Ordering Informations

Serie	Pos.	Contact Plating	Color Inside Plastic	Mounting Options	Nut Options	Shell	ROHS	Packing		
<b>T26010-</b>	<b>29</b>	<b>G0</b>	<b>WH</b>	<b>A</b>	<b>1</b>	<b>1</b>	<b>R</b>	<b>TY</b>		

<b>29=</b> 24+5Pos.	<b>G0</b> = Gold flash plat.	<b>WH</b> = White	<b>A</b> = Fixed mounting	<b>1</b> = 4,8x11,8mm	1= Shell Type 1	<b>R=</b> ROHS Conform	<b>TY=</b> Tray Package
	<b>G1</b> = 3µ Gold plat.			<b>BK</b> = Black			
	<b>G2</b> = 5µ Gold plat.	<b>RD</b> = Red		<b>3</b> = 4,8x13,0mm			
	<b>G3</b> = 10µ Gold plat.			<b>4</b> = 5,8x13,0mm			
	<b>G4</b> = 15µ Gold plat.			<b>5</b> = 5,0x13,0mm			
	<b>G5</b> = 30µ Gold plat.						

**DVI-Connector Right angle**

Part No.: **T26010-**

DRW:	Jason	CHKD	Wilson	MATL:	Wilson	TOLERANCE	Mason	DATE	10.10.2014	Customer:
APPD:	Schumi			FINISH	Jamy		Sheet No.	3 from 4		

[www.edcon-components.com](http://www.edcon-components.com)

email: [info@edcon-components.com](mailto:info@edcon-components.com)

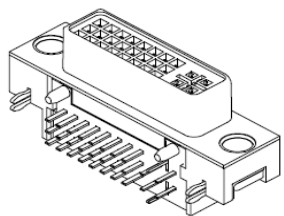

**Lead Free Soldering Curve**

**Classification Reflow Profile (JEDEC J-STD-020C)**

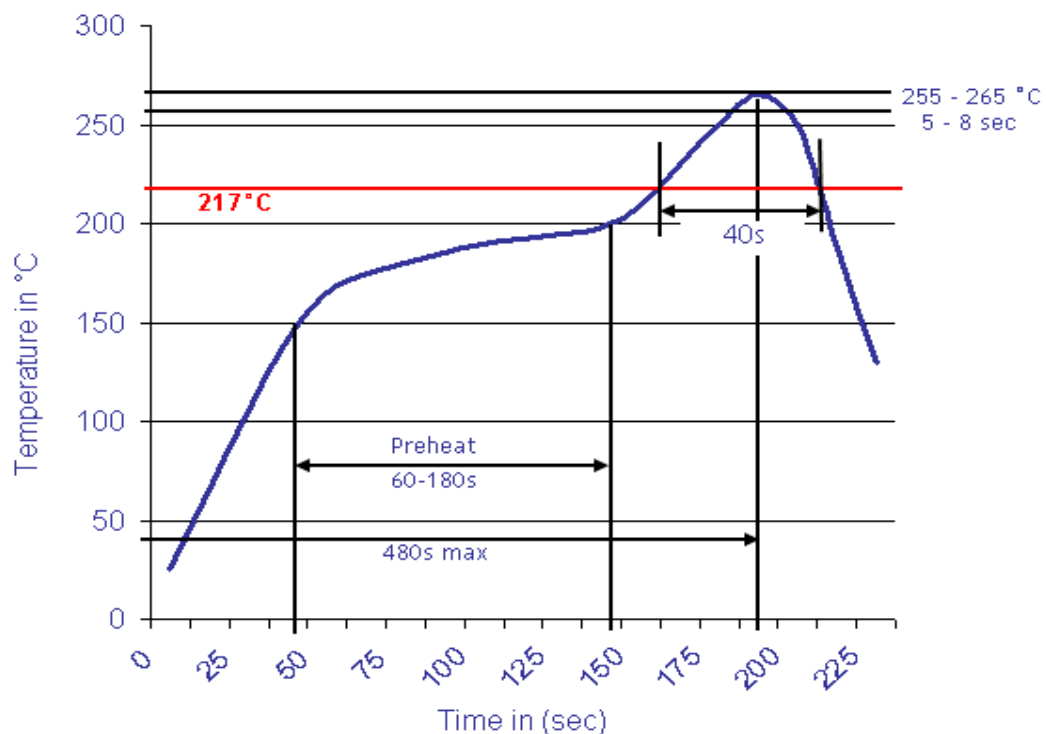

**DVI-Connector Right angle**

Part No.: **T26010-**

Customer:

DRW:	Jason	CHKD	Wilson	MATL:	Wilson	TOLERANCE	Mason	DATE	10.10.2014
APPD:	Schumi			FINISH	Jamy		Sheet No.	4 from 4	