

Data Sheet

Elevated Terminal Block Pitch 2,54mm

Pitch: 2,54 mm

Serie: A13F002

Customer Information for special Item

EDCON Customer : 0

Customer Version No. : 0

EDCON-COMPONENTS



Technical Discription

Electrical	UL	IEC
Rated Voltage	150 Volt	130V
Rated Current	6A	8A
Wire Range		
Solid Wire	26-16AWG	1,0mm ²
Stranged Wire		
Withstanding Voltage		1,25KV
Mechanical		
Operating Temperature	. -40°C ~ +105°C	
Wire Strip Length	4,5mm	
Dimensions		
Pitch (mm)	2,54	
Poles	2 + 3Pos. ~ 24 Pos.	
Materials		
Terminal Housing	PA66, UL94V-0	
Screw:	M1,6,cr ³ + Zn plated	
Pin Header	Brass tin-plated	
Wire Guard:	Stainless Steel	

Drawing (Dimension in mm)

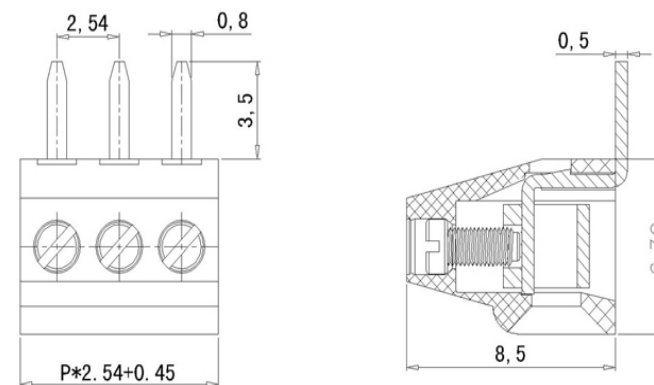

**Elevated Terminal Block
Pitch 2,54mm**

Part No.: **A13F002**

Customer:

DRW:	Jason	CHKD	Wilson	MATL:	Wilson	TOLERANCE	Mason	DATE	03.08.2016
APPD:	Schumi			FINISH	Jamy		Sheet No.		1 from 4

EDCON-COMPONENTS



Dimensions (mm)

No. of Pos.	A	Tol. A	B	Tol. B
02	5,08	± 0,15	2,54	± 0,15
03	7,62	± 0,15	5,08	± 0,15
04	10,16	± 0,15	7,62	± 0,15
05	12,70	± 0,15	10,16	± 0,15
06	15,24	± 0,15	12,70	± 0,15
07	17,78	± 0,25	15,24	± 0,25
08	20,32	± 0,25	17,78	± 0,25
09	22,86	± 0,25	20,32	± 0,25
10	25,40	± 0,25	22,86	± 0,25
11	27,94	± 0,25	25,40	± 0,25
12	30,48	± 0,25	27,94	± 0,25
13	33,02	± 0,35	30,48	± 0,35
14	35,56	± 0,35	33,02	± 0,35
15	38,10	± 0,35	35,56	± 0,35
16	40,64	± 0,35	38,10	± 0,35
17	43,18	± 0,35	40,64	± 0,35
18	45,72	± 0,35	43,18	± 0,35
19	48,26	± 0,35	45,72	± 0,35
20	50,80	± 0,40	48,26	± 0,40
21	53,34	± 0,40	50,80	± 0,40
22	55,88	± 0,40	53,34	± 0,40
23	58,42	± 0,40	55,88	± 0,40
24	60,96	± 0,40	58,42	± 0,40

**Elevated Terminal Block
Pitch 2,54mm**

Part No.: **A13F002**

Customer:

DRW:	Jason	CHKD	Wilson	MATL:	Wilson	TOLERANCE	Mason	DATE	03.08.2016
APPD:	Schumi			FINISH	Jamy		Sheet No.		2 from 4



EDCON-COMPONENTS



Ordering Informations

Serie	No. of Pos.	Body Color	No Function	Approval Code	ROHS	Packing	EDCON Cust. No.	Customer Version		
-------	-------------	------------	-------------	---------------	------	---------	-----------------	------------------	--	--

A13F002	02	PG	A	N	R	B				
----------------	-----------	-----------	----------	----------	----------	----------	--	--	--	--

Pitch 2,54	02 = Number of Pos. 2 ~ 20Pos.	PG = Phoenix Green (Standard) WH = White GN = Green GY = Gray LG = Light Gray OR = Orange BL = Blue BK = Black	A = Slotted Screw Type (Standard)  B = Cross Slotted Screw Type 	0 = NON Plastic Approval 1 = UL for Plastic Approval A = UL /UR Approval Please consult EDCON for available B = VDE Approval Please consult EDCON for available C = TÜV Approval Please consult EDCON for available	R = ROHS Conform N = NON ROHS Conform	B = Bulk-Ware I = Individual Package	xxxxxx = Customer Number	xxx = Customer Version ??(Printing)		
---------------	--	---	---	--	--	---	---------------------------------	--	--	--

**Elevated Terminal Block
Pitch 2,54mm**

Part No.: **A13F002**

DRW:	Jason	CHKD	Wilson	MATL:	Wilson	TOLERANCE	Mason	DATE	03.08.2016
APPD:	Schumi			FINISH	Jamy		Sheet No.		3 from 4

Customer:



Soldering Profile Curve

Classification Reflow Profile (JEDEC J-STD-020C)



**Elevated Terminal Block
Pitch 2,54mm**

Part No.: **A13F002**

DRW:	Jason	CHKD	Wilson	MATL:	Wilson	TOLERANCE	Mason	DATE	03.08.2016
APPD:	Schumi			FINISH	Jamy		Sheet No.	4 from 4	Customer: